

# CORNER RECORD

Document Number 01-10  
County of San Joaquin, California

City of \_\_\_\_\_

Brief Legal Description ON ELLIOTT ROAD 2500± SOUTH OF PELTIER ROAD

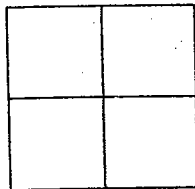

### CORNER TYPE

Government Corner  Control   
Meander  Property   
Rancho  Other   
Date of Survey NOVEMBER 2000

### COORDINATES (Optional)

N. \_\_\_\_\_  
E. \_\_\_\_\_  
Zone                      NAD27  NAD83   
NAD83 Epoch \_\_\_\_\_  
Elev. \_\_\_\_\_  
Vert. Datum: NGVD29  NAVD88   
Meas. Units: Metric  Imperial

Corner - Left as found  Found and tagged  Established  Reestablished  Rebuilt

Identification and type of corner found: Evidence used to identify or procedure used to establish or reestablish the corner  
SEE SKETCH ON BACKSIDE

A description of the physical condition of the monument as found and as set or reset:  
FOUND MONUMENT IN GOOD CONDITION. SEE SKETCH ON BACKSIDE

### SURVEYOR'S STATEMENT

This Corner Record was prepared by me or under my direction in conformance with the Land Surveyors' Act on Jan 9, 2001.

Signed [Signature] L.S. or R.C.E. Number 23341

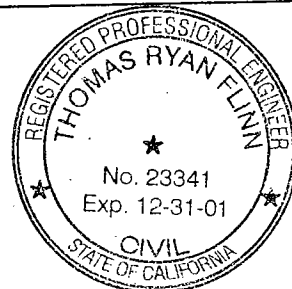

### COUNTY SURVEYOR'S STATEMENT

This Corner Record was received 1-9, 2001 and examined and filed Jan 13, 2001.

Signed [Signature] R.C.E. No. 28054  
Title County Surveyor

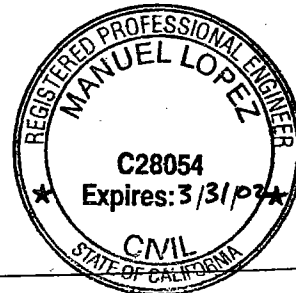

County Surveyors Comment \_\_\_\_\_

(D.D. Sheet No. 10)

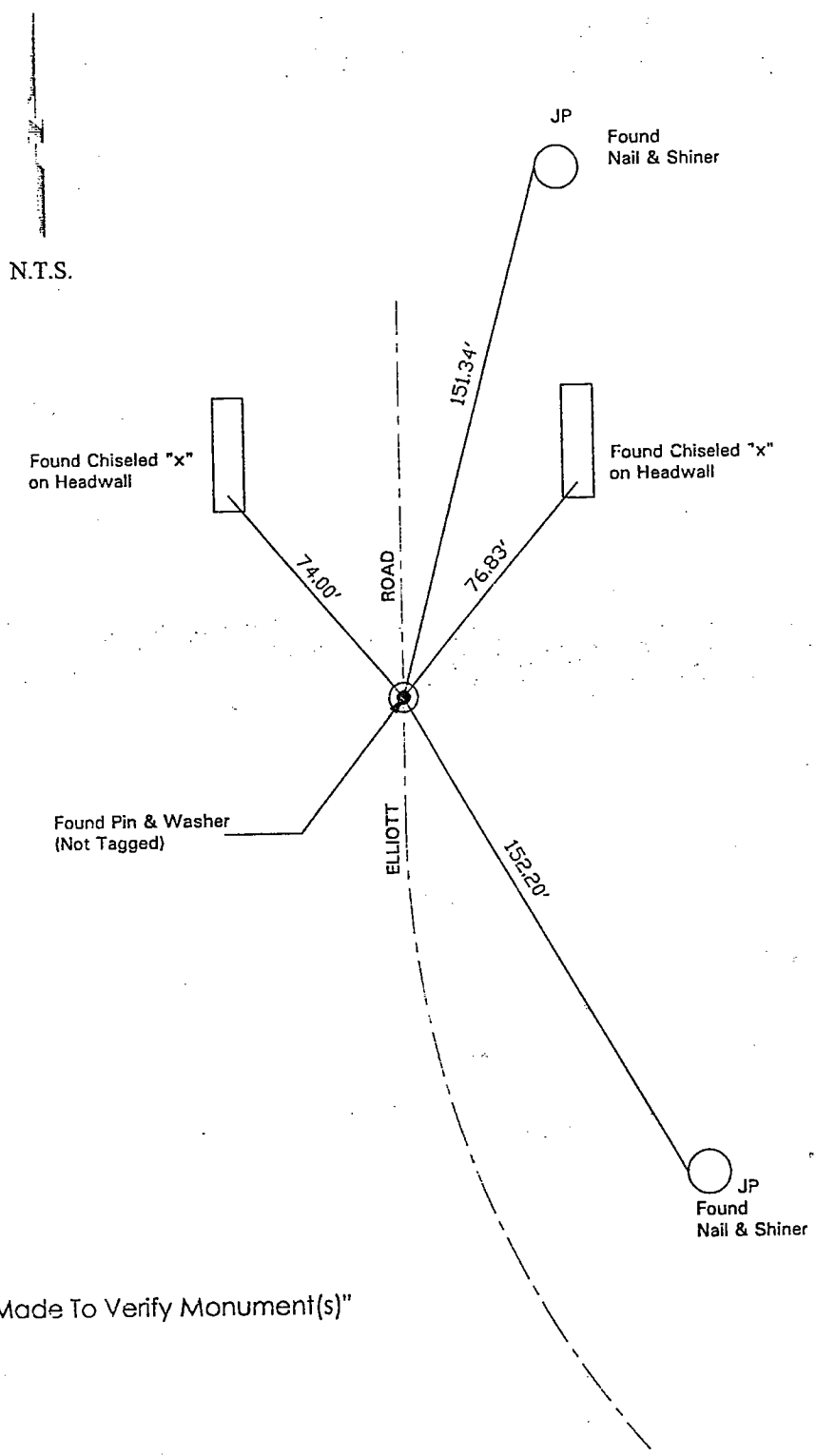

"No Attempt Was Made To Verify Monument(s)"

- FP=Fence Post
- GP=Guy Post
- JP=Joint Pole
- PP=Power Pole
- SP=Service Pole
- TP=Telephone Pole
- N.T.S.=Not To Scale
- Set=Conc. Nails with Brass Washers Stamped "S.J. Co.", unless otherwise noted