

CORNER RECORD

Document Number 00-274
 City of _____ County of San Joaquin, California

Brief Legal Description NE CORNER OF SE QUARTER OF SECTION 18, T.2S.,R.8E.

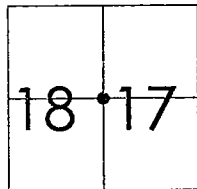

T.2S.,R.8E

CORNER TYPE

Government Corner ☒ Control ☐
 Meander ☐ Property ☐
 Rancho ☐ Other ☐

Date of Survey AUGUST 10, 2000

COORDINATES (Optional)

N. _____
 E. _____
 Zone _____ NAD27 ☐ NAD83 ☐
 NAD83 Epoch _____
 Elev. _____
 Vert. Datum: NGVD29 ☐ NAVD88 ☐
 Meas. Units: Metric ☐ Imperial ☒

Corner - Left as found ☒ Found and tagged ☐ Established ☐ Reestablished ☐ Rebuilt ☒

Identification and type of corner found: Evidence used to identify or procedure used to establish or reestablish the corner
FOUND BOLT (NOT TAGGED). CONFIRMED LOCATION PER SWINGS ON CR-00-274 SEE SKETCH ON BACKSIDE.

A description of the physical condition of the monument as found and as set or reset:
FOUND MONUMENT IN GOOD CONDITION. SEE SKETCH ON BACKSIDE.

SURVEYOR'S STATEMENT

This Corner Record was prepared by me or under my direction in conformance with
 the Land Surveyors' Act on Sep 5, 2000.

Signed [Signature] L.S. or R.C.E. Number 23341

COUNTY SURVEYOR'S STATEMENT

This Corner Record was received SEP 6, 2000 and examined
 and filed SEP 12, 2000.

Signed Thomas M. Gau R.C.E. No. 28054

PER Title _____ County Surveyor

County Surveyors Comment _____

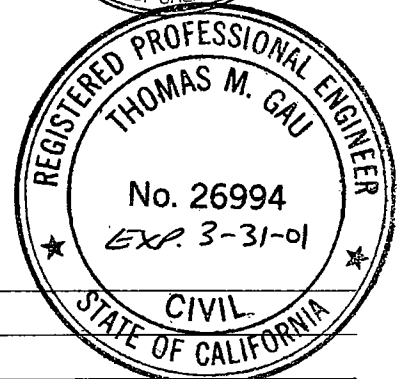

(D.D. Sheet No. 60)



N.T.S.

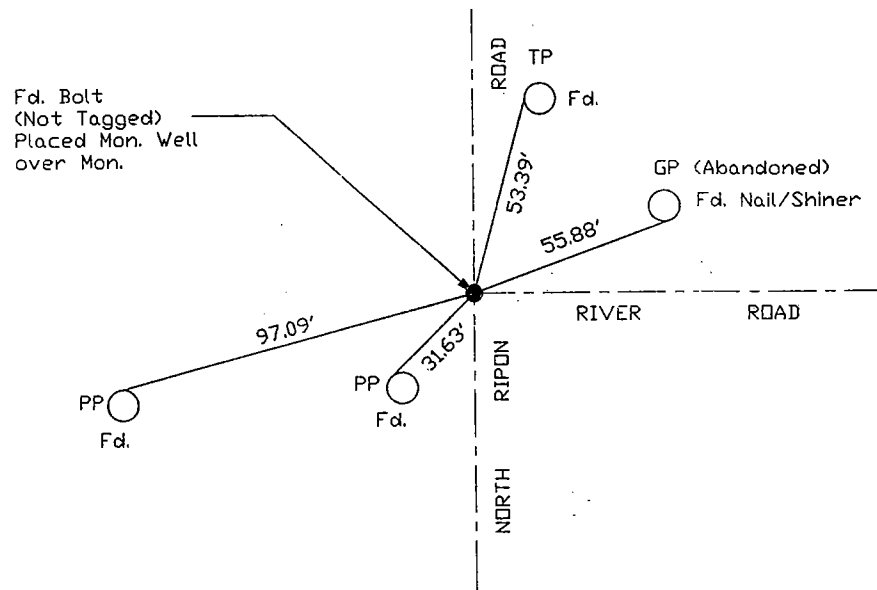

"No Attempt Was Made To Verify Monument(s)"

FP=Fence Post

GP=Guy Post

JP=Joint Pole

PP=Power Pole

SP=Service Pole

TP=Telephone Pole

N.T.S.=Not To Scale

Fd.=Conc. Nails with Brass Washers Stamped "S.J. Co.", unless otherwise noted