

CORNER RECORD

Document Number 00-269
 County of San Joaquin, California

City of _____

Brief Legal Description SE CORNER OF NE QUARTER OF SECTION 3, T.3N., R.8E.

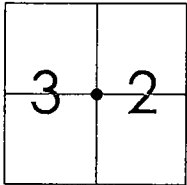

T.3N., R.8E

CORNER TYPE

- Government Corner Control
 Meander Property
 Rancho Other

Date of Survey JULY 18, 2000

COORDINATES (Optional)

N. _____
 E. _____
 Zone _____ NAD27 NAD83
 NAD83 Epoch _____
 Elev. _____
 Vert. Datum: NGVD29 NAVD88
 Meas. Units: Metric Imperial

Corner - Left as found Found and tagged Established Reestablished Rebuilt

Identification and type of corner found: Evidence used to identify or procedure used to establish or reestablish the corner
REESTABLISHED LOCATION OF FD. PIN & WASHER PER SWINGS ON CR-00-64. SEE SKETCH ON BACKSIDE

A description of the physical condition of the monument as found and as set or reset: _____

SET 3/4" x 30" IRON PIN AND PLACED MON. WELL OVER MON. SEE SKETCH ON BACKSIDE

SURVEYOR'S STATEMENT

This Corner Record was prepared by me or under my direction in conformance with the Land Surveyors' Act on Sep. 1, 2000.

Signed _____ L.S. or R.C.E. Number 23341

COUNTY SURVEYOR'S STATEMENT

This Corner Record was received SEP. 6, 2000 and examined and filed SEPT. 12, 2000.

Signed Thomas M. Gau R.C.E. No. 28054

FOR Title _____ County Surveyor

County Surveyors Comment _____

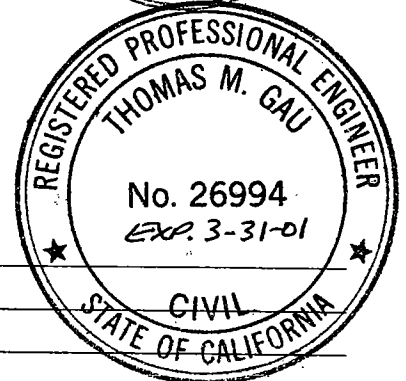
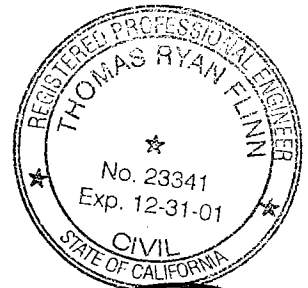

(D.D. Sheet No. 18 & 19)

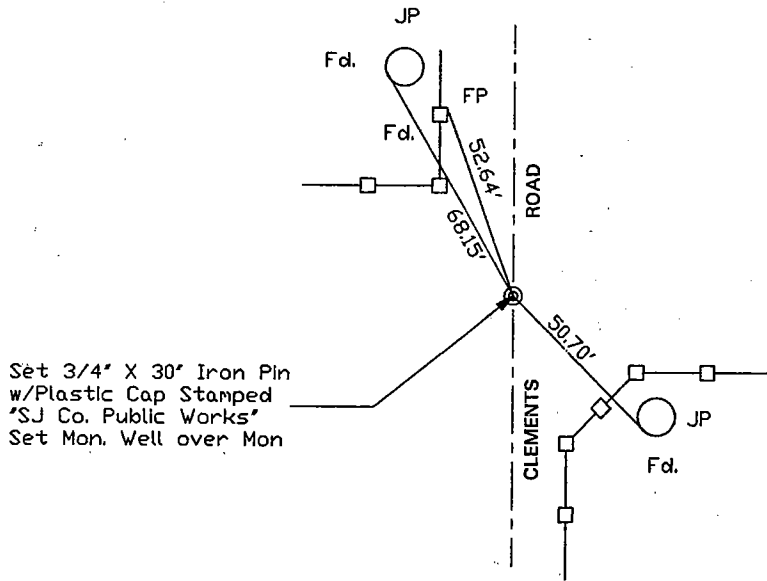

"No Attempt Was Made To Verify Monument(s)"

FP=Fence Post

GP=Guy Post

JP=Joint Pole

PP=Power Pole

SP=Service Pole

TP=Telephone Pole

N.T.S.=Not To Scale

Fd.=Conc. Nails with Brass Washers Stamped "S.J. Co.", unless otherwise noted