

CORNER RECORD

Document Number 00-207  
County of San Joaquin, California

City of \_\_\_\_\_

Brief Legal Description Intersection of Eight Mile Road and Golfview Road

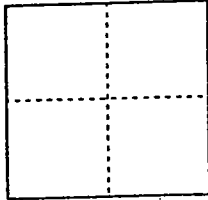

CORNER TYPE

Government Corner  Control   
Meander  Property   
Rancho  Other   
Date of Survey 6-2-00

COORDINATES (Optional)

N. \_\_\_\_\_  
E. \_\_\_\_\_  
Zone \_\_\_\_\_ NAD27  NAD83   
NAD83 Epoch \_\_\_\_\_  
Elev. \_\_\_\_\_  
Vert. Datum: NGVD29  NAVD88   
Meas. Units: Metric  Imperial

Corner - Left as found  Found and tagged  Established  Reestablished  Rebuilt

Identification and type of corner found: Evidence used to identify or procedure used to establish or reestablish the corner:  
Reestablished location of Fd Nail per swings on CR-00-194  
See sketch on Backside

A description of the physical condition of the monument as found and as set or reset:  
Set 3/4" X 30" Iron Pin & Placed Mon Well over Mon  
See sketch on Backside

SURVEYOR'S STATEMENT

This Corner Record was prepared by me or under my direction in conformance with the Land Surveyors' Act on June 14, 2000.

Signed \_\_\_\_\_ L.S. or R.C.E. Number 23341

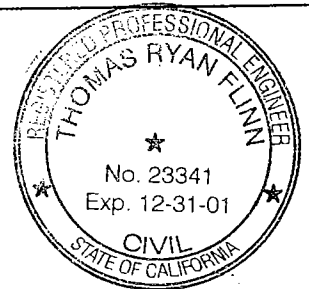

COUNTY SURVEYOR'S STATEMENT

This Corner Record was received JUNE 15, 2000 and examined and filed \_\_\_\_\_, 2000.

Signed \_\_\_\_\_ R.C.E. No. 28054  
Title County Surveyor



County Surveyors Comment \_\_\_\_\_  
\_\_\_\_\_  
\_\_\_\_\_

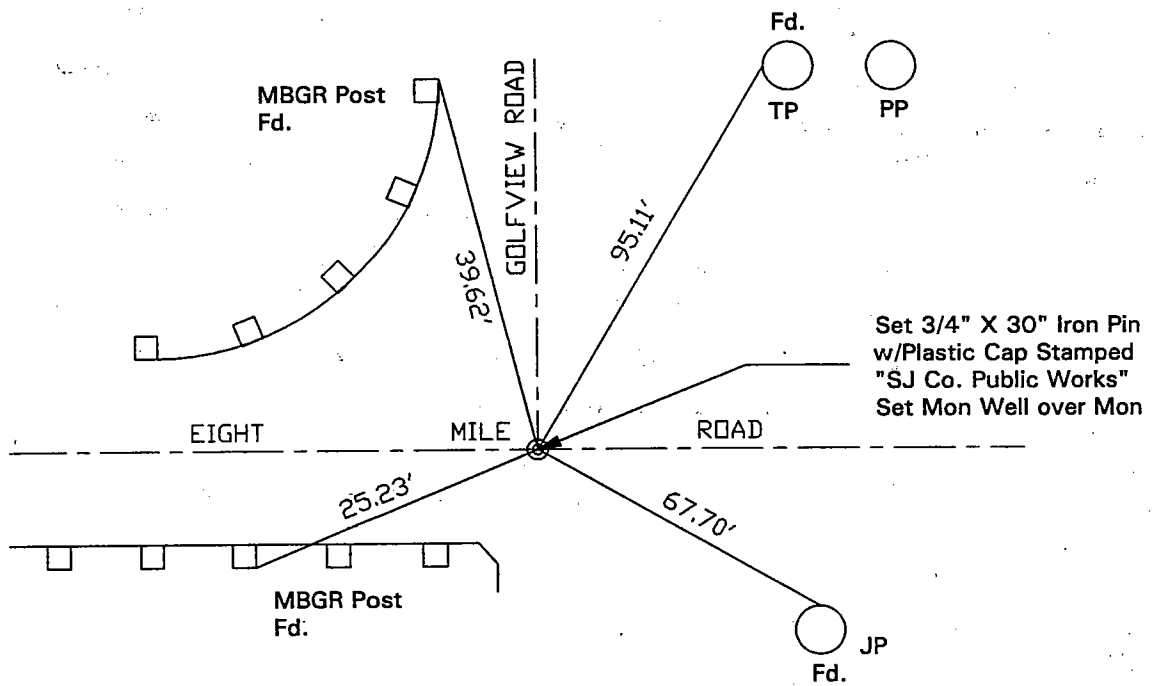

"No Attempt Was Made To Verify Monument(s)"

FP = Fence Post

GP = Guy Post

JP = Joint Pole

PP = Power Pole

SP = Service Pole

TP = Telephone Pole

N.T.S. = Not To Scale

**Fd** = Conc. Nails with Brass Washers Stamped "S.J. Co.", unless otherwise noted