

CORNER RECORD

Document Number 00-146
 County of San Joaquin, California

City of _____

Brief Legal Description INTERSECTION OF LAMMERS ROAD AND CORRAL HOLLOW ROAD

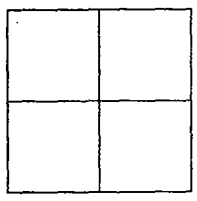

CORNER TYPE

Government Corner Control
 Meander Property
 Rancho Other
 Date of Survey JANUARY 20, 2000

COORDINATES (Optional)

N. _____
 E. _____
 Zone _____ NAD27 NAD83
 NAD83 Epoch _____
 Elev. _____
 Ver. Datum: NGVD29 NAVD88
 Meas. Units: Metric Imperial

Corner - Left as found Found and tagged Established Reestablished Rebuilt

Identification and type of corner found: Evidence used to identify or procedure used to establish or reestablish the corner
SEE SKETCH ON BACKSIDE

A description of the physical condition of the monument as found and as set or reset:
FOUND MONUMENT IN GOOD CONDITION. SEE SKETCH ON BACKSIDE

SURVEYOR'S STATEMENT

This Corner Record was prepared by me or under my direction in conformance with
 the Land Surveyors Act on 7-31, 2000.
 Signed [Signature] L.S. or R.C.E. Number 23341

COUNTY SURVEYOR'S STATEMENT

This Corner Record was received August 1, 2000 and examined
 and filed August 4, 2000.
 Signed [Signature: Manuel Lopez] R.C.E. No. 28054
 Title County Surveyor

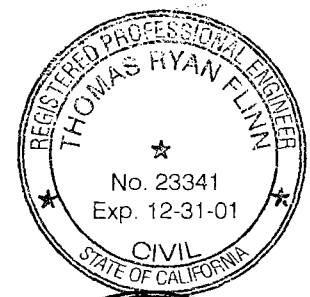

County Surveyors Comment _____

(D.D. Sheet No. 53A)

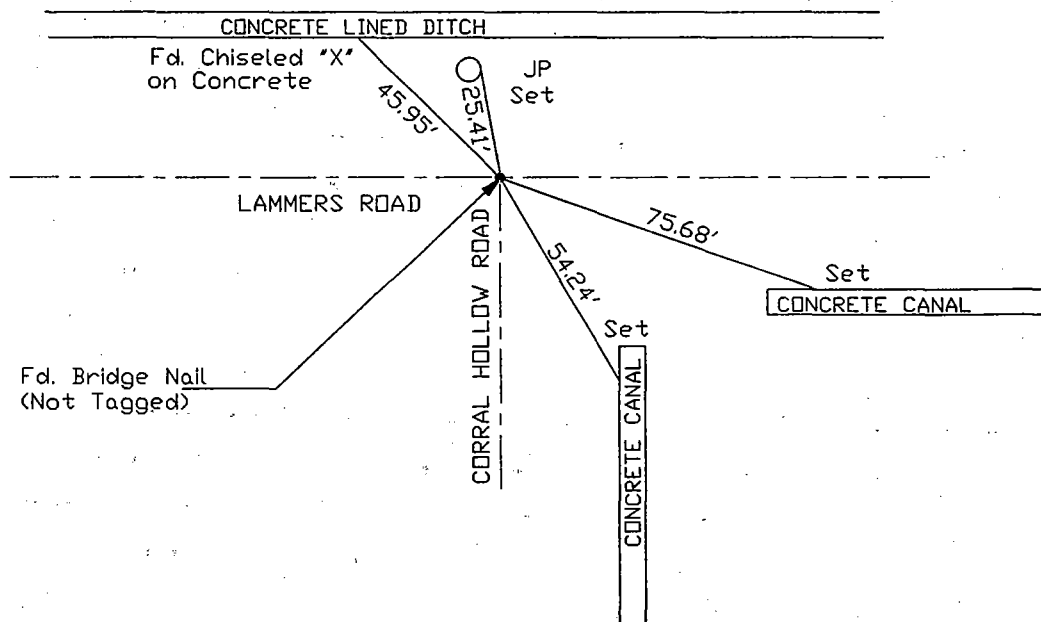

"No Attempt Was Made To Verify Monument(s)"

FP=Fence Post

GP=Guy Post

JP=Joint Pole

PP=Power Pole

SP=Service Pole

TP=Telephone Pole

N.T.S.=Not To Scale

Set=Conc. Nails with Brass Washers Stamped "S.J. Co.", unless otherwise noted