

CORNER RECORD

Document Number 00-127
County of San Joaquin, California

City of _____

Brief Legal Description THE MONUMENT IS ON HARNEY LANE 1,325' EAST OF LOCUST TREE ROAD

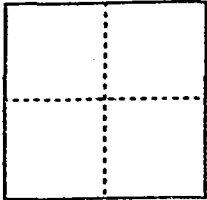

CORNER TYPE

Government Corner Control
Meander Property
Rancho Other

Date of Survey 12-30-99

COORDINATES (Optional)

N. _____
E. _____
Zone _____ NAD27 NAD83
NAD83 Epoch _____
Elev. _____
Vert. Datum: NGVD29 NAVD88
Meas. Units: Metric Imperial

Corner - Left as found Found and tagged Established Reestablished _____ Rebuilt

Identification and type of corner found: Evidence used to identify or procedure used to establish or reestablish the corner:

TAGGED FOUND SHIP SPIKE & WASHER
NOT BOLT AS CALLED FOR BY R.S. 22-115, PER SWING TIES
ON C.R. 06-82. SEE SKETCH ON BACKSIDE

A description of the physical condition of the monument as found and as set or reset: FOUND SHIP SPIKE & WASHER
IN GOOD CONDITION AND
PLACED MONUMENT WELL OVER THE MONUMENT

SURVEYOR'S STATEMENT

This Corner Record was prepared by me or under my direction in conformance with the Land Surveyors' Act on Feb 11, 2000.

Signed [Signature] L.S. or R.C.E. Number 23341



COUNTY SURVEYOR'S STATEMENT

This Corner Record was received 2-15, 2000 and examined and filed 2-15, 2000.

Signed Henry M. Hirata R.C.E. No. 21258
Title County Surveyor

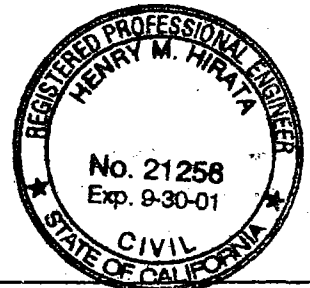

County Surveyors Comment _____

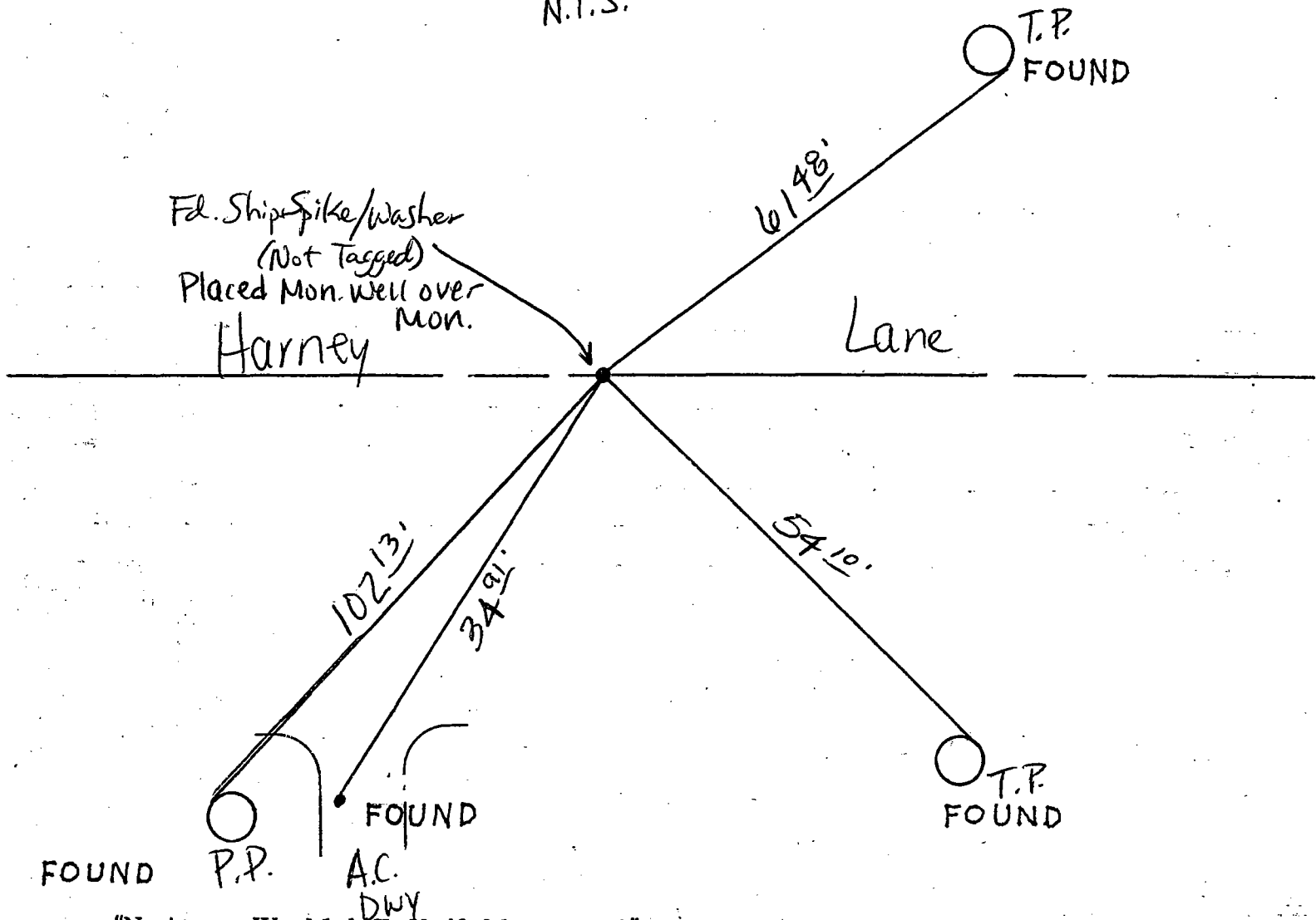

"No Attempt Was Made To Verify Monument(s)"

- FP = Fence Post
- GP = Guy Post
- JP = Joint Pole
- PP = Power Pole
- SP = Service Pole
- TP = Telephone Pole
- N.T.S. = Not To Scale

"FOUND"
means Conc. Nail with
Brass Washer Stamped "S.J. Co."

FOUND := Conc. Nails with Brass Washers Stamped "S.J. Co.", unless otherwise noted