

CORNER RECORD

Document Number 00-122
County of San Joaquin, California

City of _____

Brief Legal Description MONUMENT IS ON HARNEY LANE 4.004'± EAST OF ALPINE ROAD

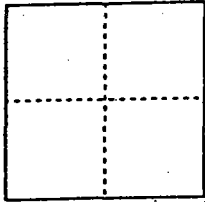

CORNER TYPE

- Government Corner Control
- Meander Property
- Rancho Other

Date of Survey 12-30-99

COORDINATES (Optional)

N. _____
 E. _____
 Zone _____ NAD27 NAD83
 NAD83 Epoch _____
 Elev. _____
 Vert. Datum: NGVD29 NAVD88
 Meas. Units: Metric Imperial

Corner - Left as found Found and tagged Established Reestablished Rebuilt

Identification and type of corner found: Evidence used to identify or procedure used to establish or reestablish the corner:
FOUND PIN & WASHER, NOT TAGGED
PER SWING TIES ON C.R. 00-81. SEE SKETCH
ON BACKSIDE

A description of the physical condition of the monument as found and as set or reset: FOUND PIN & WASHER PER C.R. 00-81 IN GOOD CONDITION AND PLACED MONUMENT WELL OVER MONUMENT

SURVEYOR'S STATEMENT

This Corner Record was prepared by me or under my direction in conformance with the Land Surveyors' Act on Feb 11, 2000.

Signed _____ L.S. or R.C.E. Number 23341

COUNTY SURVEYOR'S STATEMENT

This Corner Record was received 2-15, 2000 and examined and filed 2-15, 2000.

Signed Henry M. Hirata R.C.E. No. 21258

Title County Surveyor

County Surveyors Comment _____

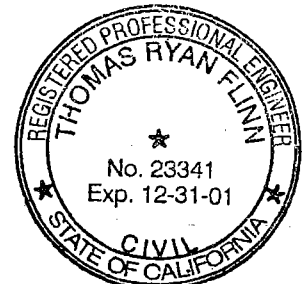

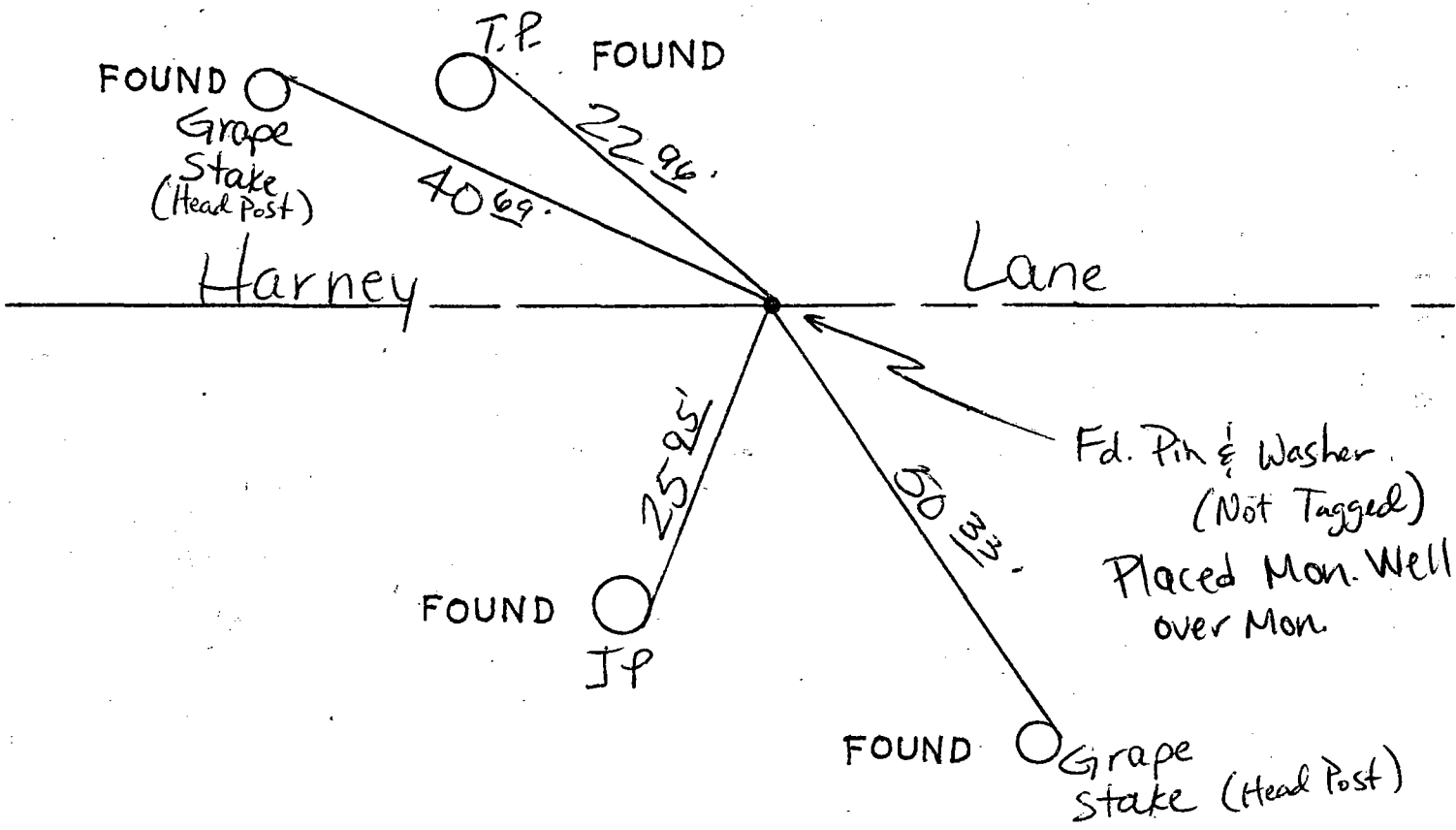
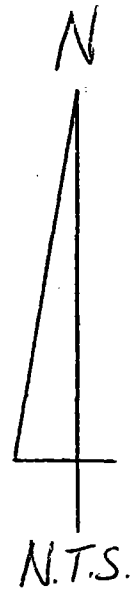

"No Attempt Was Made To Verify Monument(s)"

- FP = Fence Post
- GP = Guy Post
- JP = Joint Pole
- PP = Power Pole
- SP = Service Pole
- TP = Telephone Pole
- N.T.S. = Not To Scale

Set = Conc. Nails with Brass Washers Stamped "S.J. Co.", unless otherwise noted

Note: All ties are nails & washers stamped "S.J. Co."