

CORNER RECORD

Document Number 00-121  
County of San Joaquin, California

City of \_\_\_\_\_

Brief Legal Description THE NORTHWEST CORNER OF SECTION 23,  
T.3 N., R.7 E.

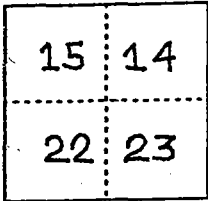

T.3 N., R.7 E.

CORNER TYPE

Government Corner  Control   
 Meander  Property   
 Rancho  Other

Date of Survey 12-30-99

COORDINATES (Optional)

N. \_\_\_\_\_  
 E. \_\_\_\_\_  
 Zone \_\_\_\_\_ NAD27  NAD83   
 NAD83 Epoch \_\_\_\_\_  
 Elev. \_\_\_\_\_  
 Vert. Datum: NGVD29  NAVD88   
 Meas. Units: Metric  Imperial

Corner - Left as found  Found and tagged  Established  Reestablished  Rebuilt

Identification and type of corner found: Evidence used to identify or procedure used to establish or reestablish the corner:

FOUND PIN & WASHER  
(R.S. 22-115 CALLS FOR BOLT), PER SWING TIES ON C.R. 00-120.  
SEE SKETCH ON BACKSIDE.

A description of the physical condition of the monument as found and as set or reset: FOUND PIN &  
WASHER IN GOOD CONDITION AND  
PLACED MONUMENT WELL OVER MONUMENT.

SURVEYOR'S STATEMENT

This Corner Record was prepared by me or under my direction in conformance with the Land Surveyors' Act on Feb 11, 2000.

Signed [Signature] L.S. or R.C.E. Number 23341

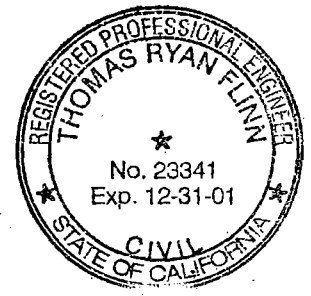

COUNTY SURVEYOR'S STATEMENT

This Corner Record was received 2-15, 2000 and examined and filed 2-15, 2000.

Signed Henry M. Hirata R.C.E. No. 21258  
Title County Surveyor

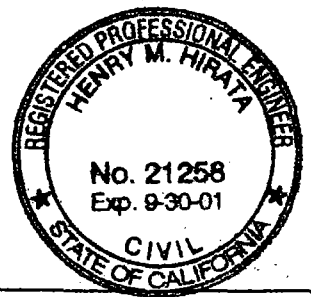

County Surveyors Comment \_\_\_\_\_

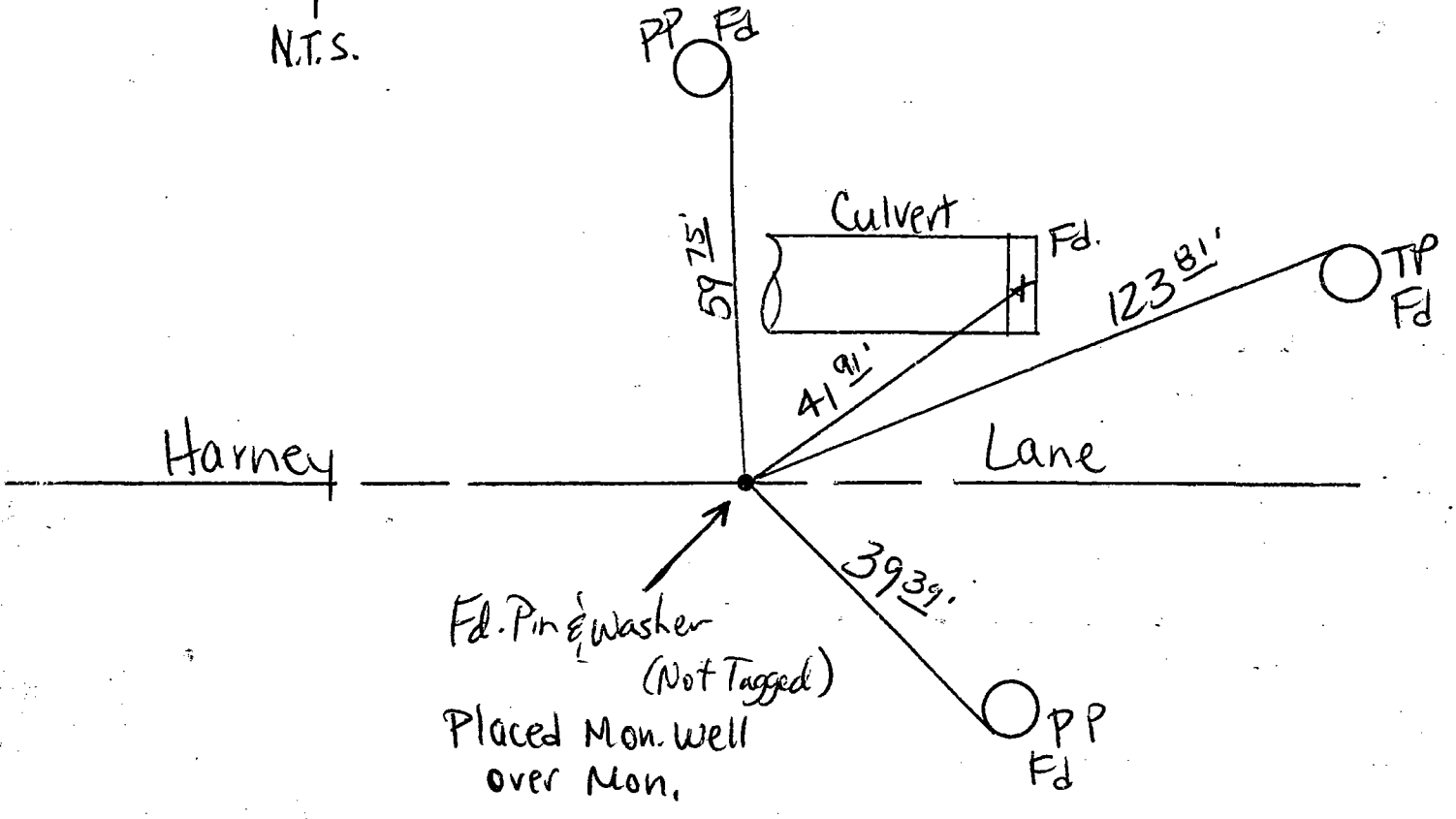

Note: Tie on culvert is a chiseled 't'  
 'Fd.' Ties on poles are nails & washers stamped "S.J. Co."

"No Attempt Was Made To Verify Monument(s)"

- FP = Fence Post
- GP = Guy Post
- JP = Joint Pole
- PP = Power Pole
- SP = Service Pole
- TP = Telephone Pole
- N.T.S. = Not To Scale

Fd. = Conc. Nails with Brass Washers Stamped "S.J. Co.", unless otherwise noted