

CORNER RECORD

Document Number 00-114
County of San Joaquin, California

City of _____

Brief Legal Description N/W CORNER OF SECTION 20, T.3N., RANGE 7 E.

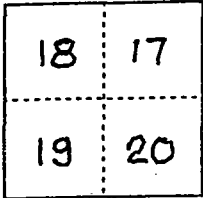

T.3N., R.7E.

CORNER TYPE

Government Corner Control
 Meander Property
 Rancho Other
 Date of Survey 12-30-99

COORDINATES (Optional)

N. _____
 E. _____
 Zone _____ NAD27 NAD83
 NAD83 Epoch _____
 Elev. _____
 Vert. Datum: NGVD29 NAVD88
 Meas. Units: Metric Imperial

Corner - Left as found Found and tagged Established Reestablished Rebuilt

Identification and type of corner found: Evidence used to identify or procedure used to establish or reestablish the corner:

FOUND IRON PIN.
NOTTAGGED PER. R.S. 23-80.
PER SWING TIES ON
ON C.R. 00-113. SEE SKETCH ON BACKSIDE.

A description of the physical condition of the monument as found and as set or reset:

FOUND IRON PIN, PER. R.S. 23-80, IN GOOD CONDITION AND
PLACED MONUMENT WELL OVER MONUMENT. SEE SKETCH
ON BACKSIDE.

SURVEYOR'S STATEMENT

This Corner Record was prepared by me or under my direction in conformance with the Land Surveyors' Act on Feb 11, 2000.

Signed _____ L.S. or P.C.E. Number 23341

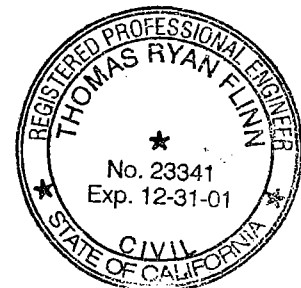

COUNTY SURVEYOR'S STATEMENT

This Corner Record was received 2-15, 2000 and examined and filed 2-15, 2000.

Signed Henry M. Hirata R.C.E. No. 21258
 Title _____ County Surveyor

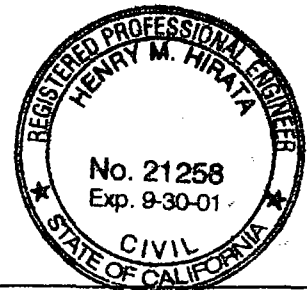

County Surveyors Comment _____

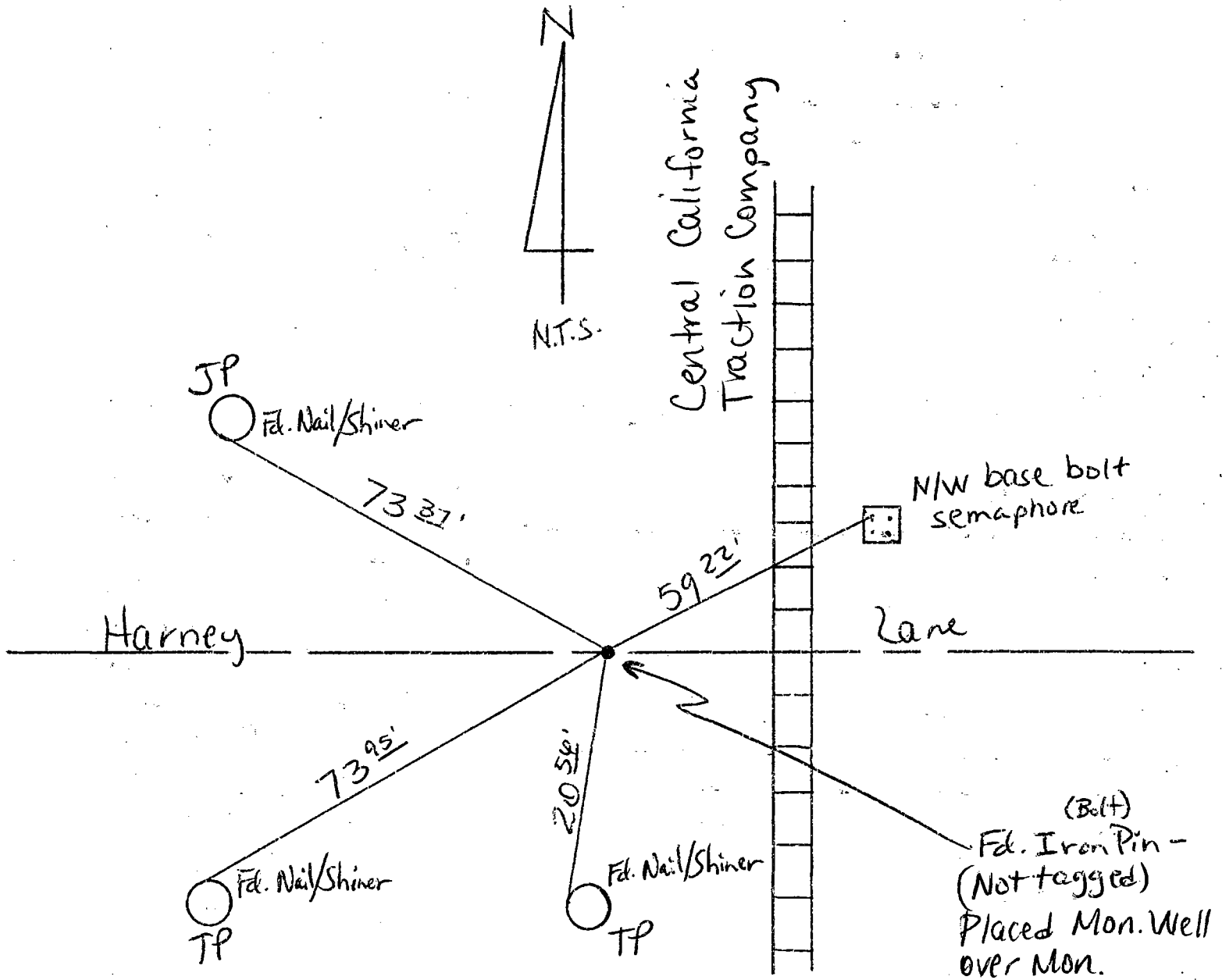

(Bolt)
 Fcd. Iron Pin -
 (Not tagged)
 Placed Mon. Well
 over Mon.

"No Attempt Was Made To Verify Monument(s)"

FP = Fence Post

GP = Guy Post

JP = Joint Pole

PP = Power Pole

SP = Service Pole

TP = Telephone Pole

N.T.S. = Not To Scale

Set = Conc. Nails with Brass Washers Stamped "S.J. Co.", unless otherwise noted