

CORNER RECORD

Document Number 00-111  
County of San Joaquin, California

City of \_\_\_\_\_

Brief Legal Description THE INTERSECTION OF HARNEY LANE AND  
VINTAGE ROAD PER. P.M. 18-50

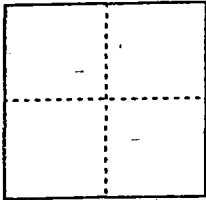

CORNER TYPE

Government Corner  Control   
Meander  Property   
Rancho  Other   
Date of Survey 12-30-99

COORDINATES (Optional)

N. \_\_\_\_\_  
E. \_\_\_\_\_  
Zone \_\_\_\_\_ NAD27  NAD83   
NAD83 Epoch \_\_\_\_\_  
Elev. \_\_\_\_\_  
Vert. Datum: NGVD29  NAVD88   
Meas. Units: Metric  Imperial

Corner - Left as found  Found and tagged  Established  Reestablished \_\_\_\_\_ Rebuilt

Identification and type of corner found: Evidence used to identify or procedure used to establish or reestablish the corner:

BOLT & WASHER PER  
P.M. 18-50 PER. SWING TIES ON C.R. 110. SEE SKETCH ON  
BACKSIDE

A description of the physical condition of the monument as found and as set or reset: FOUND BOLT &  
WASHER PER P.M. 18-50 IN GOOD CONDITION AND PLACED  
MONUMENT WELL OVER MONUMENT

SURVEYOR'S STATEMENT

This Corner Record was prepared by me or under my direction in conformance with  
the Land Surveyors' Act on Feb 11, 2000.

Signed [Signature] LS. or R.C.E. Number 23341

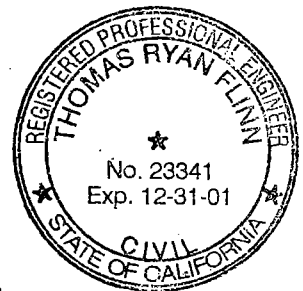

COUNTY SURVEYOR'S STATEMENT

This Corner Record was received 2-15, 2000 and examined  
and filed 2-15, 2000.

Signed Henry M. Hirata R.C.E. No. 21258  
Title \_\_\_\_\_ County Surveyor.

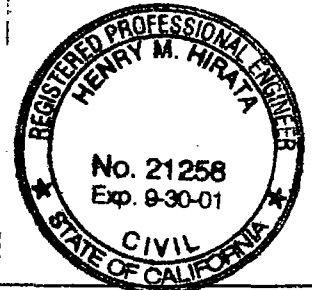

County Surveyors Comment \_\_\_\_\_

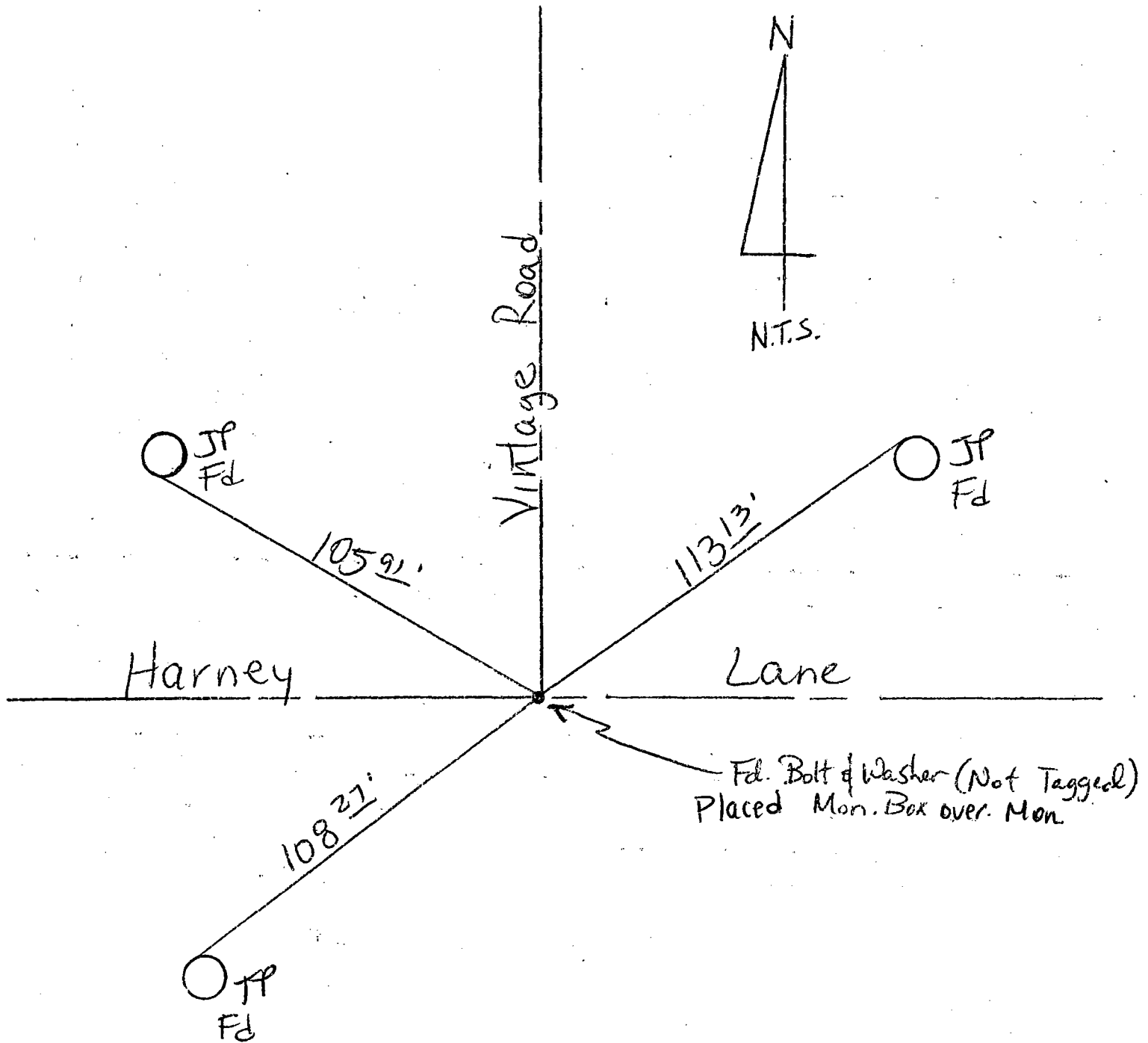

Note: Tie on TP is nail/shiner  
Ties on JP's are nail & washers stamped "S.J. Co."

"No Attempt Was Made To Verify Monument(s)"

- FP = Fence Post
- GP = Guy Post
- JP = Joint Pole
- PP = Power Pole
- SP = Service Pole
- TP = Telephone Pole
- N.T.S. = Not To Scale
- Fd = Conc. Nails with Brass Washers Stamped "S.J. Co.", unless otherwise noted