

CORNER RECORD

Document Number 00-72
County of San Joaquin, California

City of _____

Brief Legal Description AT THE INTERSECTION OF HARNEY LANE AND
CURRY AVE. SOUTH PER. P.M. 18-73

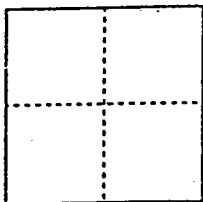

CORNER TYPE

Government Corner Control
Meander Property
Rancho Other

Date of Survey 11-9-99

COORDINATES (Optional)

N. _____
E. _____
Zone _____ NAD27 NAD83
NAD83 Epoch _____
Elev. _____
Vert. Datum: NGVD29 NAVD88
Meas. Units: Metric Imperial

Corner - Left as found Found and tagged Established Reestablished Rebuilt

Identification and type of corner found: Evidence used to identify or procedure used to establish or reestablish the corner:

SEE SKETCH ON BACKSIDE

A description of the physical condition of the monument as found and as set or reset:

FOUND MONUMENT IN GOOD CONDITION
SEE SKETCH ON BACKSIDE

SURVEYOR'S STATEMENT

This Corner Record was prepared by me or under my direction in conformance with the Land Surveyors Act on Feb 4, 2000.

Signed [Signature] L.S. or R.C.E. Number 23341

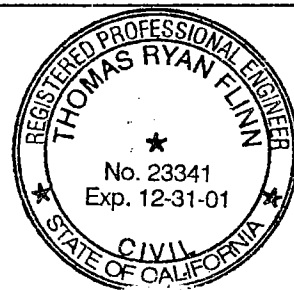

COUNTY SURVEYOR'S STATEMENT

This Corner Record was received 2-4-, 2000 and examined and filed 2-7-, 2000.

Signed Henry M. Hirata R.C.E. No. 21258
Title County Surveyor



County Surveyors Comment _____

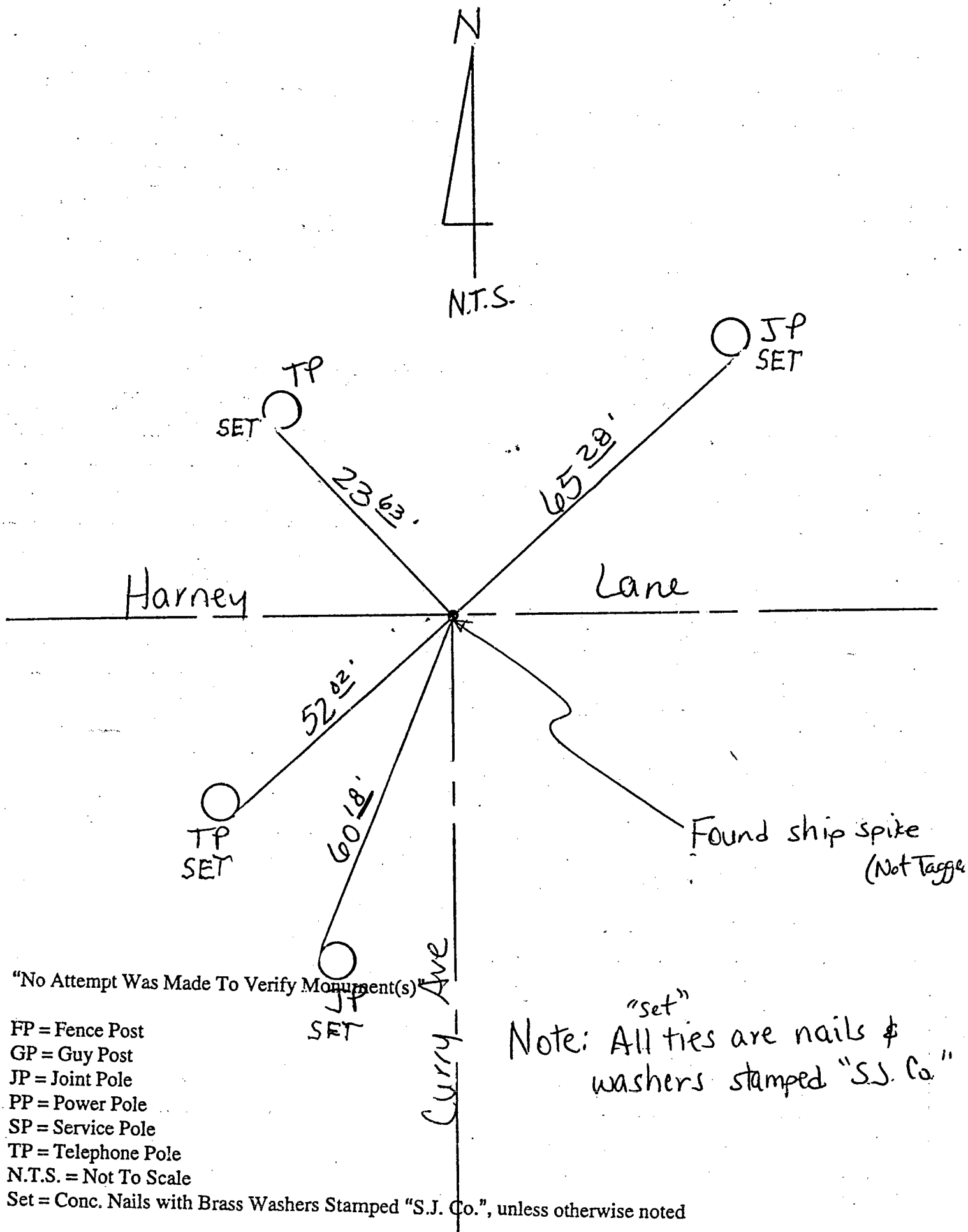

N
N.T.S.

TP
SET
23.63'

JP
SET
65.28'

Harney

Lane

TP
SET
52.02'

JP
SET
60.18'

Found ship spike
(Not Tagged)

Curry Ave

"No Attempt Was Made To Verify Monument(s)"

Note: All ties are nails & washers stamped "S.J. Co."

- FP = Fence Post
- GP = Guy Post
- JP = Joint Pole
- PP = Power Pole
- SP = Service Pole
- TP = Telephone Pole
- N.T.S. = Not To Scale

Set = Conc. Nails with Brass Washers Stamped "S.J. Co.", unless otherwise noted