

CORNER RECORD

Document Number 00-65
County of San Joaquin, California

City of _____

Brief Legal Description SW corner of N/W 1/4 of section 14, T.3N., R.8E.
per R.S. 27-92

T.3N., R.8E.

CORNER TYPE

COORDINATES (Optional)

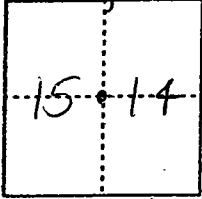

Government Corner Control
Meander Property
Rancho Other

N. _____
E. _____
Zone _____ NAD27 NAD83
NAD83 Epoch _____
Elev. _____
Vert. Datum: NGVD29 NAVD88
Meas. Units: Metric Imperial

Date of Survey 10-06-99

Corner - Left as found Found and tagged Established Reestablished Rebuilt

Identification and type of corner found: Evidence used to identify or procedure used to establish or reestablish the corner:

See Sketch on Backside

A description of the physical condition of the monument as found and as set or reset:

Found Monument in good condition
See sketch on Backside

SURVEYOR'S STATEMENT

This Corner Record was prepared by me or under my direction in conformance with the Land Surveyors' Act on 2 Feb, 2000.

Signed [Signature] L.S. or R.C.E. Number 23341



COUNTY SURVEYOR'S STATEMENT

This Corner Record was received 2-4-, 2000 and examined and filed 2-7-, 2000.

Signed Henry M. Hirata R.C.E. No. 21258

Title County Surveyor



County Surveyors Comment _____



Set
 CHISELED "X" ON 3/4" REBAR
 METAL GATE POST

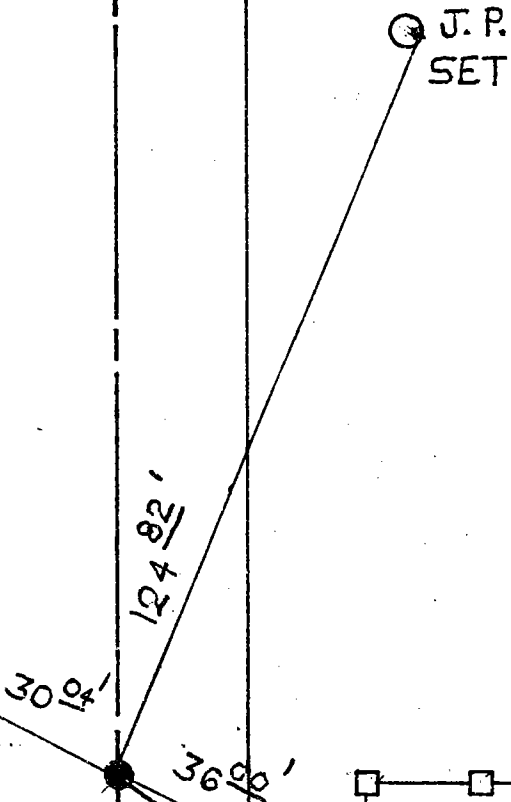

(R.K.) (Not tagged)
 FOUND NAIL PER. R.S. 27-92

CLEMENTS ROAD

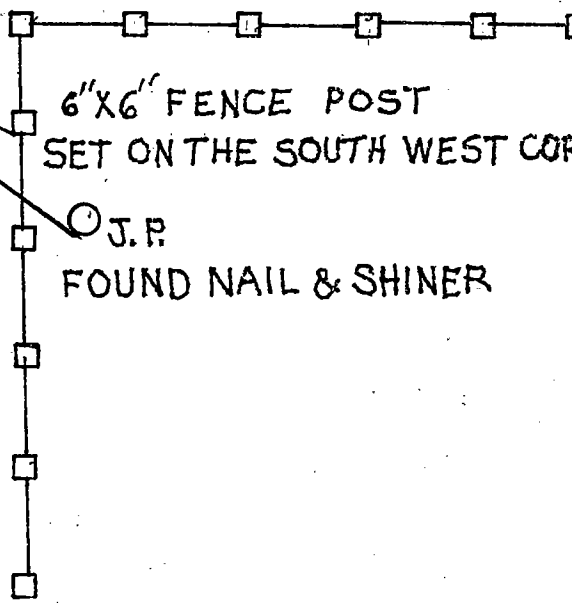

"No attempt was made to verify Monument"

- GP = Guy Pole
- PP = Power Pole
- JP = Joint Pole
- SP = Service Pole
- TP = Telephone Pole
- FP = Fence Post

N.T.S. = Not To Scale

"Set" = Conc. Nails With Brass Washers Stamped "S.J. Co." unless otherwise noted