

CORNER RECORD

Document Number 00-57  
County of San Joaquin, California

City of \_\_\_\_\_

Brief Legal Description Intersection of DeVries Road and Kingdon Road and north of intersection 175S± per RS-13-87

CORNER TYPE

COORDINATES (Optional)

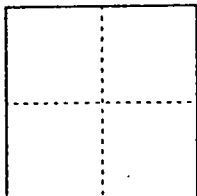

Government Corner  Control   
Meander  Property   
Rancho  Other   
Date of Survey 10-26-99

N. \_\_\_\_\_  
E. \_\_\_\_\_  
Zone \_\_\_\_\_ NAD27  NAD83   
NAD83 Epoch \_\_\_\_\_  
Elev. \_\_\_\_\_  
Vert. Datum: NGVD29  NAVD88   
Meas. Units: Metric  Imperial

Corner - Left as found  Found and tagged  Established  Reestablished  Rebuilt

Identification and type of corner found: Evidence used to identify or procedure used to establish or reestablish the corner:  
See Sketch on Backside

A description of the physical condition of the monument as found and as set or reset:  
Found Monuments in good condition  
See Sketch on Backside

SURVEYOR'S STATEMENT

This Corner Record was prepared by me or under my direction in conformance with the Land Surveyors' Act on 2 Feb, 2000

Signed \_\_\_\_\_ LS. or R.C.E. Number 23341

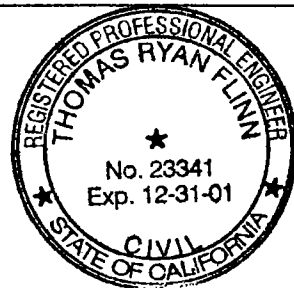

COUNTY SURVEYOR'S STATEMENT

This Corner Record was received 2-4-, 2000 and examined and filed 2-7-, 2000.

Signed Henry M. Hirata R.C.E. No. 21258  
Title County Surveyor

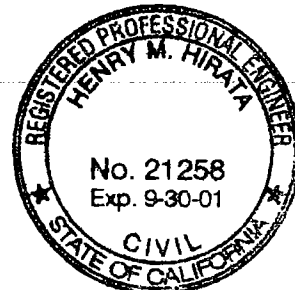

County Surveyors Comment \_\_\_\_\_

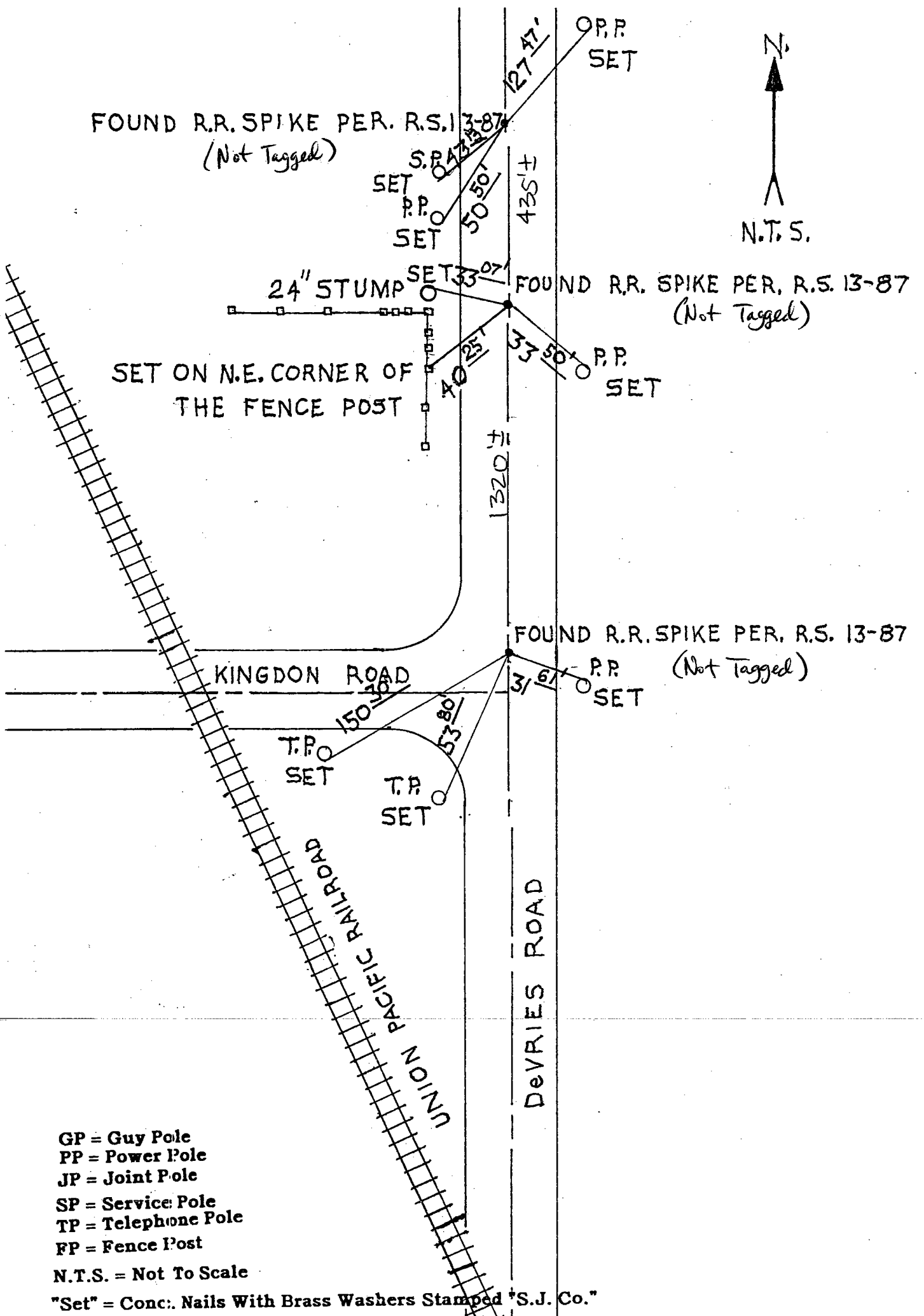

FOUND R.R. SPIKE PER. R.S. 13-87  
(Not Tagged)

FOUND R.R. SPIKE PER. R.S. 13-87  
(Not Tagged)

FOUND R.R. SPIKE PER. R.S. 13-87  
(Not Tagged)

SET ON N.E. CORNER OF  
THE FENCE POST

24" STUMP

- GP = Guy Pole
- PP = Power Pole
- JP = Joint Pole
- SP = Service Pole
- TP = Telephone Pole
- FP = Fence Post

N.T.S. = Not To Scale

"Set" = Conc. Nails With Brass Washers Stamped "S.J. Co."