

CORNER RECORD

Document Number CR-99-20
County of San Joaquin, California

City of _____

Brief Legal Description LOCATED IN THE NORTH HALF OF SECTION
2, T. 2S, R. 9E, M. 1DM

CORNER TYPE

COORDINATES (Optional)

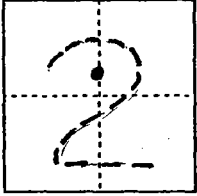

- Government Corner Control
- Meander Property
- Rancho Other

Date of Survey AUGUST 29, 1999

N. _____
 E. _____
 Zone _____ NAD27 NAD83
 NAD83 Epoch _____
 Elev. _____
 Vert. Datum: NGVD29 NAVD88
 Meas. Units: Metric Imperial

Corner - Left as found Found and tagged Established Reestablished Rebuilt

Identification and type of corner found: Evidence used to identify or procedure used to establish or reestablish the corner:

FOUND 3/4" SQUARE STEEL PIN PER RECORD OF SURVEYS
BOOK 4 PAGE 163 OF SAN JOAQUIN COUNTY RECORDS.
NO ATTEMPT WAS MADE TO DETERMINE THE VALIDITY OF THE
MONUMENT OR ITS PROPER LOCATION IN RELATION TO LEGAL
BOUNDARY LINES IN THE AREA.

A description of the physical condition of the monument as found and as set or reset: MONUMENT WELL
"TYPE D" WAS PLACED OVER EXISTING MONUMENT AT
SURFACE OF NEW PAVEMENT PER CALTRANS CONTRACT
NO 296614. NO SWING TIES SET.

SURVEYOR'S STATEMENT

This Corner Record was prepared by me or under my direction in conformance with the Land Surveyors' Act on AUGUST 29, 1999.

Signed William J. Blair L.S. or R.C.E. Number 6489

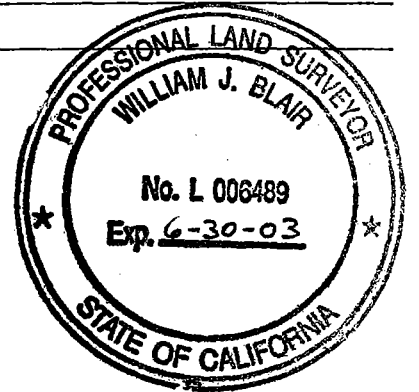

COUNTY SURVEYOR'S STATEMENT

This Corner Record was received October 14, 1999 and examined and filed October 25, 1999.

Signed Manuel Lopez R.C.E. No. 21258

Title Deputy County Surveyor



County Surveyor's Comment _____

(D.D. Sheet No. 63)

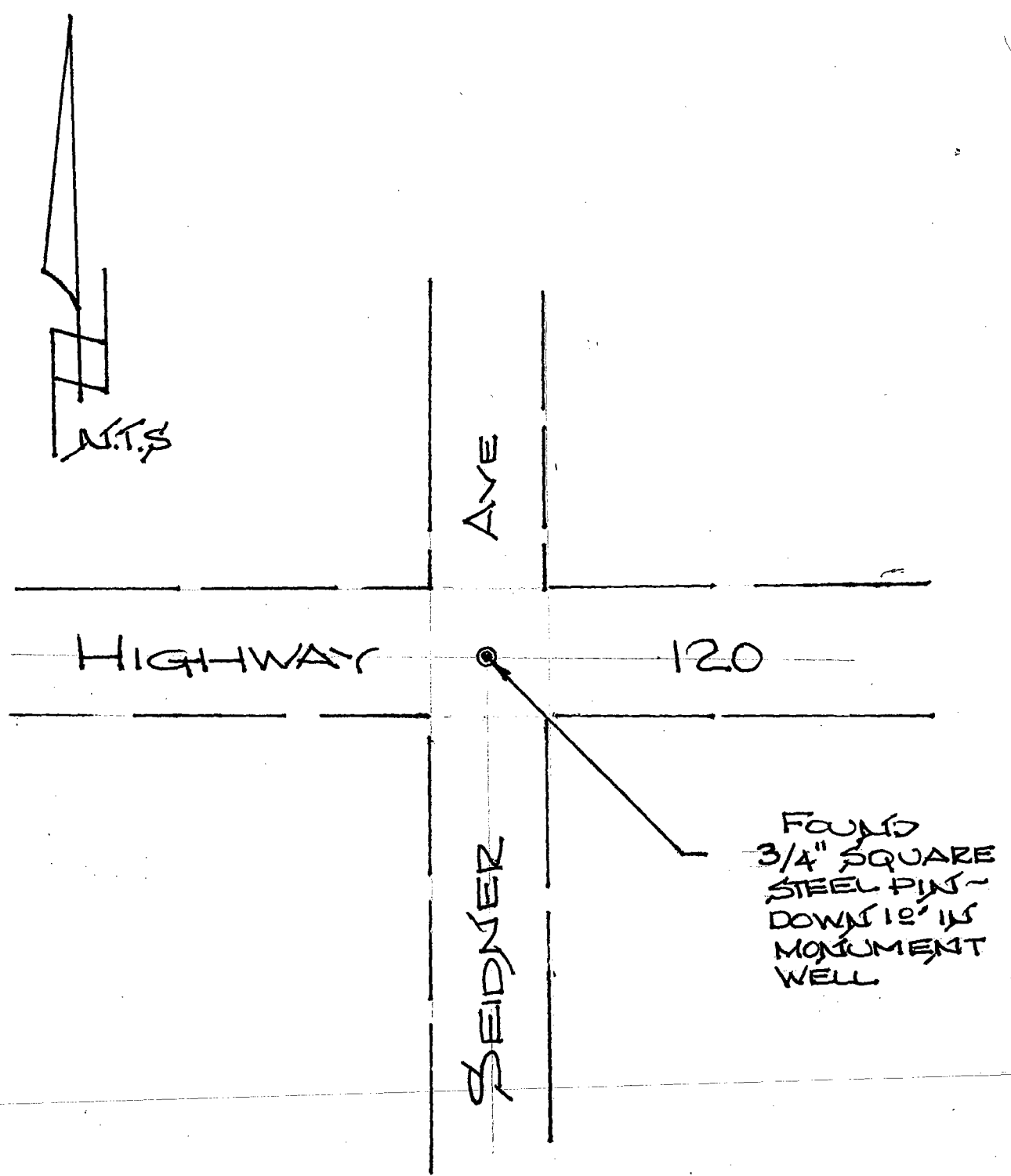

N. 1/2 OF SECTION 2, T. 2 S, R. 9 E.
M. D. M