

CORNER RECORD

Document Number CR-97-33

City of \_\_\_\_\_

County of San Joaquin, California

Brief Legal Description S/E Corner of N/E 1/4 of Sec. 14, T.2S., R.8E., M.D.B. & M.

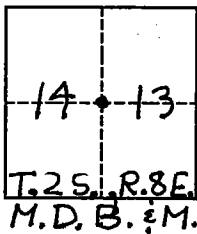

CORNER TYPE

COORDINATES  
(Optional)

Government Corner  Control   
Meander  Property   
Rancho  Other   
Date of Survey 9-12-96

N. \_\_\_\_\_  
E. \_\_\_\_\_  
Zone \_\_\_\_\_ Datum \_\_\_\_\_  
Elev. \_\_\_\_\_

Corner - Left as found  Found and tagged  Established  Reestablished  Rebuilt

Identification and type of corner found: Evidence used to identify or procedure used to establish or reestablish the corner: Reestablished Corner From Swing Ties Per Corner Record 95-015 (7-21-95)

A description of the physical condition of the monument as found and as set or reset: Set P.K. & Shiner In New Surface After Overlay Project

SURVEYOR'S STATEMENT

This Corner Record was prepared by me or under my direction in conformance with the Land Surveyor's Act on Dec 18, 19 97.  
Signed [Signature] - L.S. or R.C.E. Number 25341



COUNTY SURVEYOR'S STATEMENT

This Corner Record was received December 18, 19 97 and examined and filed January 2, 19 98.  
Signed Henry M. Hirata Title COUNTY SURVEYOR



County Surveyor's Comment \_\_\_\_\_

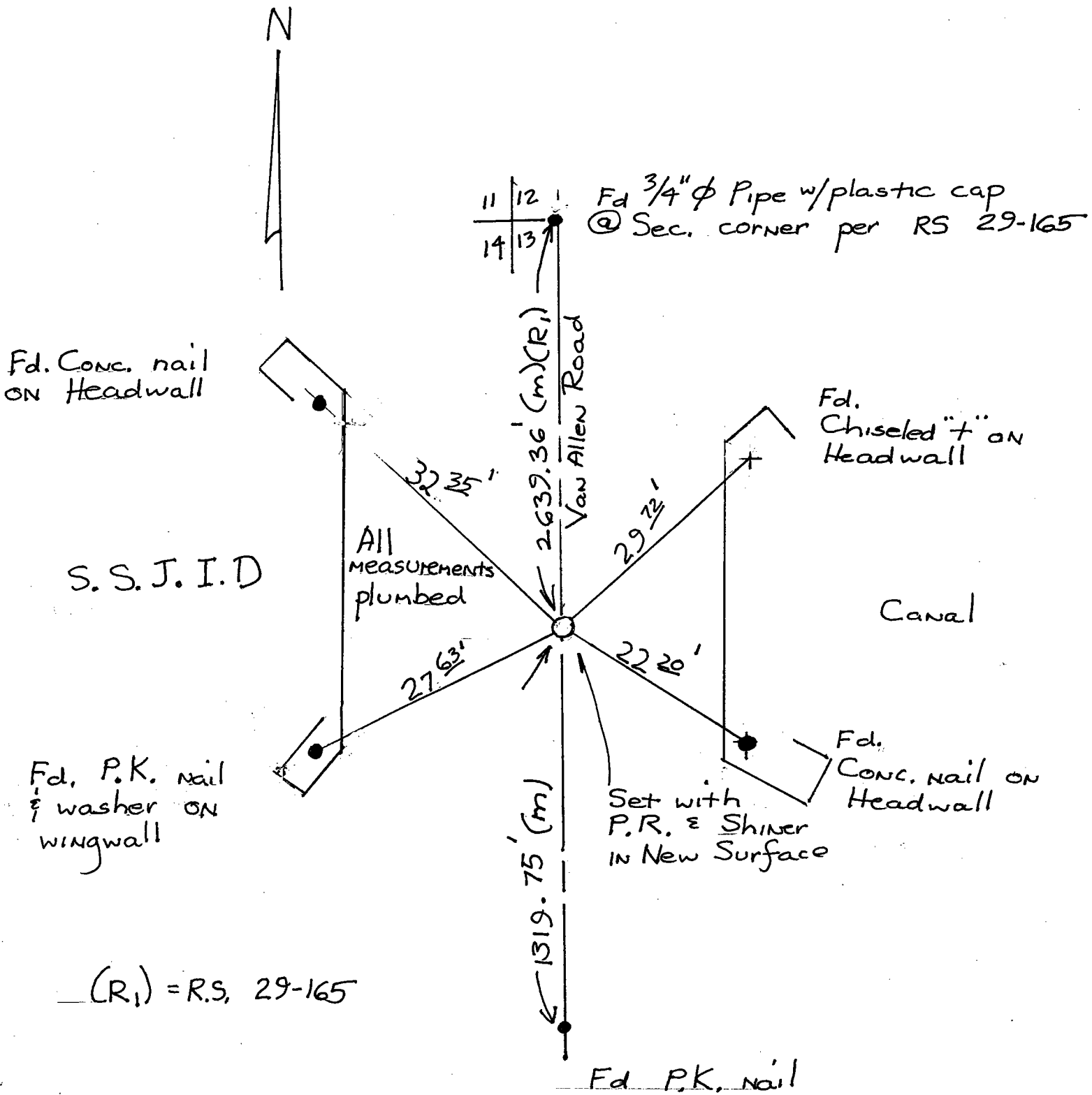

(R<sub>1</sub>) = R.S. 29-165