

CORNER RECORD

DPD-3011 (NEW 11/93)

Document Number CR-95-003

City of MANTEDA County of SAN JOAQUIN, California

Brief Legal Description SECT. COR. 4,5,8,9 T25R7E MDM

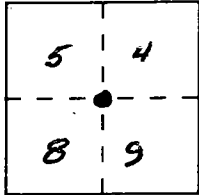

CORNER TYPE

Government Corner Control
 Meander Property
 Rancho Other
 Date of Survey 2-15-95

Coordinates (Optional)

N. _____
 E. _____
 Zone _____ NAD: '27 _____ '83 _____
 NAD-83 Epoch _____
 Elevation _____

Corner — Left as found Found and tagged Established Reestablished Rebuilt

Identification and type of corner found: Evidence used to identify or procedure used to establish or reestablish the corner:

BRASS CAP, CALIFORNIA DIVISION OF HIGHWAYS, STAMPED
MDB+M ^{5/4} _{8/9} T25R7E

A description of the physical condition of the monument as found and as set or reset: MONUMENT

IN GOOD CONDITION - IN MONUMENT WELL, DOWN 0.15'
AND MAY BE DISTURBED BY CURRENT CONSTRUCTION.

SURVEYOR'S STATEMENT

This Corner Record was prepared by me or under my direction in conformance with the Land Surveyors' Act on 2-15, 19 95.

Signed Ralph Scheel, Jr. L.S. or R.C.E. Number 3730
 For the State of California
 Department of Transportation

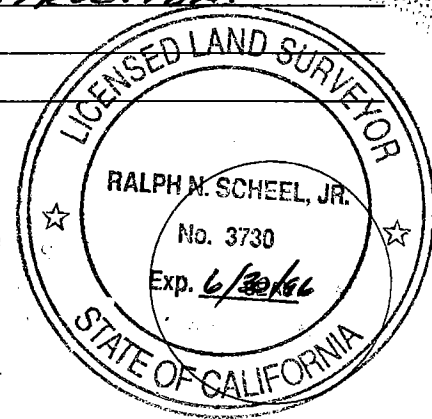

COUNTY SURVEYOR'S STATEMENT

This Corner Record was received February 22, 19 95 and examined and filed March 17, 19 95.

Signed Henry M. Hirata Title County Surveyor



County Surveyor's Comment _____

5/4 T2S R7E MDM
8/9

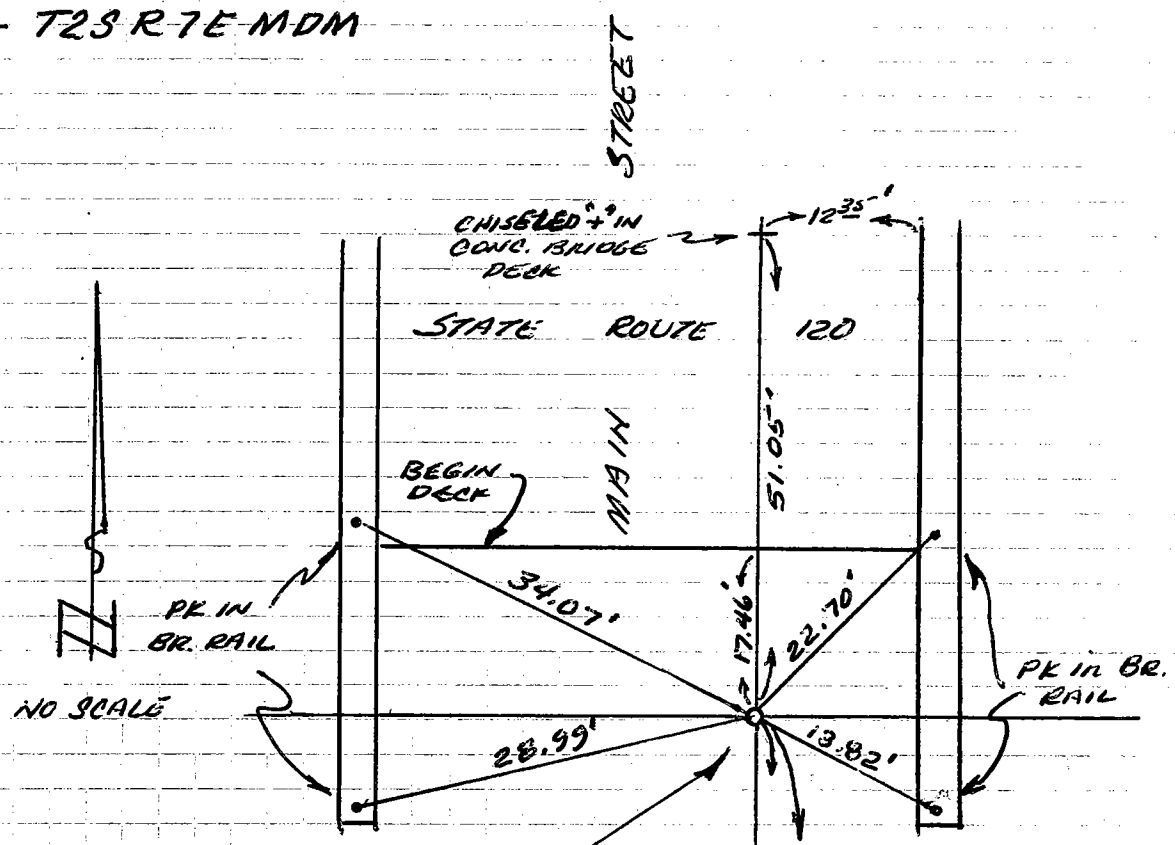

NO SCALE

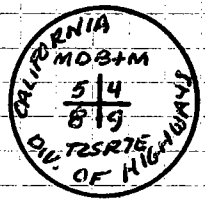

BRASS CAP IN MON. WELL

QUINTAL Fd COUNTY BOLT & WASHER SOUTH MANTECA ROAD

WOODWARD ROAD

Fd BOLT ~~Cap~~ IN MON. WELL