

CORNER RECORD

CITY OF STOCKTON,
COUNTY OF SAN JOAQUIN T. _____ R. _____ MERIDIAN CALIFORNIA

CORNER TYPE: GOV'T. CORNER MEANDER RANCHO CONTROL OTHER

CORNER IDENTIFICATION — DATE OF VISIT _____ 19__

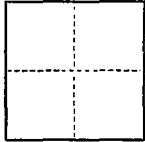

RESET CORNER TO LOTS 2, 4, 6, 8, 10 & 12, BLOCK 33
STOCKTON CITY HOMESTEAD ASSOCIATION
MAPS AND PLATS VOL. 2, Pg. 44, SAN JOAQUIN COUNTY RECORDS

CORNER — LEFT AS FOUND FOUND AND TAGGED REESTABLISHED OBLITERATED CORNER REBUILT

PHYSICAL DESCRIPTION OF CORNER FOUND; EVIDENCE AND METHOD USED TO IDENTIFY OR REESTABLISH

FOUND CHISELED CROSSES AT OFFSET DISTANCES TO BLOCK CORNERS AS SHOWN. FOUND 3/4" REBARS (NO TAG'S) IN MONUMENT BOXES AT CENTERLINE LOCATIONS SHOWN

PHYSICAL DESCRIPTION OF MONUMENTS REBUILT OR PERPETUATED

SET 3/4" REBAR WITH CAPS STAMPED LS4334 AT REAR CORNERS SET 6' OFFSET CHISELED CROSSES TO FRONT CORNERS. POINT ESTABLISHED BY INTERSECTION FROM FOUND MONUMENTS AND PRORATING OF BLOCK DISTANCES. NO VARIANCE FROM STOCKTON STANDARD MEASUREMENT ENCOUNTERED

CALIFORNIA COORDINATE SYSTEM ORDER: FIRST SECOND THIRD
STATIONS USED: NGS (USC & GS) STATE COUNTY OTHER STATION _____ STATION _____
ZONE _____ ELEVATION _____ NORTHINGS (Y) _____ EASTINGS (X) _____

(Fold)

SKETCH: (Include reference tie or witness points, remarks and topo of area)

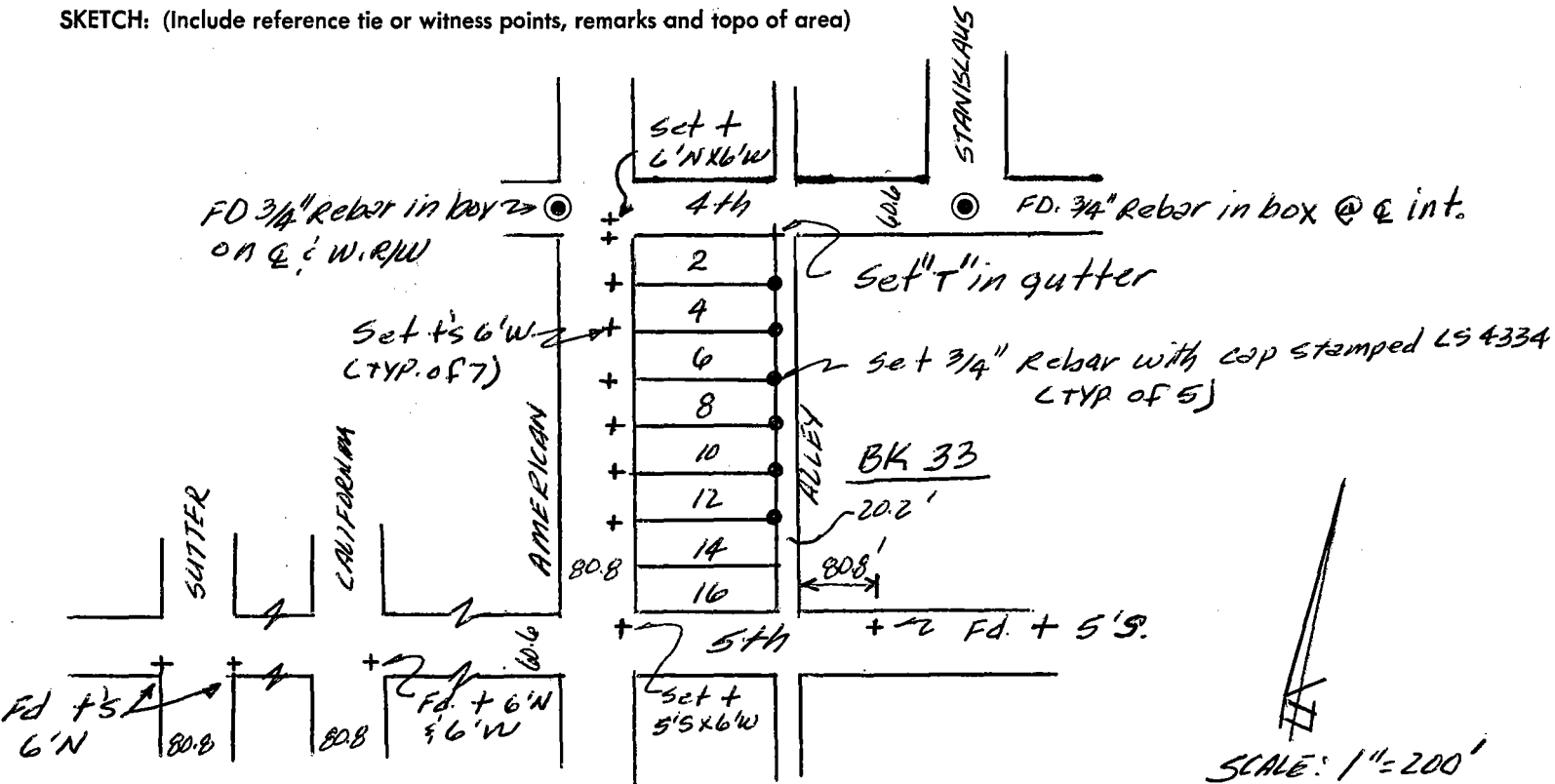

SURVEYOR'S CERTIFICATE

THIS CORNER RECORD WAS PREPARED BY ME OR UNDER MY DIRECTION IN CONFORMANCE WITH THE LAND SURVEYORS ACT ON MARCH 2, 1992

SIGNED: Stephen R. Thumert
(L.S.) or R.C.E. No.: 4334

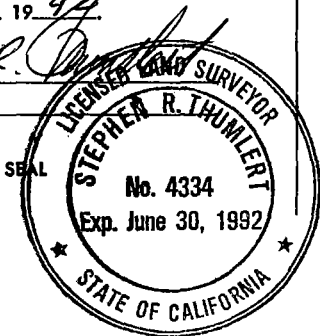

COUNTY SURVEYOR'S CERTIFICATE

THE CORNER RECORD WAS RECEIVED MARCH 4, 1992
AND EXAMINED AND FILED MARCH 10, 1992
BY: Robert J. DeLamater
TITLE: Chief Deputy County Surveyor

DOCUMENT No. CR-92-002

STATEMENT ON BACK OF SHEET

YES NO