

CORNER RECORD

Document Number CR-91-012

City of STOCKTON County of SAN JOAQUIN, California

Brief Legal Description CITY MONUMENT IN INTERSECTION OF 'D' ST & MARKET ST.

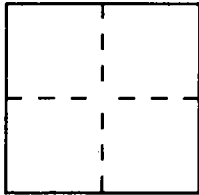

CORNER TYPE

Government Corner Control
Meander Property
Rancho Other
Date of Survey 10-23-91

**COORDINATES
(Optional)**

N. _____
E. _____
Zone _____ Datum _____
Elev. _____

Corner — Left as found Found and tagged Established Reestablished Rebuilt

Identification and type of corner found: Evidence used to identify or procedure used to establish or reestablish the corner: 1 1/4" IRON PIN IN INTERSECTION OF 'D' & MARKET STS., 10' ± EAST OF CENTERLINE OF 'D' STREET. — CITY MONUMENT

A description of the physical condition of the monument as found and as set or reset: MONUMENT IN GOOD CONDITION — WILL BE DESTROYED BY CONSTRUCTION.

SURVEYOR'S STATEMENT

This Corner Record was prepared by me or under my direction in conformance with the Land Surveyors' Act on OCT. 23 1991.

Signed Ralph Scheel, Jr. L.S. or R.C.E. Number LS 3730
Exp 6-30-92

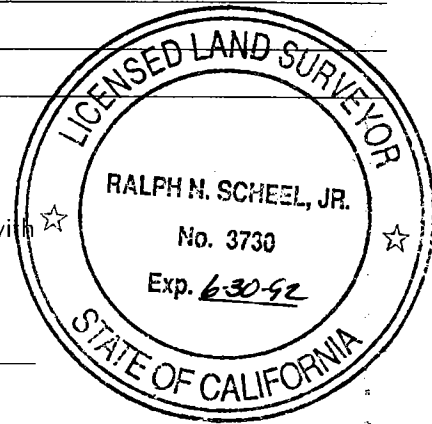

COUNTY SURVEYOR'S STATEMENT

This Corner Record was received December 16, 1991 and examined and filed December 23, 1991.

Signed Robert Dehromek Title Chief Deputy County Surveyor

County Surveyor's Comment _____

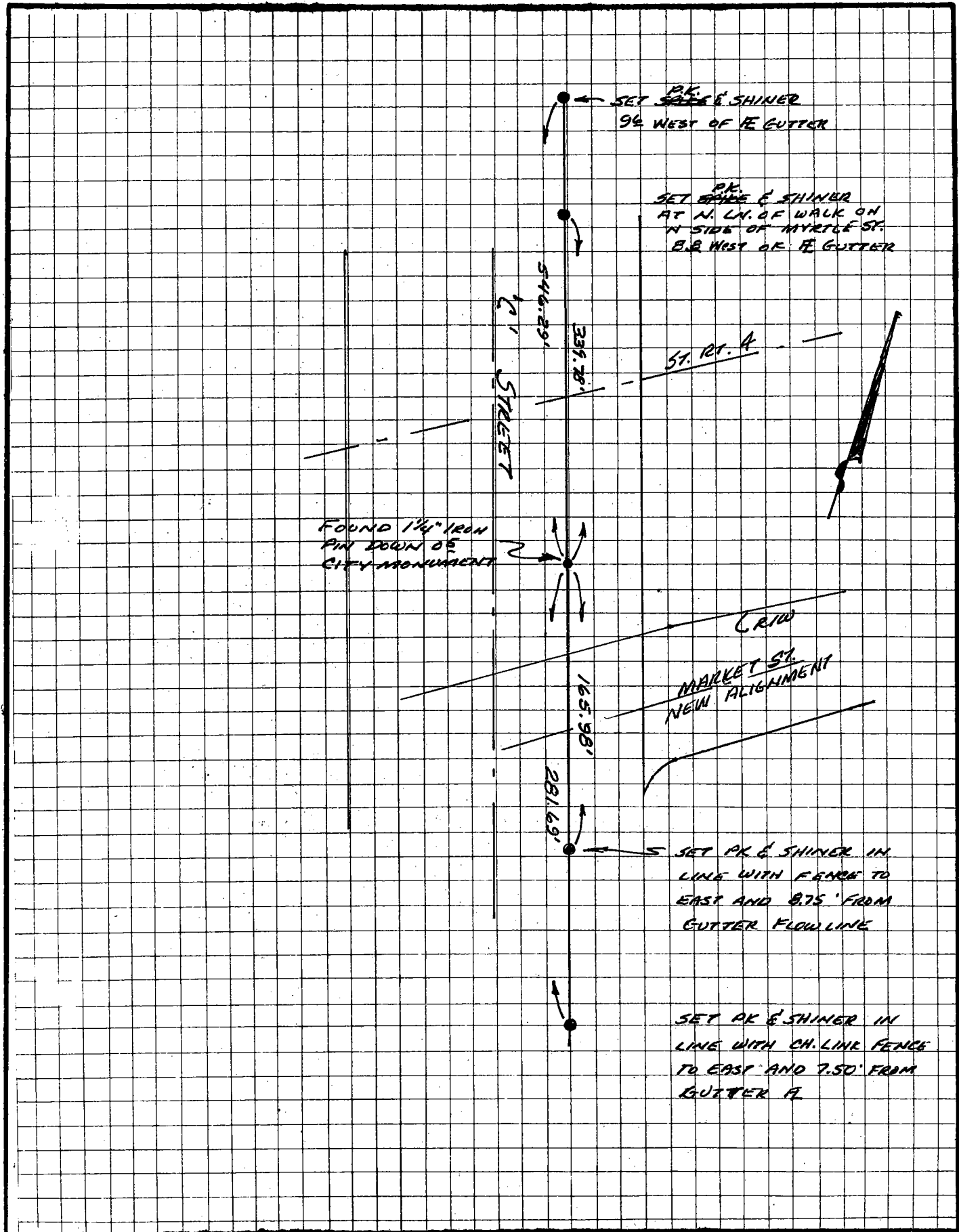

PK. & SHINER
 SET ~~SAFER~~ 94 WEST OF FE GUTTER

PK. & SHINER
 SET ~~SAFER~~ AT N. LI. OF WALK ON N SIDE OF MYRTLE ST. 8.2 WEST OF FE GUTTER

MYRTLE STREET

ST. RT. A

FOUND 1 1/2" IRON PIN DOWN OF CITY MONUMENT

CRWD
 MARKET ST.
 NEW ALIGNMENT

SET PK. & SHINER IN LINE WITH FENCE TO EAST AND 8.75' FROM GUTTER FLOW LINE

SET PK. & SHINER IN LINE WITH CH. LINE FENCE TO EAST AND 7.50' FROM GUTTER A

546.91'

1.82' SEE

165.98'

281.69'