

CORNER RECORD

Document Number CR-91-004

City of STOCKTON

County of SAN JOAQUIN, California

Brief Legal Description INTERSECTION OF LOCUST AVE. AND WASHINGTON ST. AND LOCUST AVE. BELAFAYETTE ST.

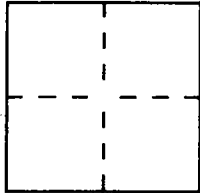

CORNER TYPE

Government Corner Control
Meander Property
Rancho Other
Date of Survey 10-22-91

COORDINATES
(Optional)

N. _____
E. _____
Zone _____ Datum _____
Elev. _____

Corner — Left as found Found and tagged Established Reestablished Rebuilt

Identification and type of corner found: Evidence used to identify or procedure used to establish or reestablish the corner: 1 1/4" DIA. IRON PINS IN MONUMENT BOXES IN CENTER OF INTERSECTIONS - CITY MONUMENTS

A description of the physical condition of the monument as found and as set or reset: MONUMENTS ARE IN GOOD CONDITION AT THIS TIME - COULD BE DESTROYED BY CONSTRUCTION.

SURVEYOR'S STATEMENT

This Corner Record was prepared by me or under my direction in conformance with the Land Surveyors' Act on Oct. 22 1991.

Signed Ralph Scheel, Jr. L.S. or R.C.E. Number LS 3730
EXP 6-30-92

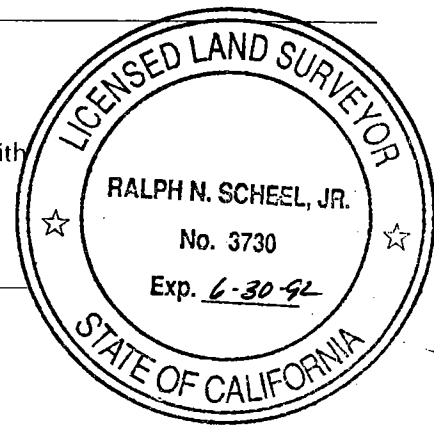

COUNTY SURVEYOR'S STATEMENT

This Corner Record was received December 16, 1991 and examined and filed December 23, 1991.

Signed Robert J. Debrausk Title Chief Deputy County Surveyor

County Surveyor's Comment _____

8,9,10

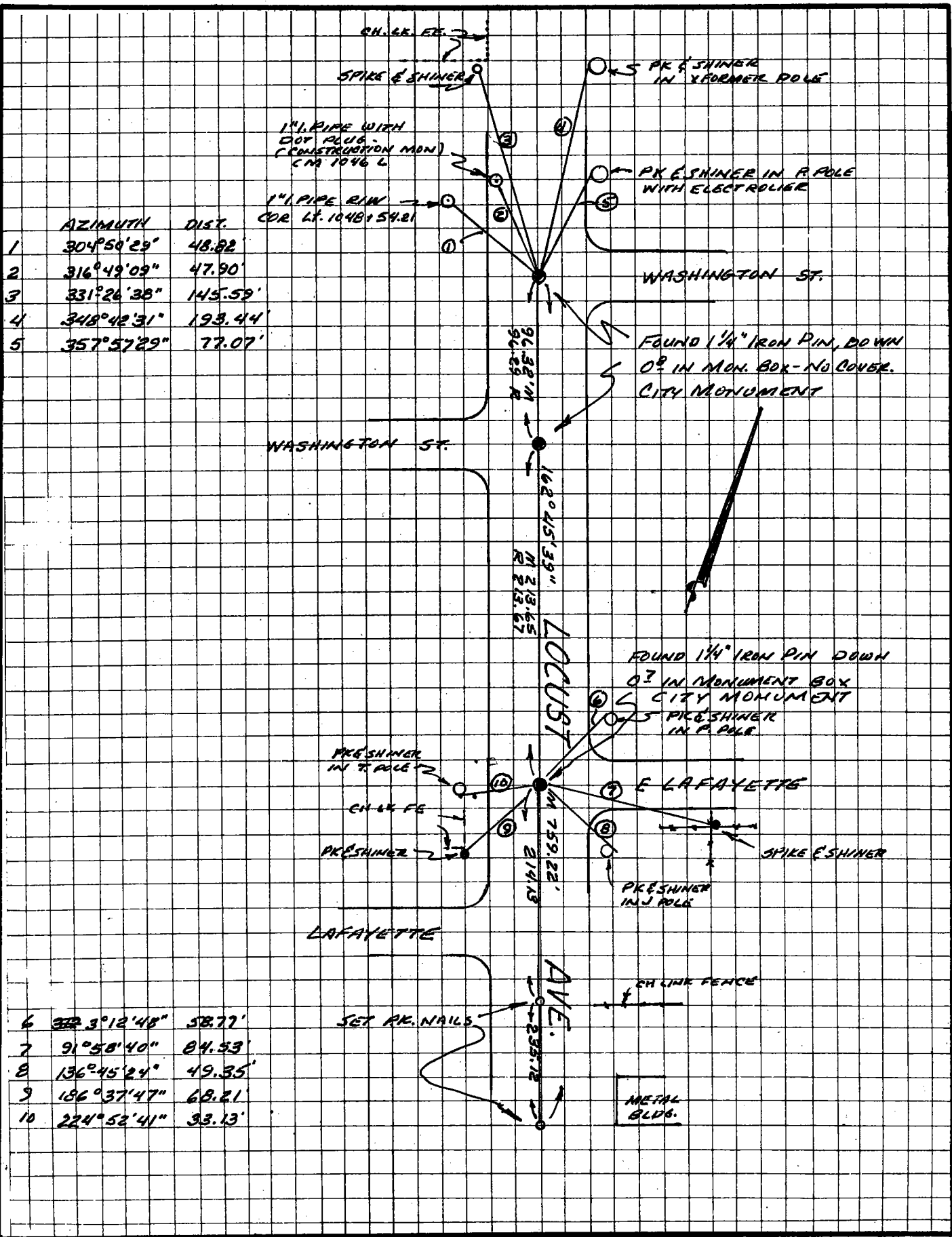

	AZIMUTH	DIST.
1	304°50'29"	48.82
2	316°49'09"	47.90
3	331°26'38"	145.59
4	348°42'31"	193.44
5	357°57'29"	77.07

6	323°12'48"	58.77
7	91°58'40"	84.53
8	136°45'24"	49.35
9	186°37'47"	68.21
10	224°52'41"	33.13