

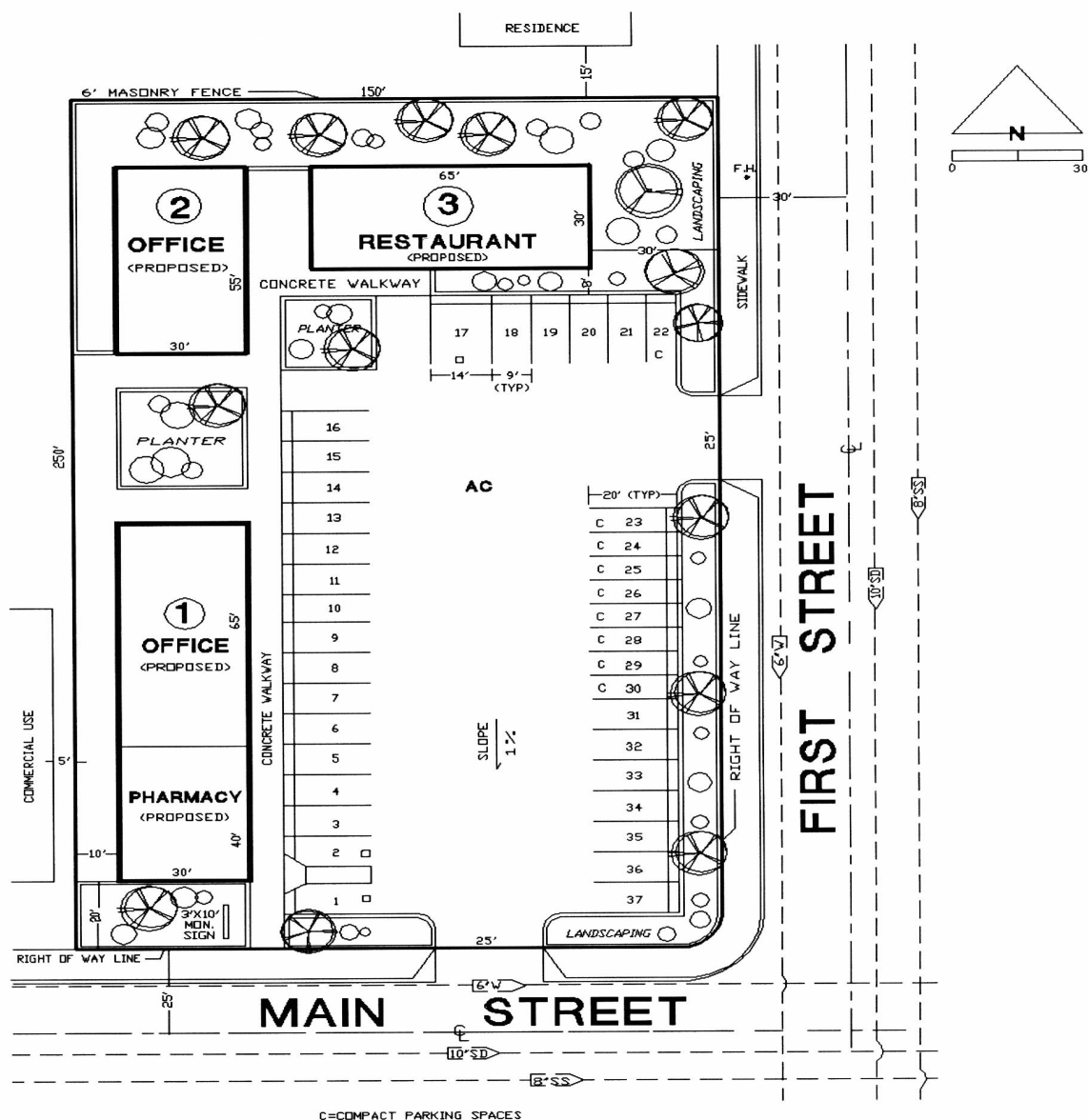

Planning · Building · Code Enforcement · Fire Prevention · GIS



C=COMPACT PARKING SPACES

PROPOSED STRUCTURES - PARKING								
STRUCTURE NUMBER	PROPOSED USE	GFA (<i>sq. ft.</i>)	HIGHEST FLOOR	OVERALL HEIGHT	EMPLOYEES (EST.)	MINIMUM PARKING	PROPOSED PARKING	HANDICAP PARKING
1	OFFICE	1950	1	25'	2	8	8	1
1	PHARMACY	1200	1	25'	2	8	8	1
2	OFFICE	1650	2	35'	6	7	7	
3	RESTAURANT	1950	1	22'	6	14	14	1