

NOTICE OF EXEMPTION

TO: ☒ Office of Planning and Research
CEQAnet Web Portal
<https://ceqasubmit.opr.ca.gov/>

FROM: San Joaquin County
Department of Public Works
1810 East Hazelton Avenue
Stockton, California 95205

☒ County Clerk
County of San Joaquin California
44 North San Joaquin Street, Suite 260
Stockton, California 95202

Project Title: (JOC) Lower Sacramento Road Concrete Repair

Project Location: See attached vicinity map

Description of Nature, Purpose, and Beneficiaries: See attached project description

Public Agency Approving Project: San Joaquin County Public Works Department

Name of Agency Carrying Out Project: San Joaquin County Public Works Department

This is to advise that the San Joaquin County Public Works Department has approved the above described project on 9/22/2025 and has made the determination that the project is exempt due to the following:

Exempt Status (check one):

- ☐ Ministerial (Sec. 21080 (b) (1); 15268)
☐ Declared Emergency (Sec. 21080 (b) (3); 15269(a))
☐ Emergency Project (Sec. 21080 (B) (4); 15269(b) (c))
☒ Categorical Exemption: Existing Facilities (Sec. 15301 (c))
☐ Statutory Exemption (Sec. 15282(l))

Filed Doc #: 39-09302025-285
Tue Sep 30 09:54:42 PDT 2025
Page: 1 of 3 Fee: \$50.00
Steve J. Bestolarides
San Joaquin County Clerk

By Deputy: kmchugh



Reason(s) why project is exempt: The project will repair existing road medians and will not result in any major alterations to the configuration of the road. No additional vehicle travel lanes will be constructed.

Lead Agency Contact Person: Fatima Gutierrez, Assistant Planner, (209) 468-3035

Signature: Fatima Gutierrez Title: Assistant Planner Date: 9/29/2025

(JOC) LOWER SACRAMENTO ROAD CONCRETE REPAIR

Project Description

Project Location:

Location #1: 1,520 feet North of Mettler Road; Location #2: 1,700 feet South of Harney Lane at Extension Road. **See attached Vicinity Map.**

Project Justification:

This project will repair/modify concrete within the Lower Sacramento Bike Lane Safety project limits, so that it will not interfere with bike lane striping taking place next spring.

Scope of Work:

The project will consist of:

1. Removing and replacing two large PCC panels in the median that have heaved up over time at Location #1.
2. Modifying pork chop island at Extension Road to accommodate future bike lane at Location #2.

Environmental Setting:

In these portions of the San Joaquin County, land usage is primarily rural with single family homes.

There are many large trees adjacent to the project area. Nesting and migratory birds, protected by the Migratory Bird Treaty Act, may nest within these trees. Furthermore, the Swainson's Hawk, a raptor species of concern within the State of California and listed as threatened may nest adjacent to or within the project area. A pre-construction survey for nesting Swainson's Hawks and other migratory birds is recommended if construction is scheduled to occur from February 15th to September 1st.

Beneficiaries:

The public will see increased safety and fewer hazards with this well-maintained concrete. Overall, there will be reduced maintenance concerns and more reliability within the project area.

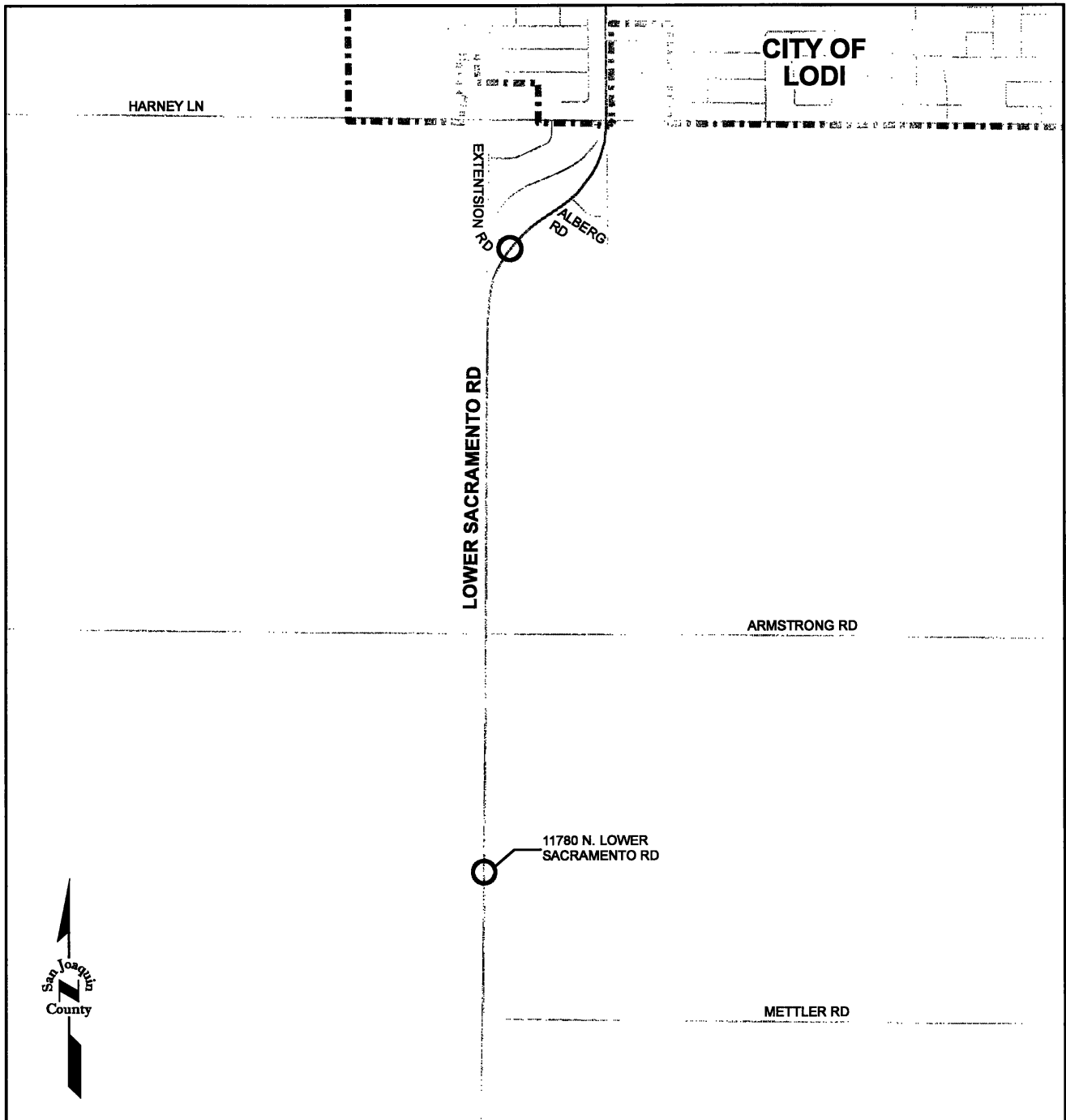

○ PROJECT LOCATION

NO SCALE

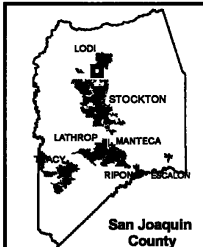

Lower Sacramento Road Concrete Repair

(1,700' S/O Harney Ln)

(1,520' N/O Mettler Rd)

-- Vicinity Map --

SAN JOAQUIN COUNTY

Department of Public Works, 1810 E. Hazelton Ave., Stockton, CA 95205

The County of San Joaquin does not warrant the accuracy, completeness, or suitability for any particular purpose.

The Information on this map is not intended to replace engineering, financial or primary records research.

