

**4124 E. Cherokee Rd  
Stockton CA  
APN: 087-100-70**



EXISTING GENERAL PLAN: GENERAL COMMERCIAL (C/G)

EXISTING ZONING: GENERAL COMMERCIAL (C-G)

*2720 N Wilcox Rd.  
Stockton CA  
APN: 087-100-76*

*2950 N Wilcox Rd.  
Stockton CA  
APN: 087-100-77*

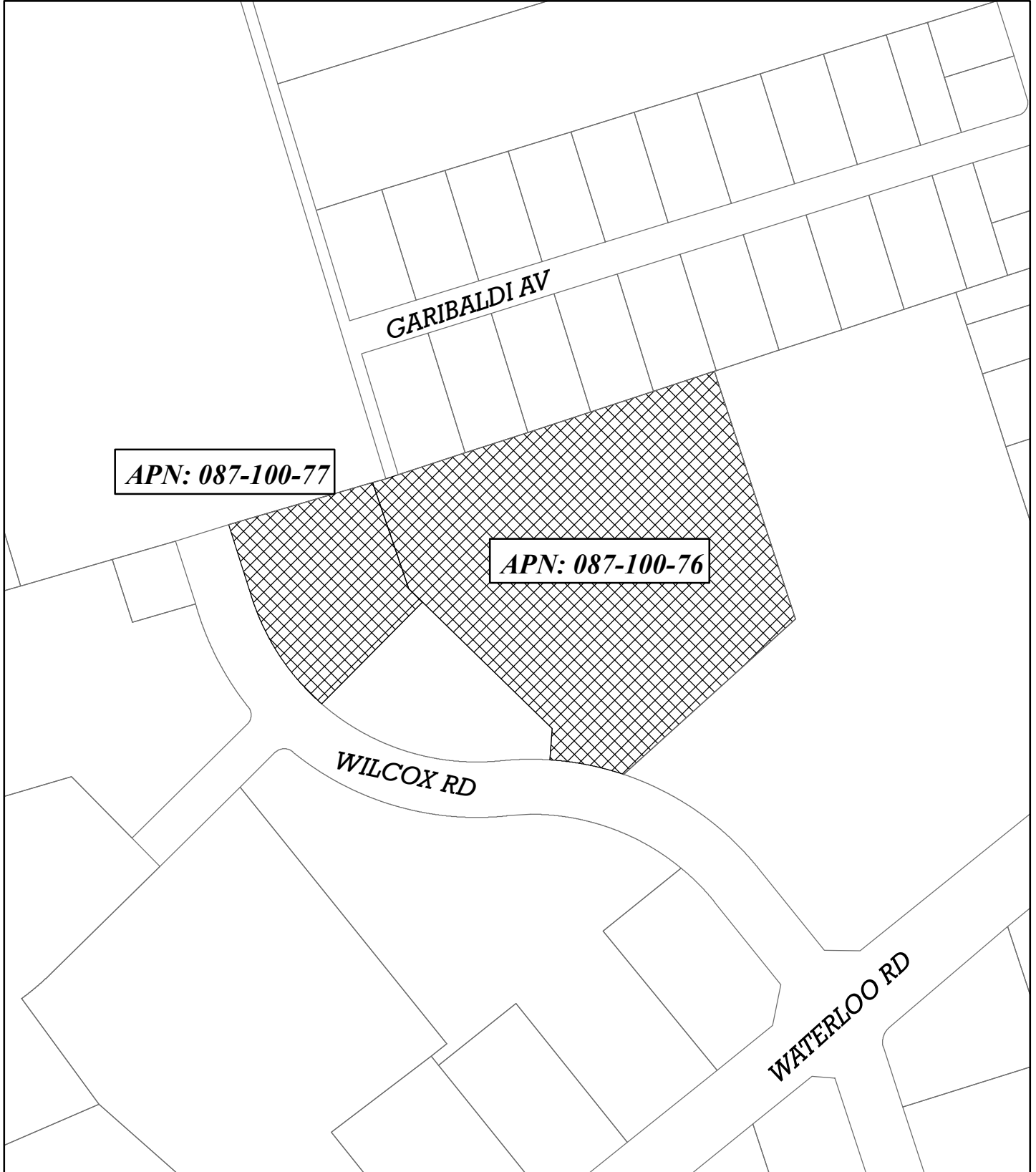

EXISTING GENERAL PLAN: GENERAL COMMERCIAL (C/G)

EXISTING ZONING: GENERAL COMMERCIAL (C-G)

*Stockton CA*  
*APN: 130-030-13*

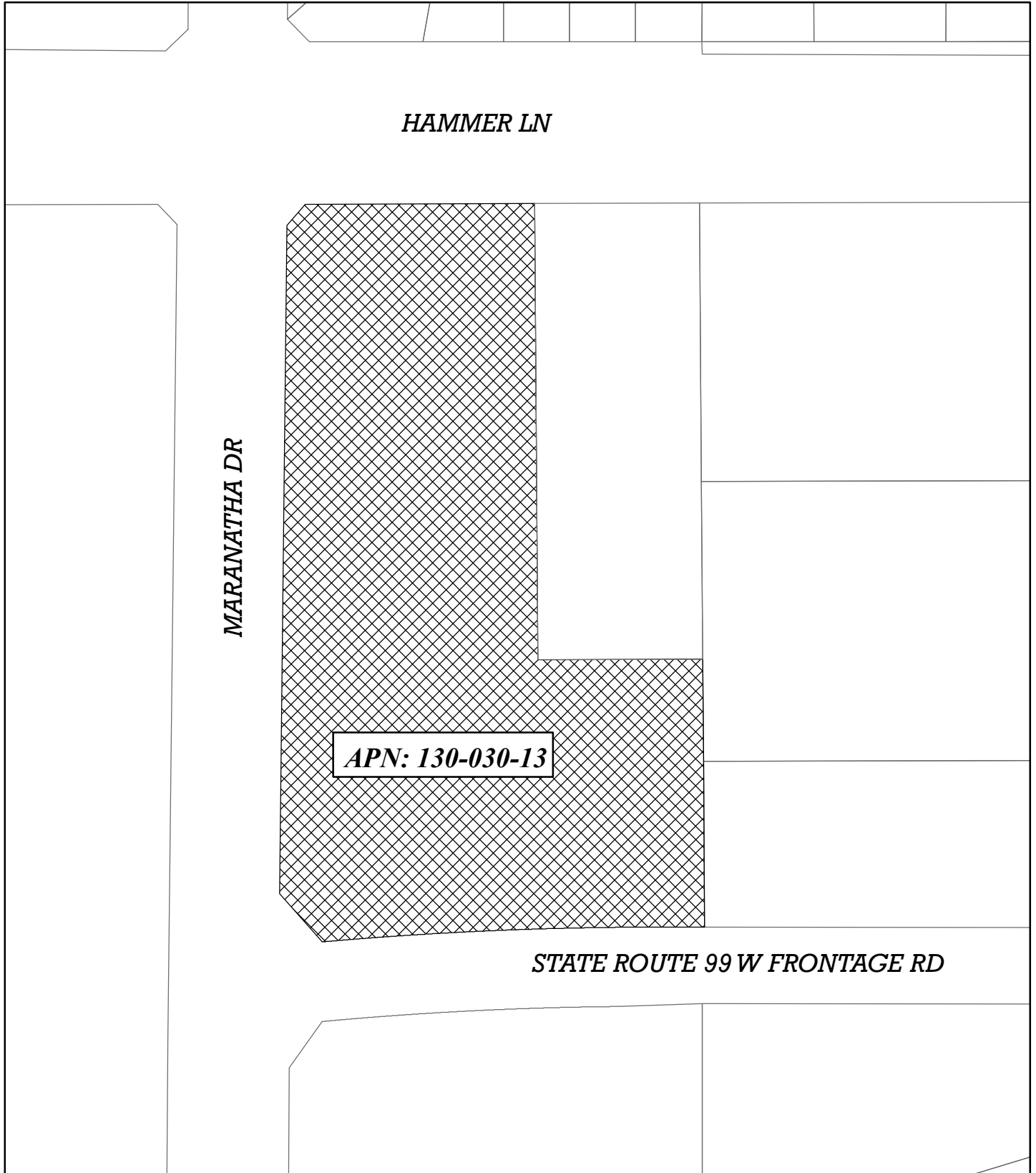

EXISTING GENERAL PLAN: GENERAL COMMERCIAL (C/G)

EXISTING ZONING: GENERAL COMMERCIAL (C-G)

**4035 N Wilson Wy.  
Stockton CA  
APN: 132-020-09**

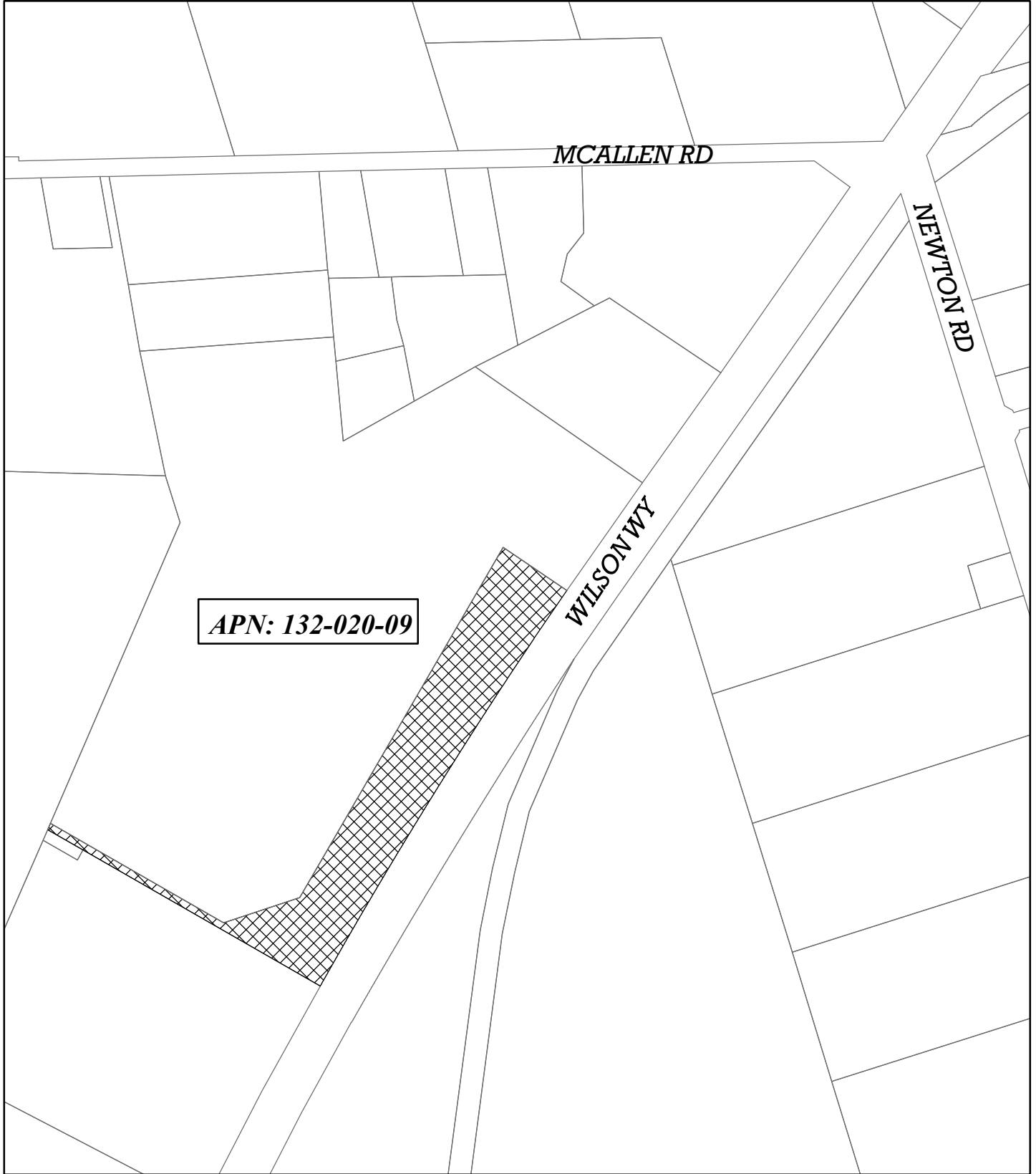

EXISTING GENERAL PLAN: GENERAL COMMERCIAL (C/G)  
EXISTING ZONING: GENERAL COMMERCIAL (C-G)

4283 N Wilson Wy.  
Stockton CA  
APN: 132-020-21

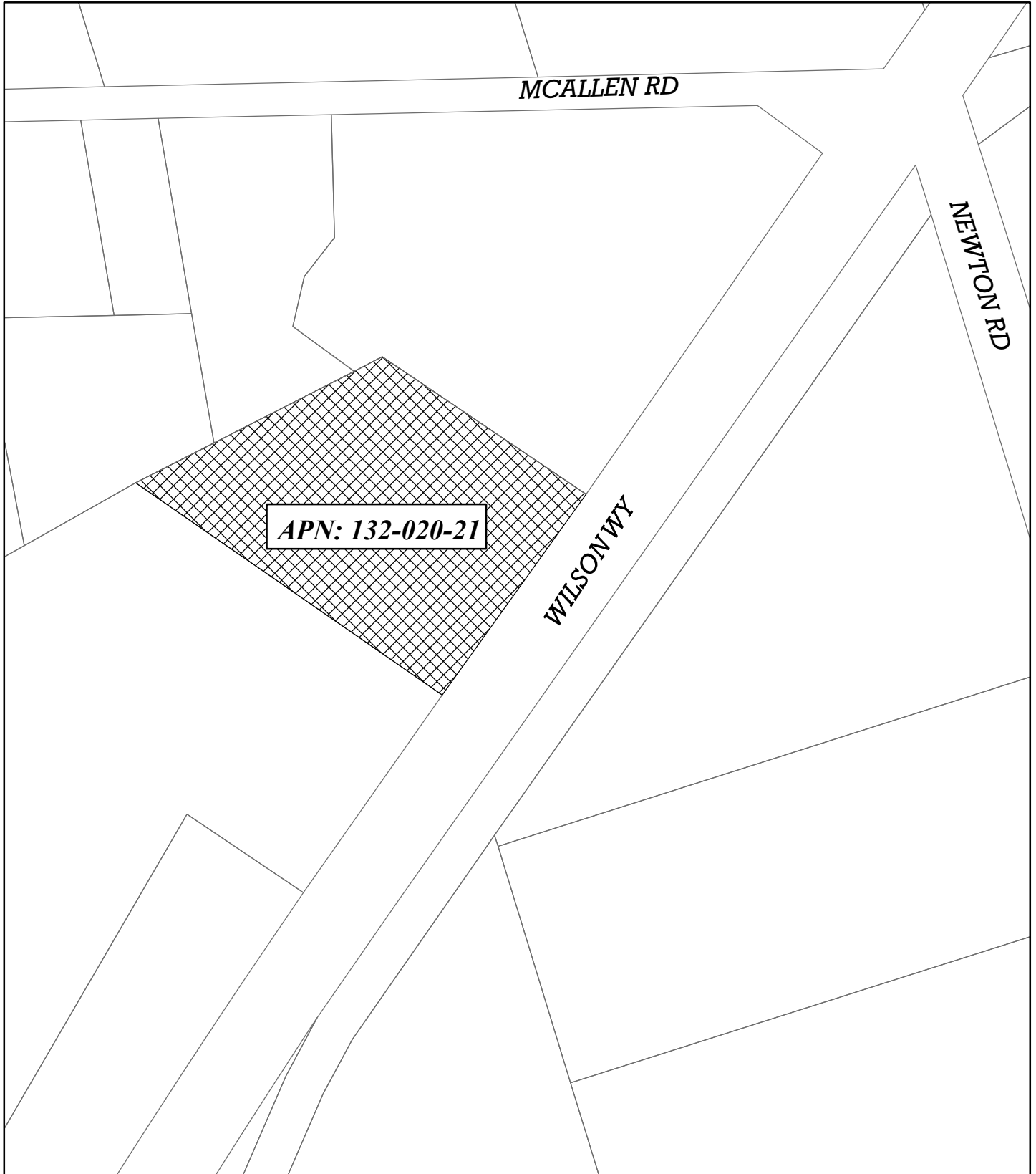

EXISTING GENERAL PLAN: GENERAL COMMERCIAL (C/G)

EXISTING ZONING: GENERAL COMMERCIAL (C-G)

*4343 N Wilson Wy.  
Stockton CA  
APN: 132-020-22*

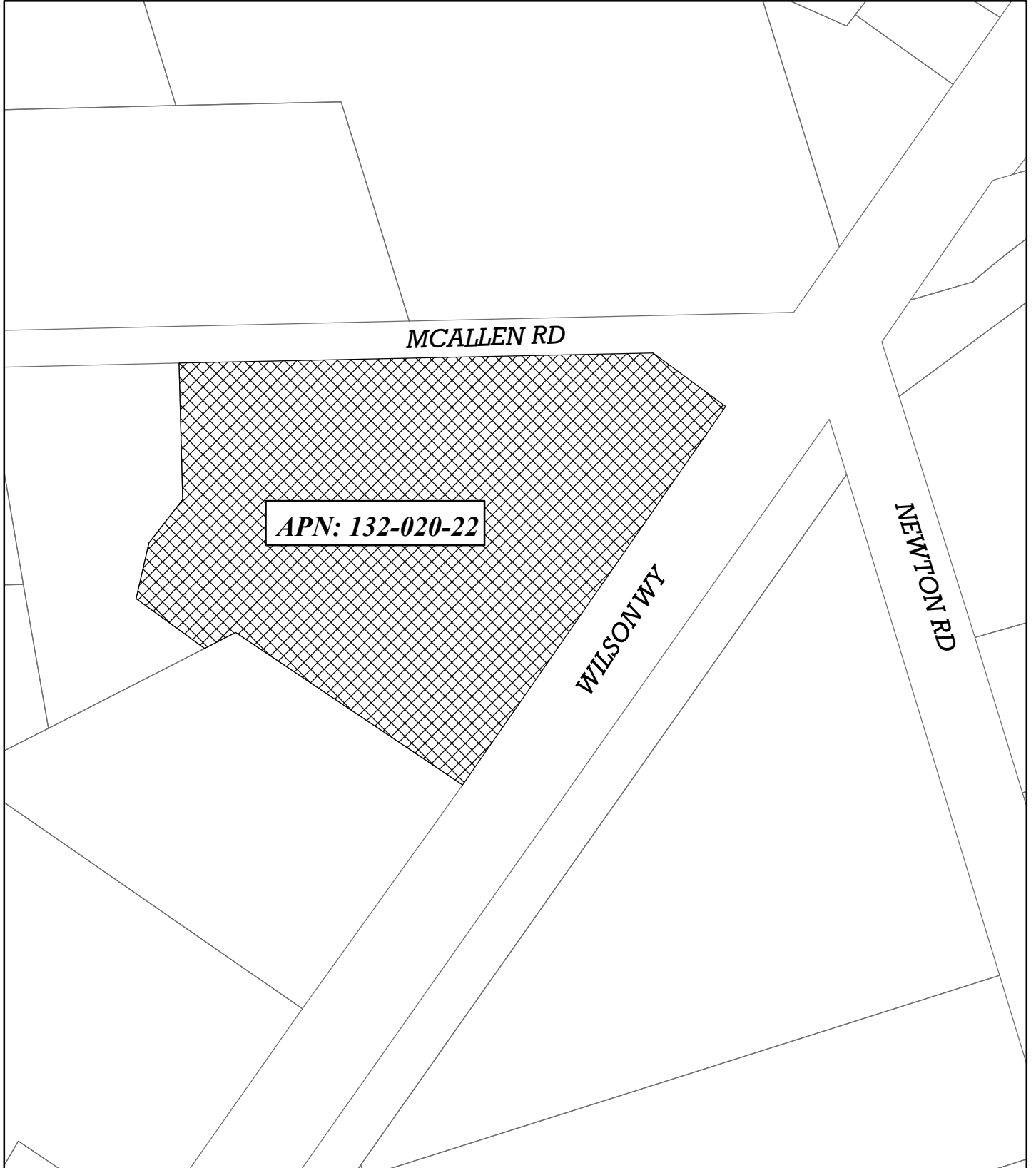

EXISTING GENERAL PLAN: GENERAL COMMERCIAL (C/G)

EXISTING ZONING: GENERAL COMMERCIAL (C-G)

**3131 E. Fremont St.  
Stockton CA  
APN: 143-220-14**

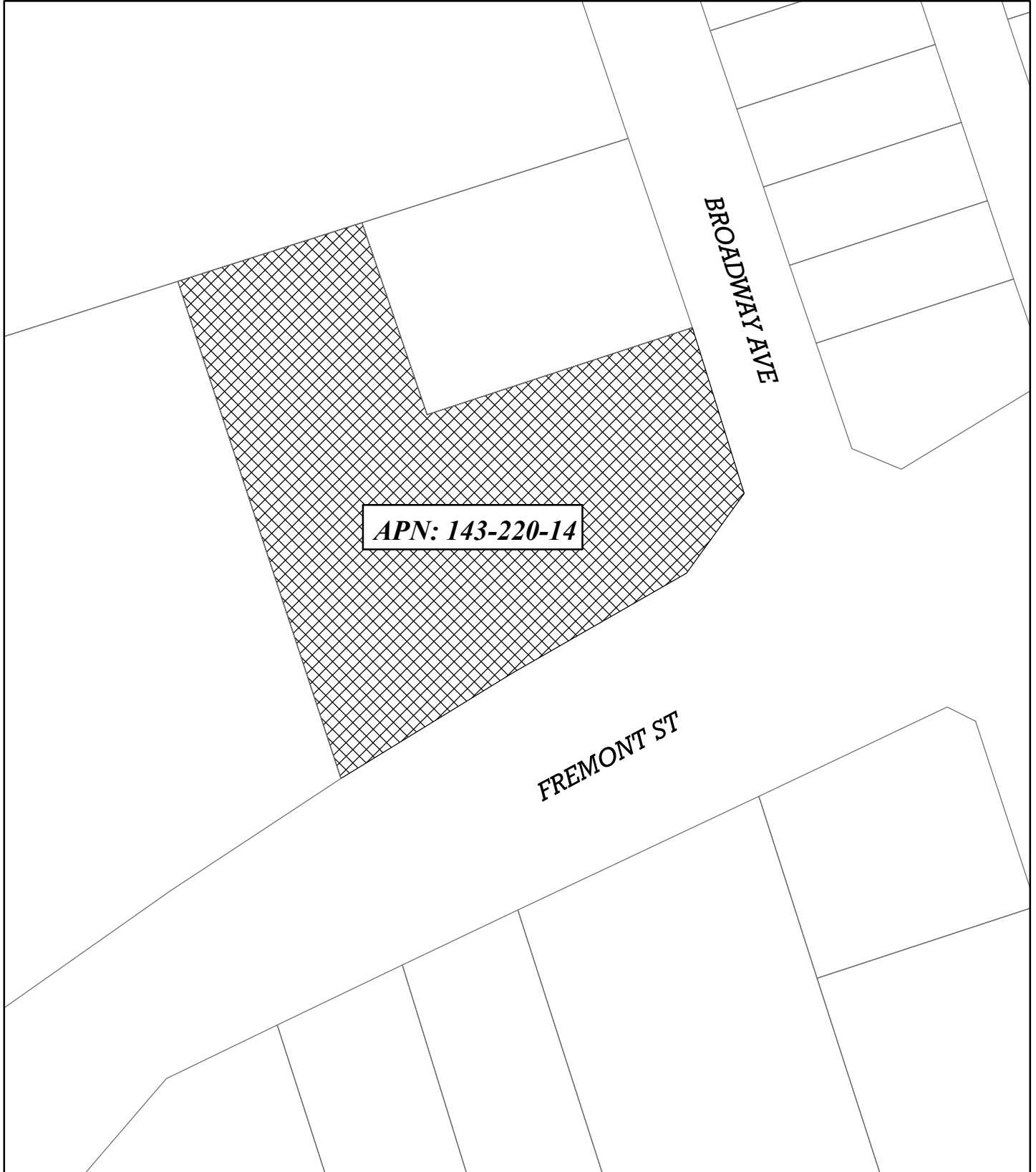

EXISTING GENERAL PLAN: GENERAL COMMERCIAL (C/G)

EXISTING ZONING: GENERAL COMMERCIAL (C-G)

**628 N. Windsor Ave.  
Stockton CA  
APN: 143-400-38**

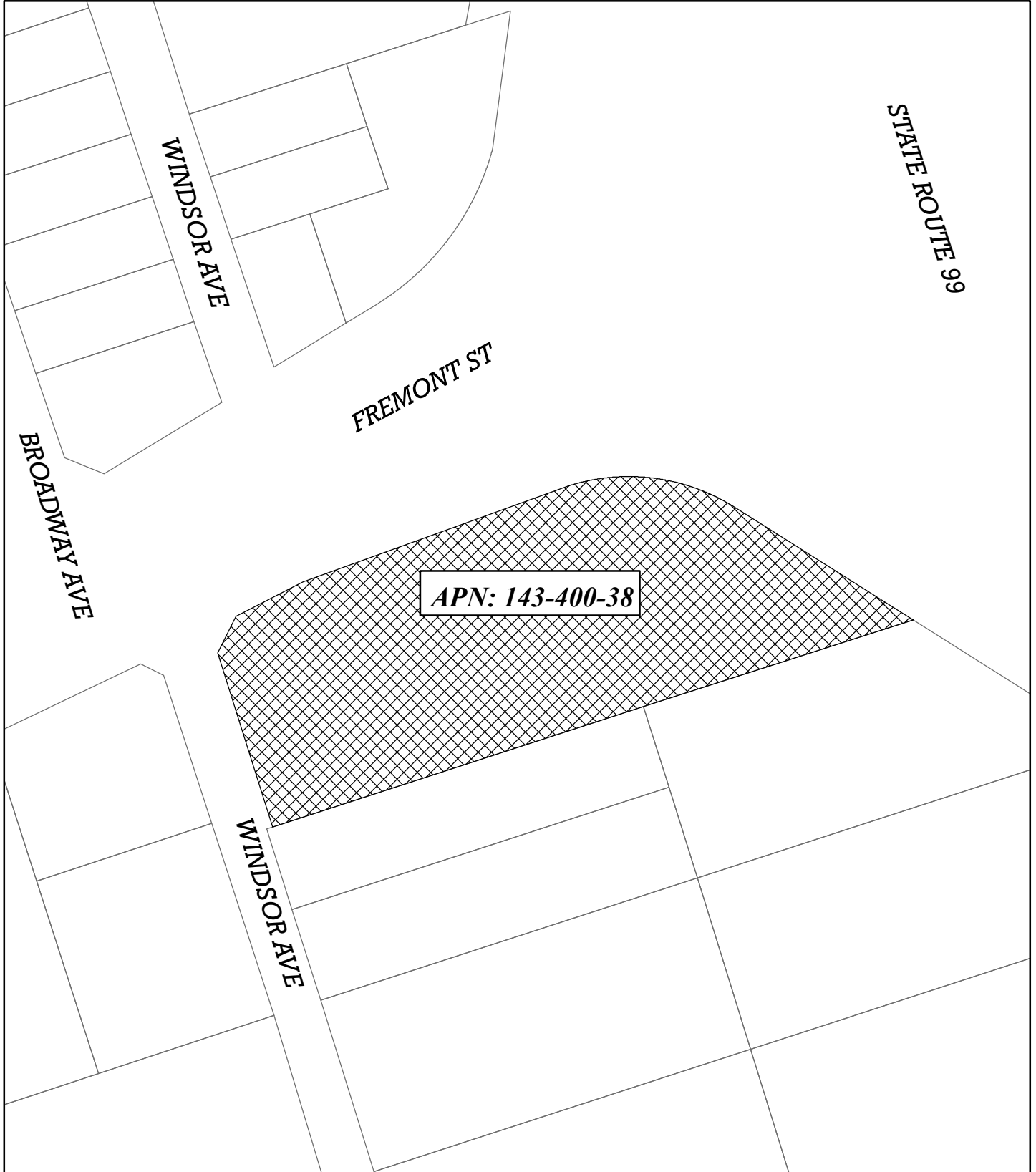

EXISTING GENERAL PLAN: GENERAL COMMERCIAL (C/G)

EXISTING ZONING: GENERAL COMMERCIAL (C-G)



**457 N. Shasta Ave.  
Stockton CA  
APN: 143-430-59**

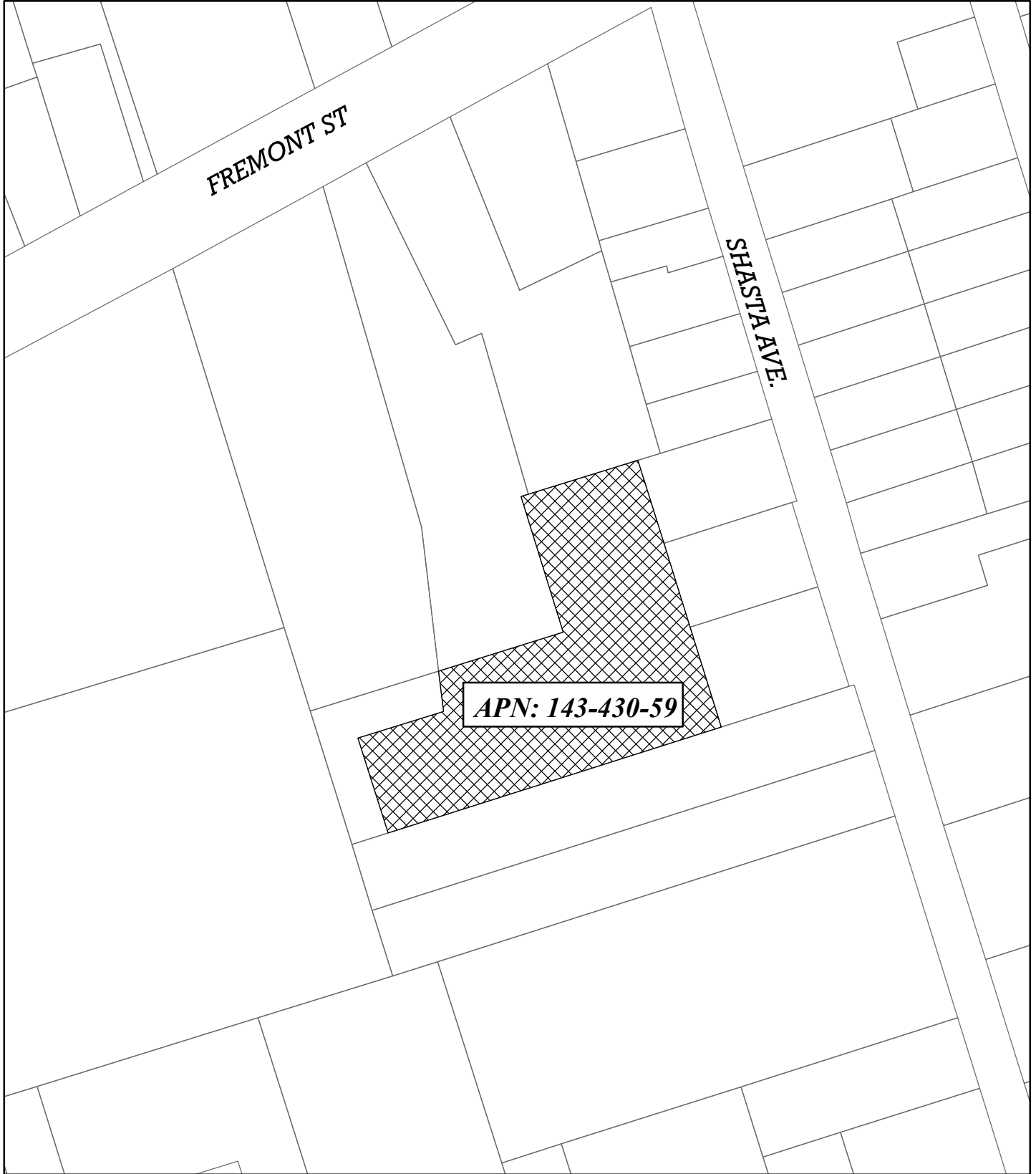

EXISTING GENERAL PLAN: GENERAL COMMERCIAL (C/G)

EXISTING ZONING: GENERAL COMMERCIAL (C-G)

**6076 S. El Dorado St.  
Stockton CA  
APN: 193-020-02**

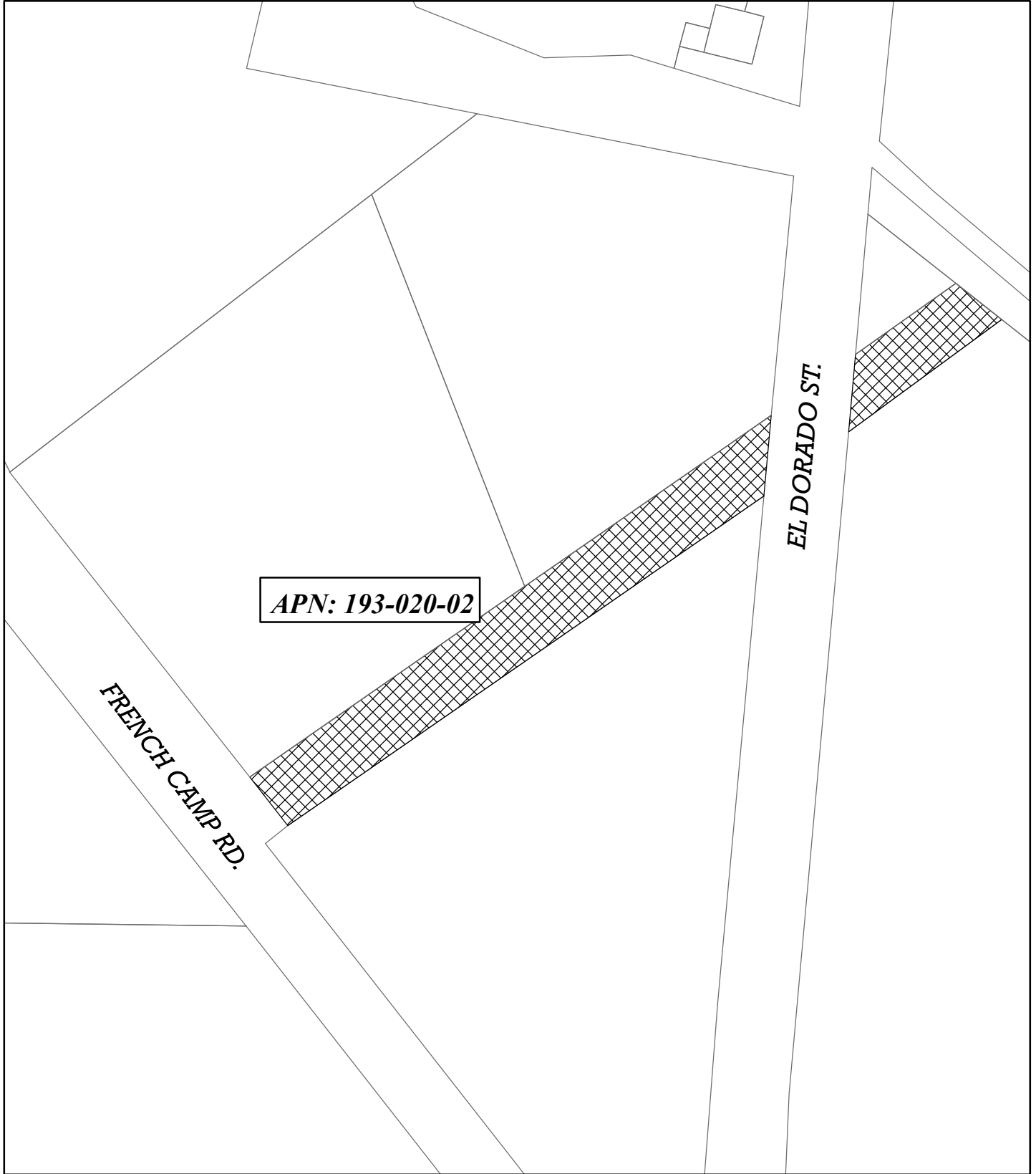

EXISTING GENERAL PLAN:	GENERAL COMMERCIAL (C/G)
	LIMITED INDUSTRIAL (I/L)
EXISTING ZONING:	GENERAL COMMERCIAL (C-G)

**6001 S. El Dorado St.  
Stockton CA  
APN: 193-020-17**



EXISTING GENERAL PLAN: GENERAL COMMERCIAL (C/G)

EXISTING ZONING: GENERAL COMMERCIAL (C-G)

5543 S. El Dorado St.  
Stockton CA  
APN: 193-020-31

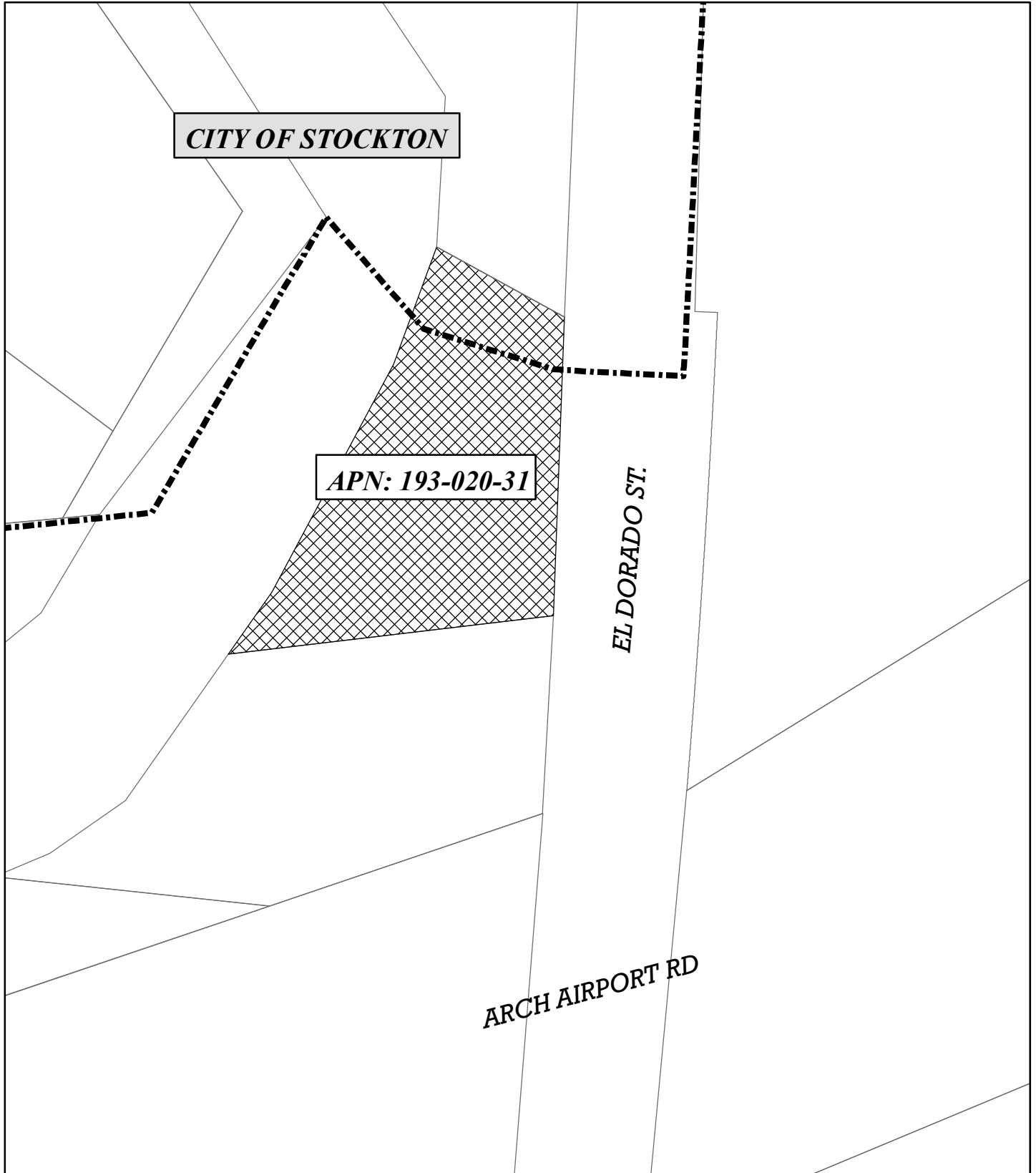

EXISTING GENERAL PLAN:	GENERAL COMMERCIAL (C/G) RESOURCE CONSERVATION (OS/RC)
EXISTING ZONING:	CITY OF STOCKTON GENERAL COMMERCIAL (C-G) CITY OF STOCKTON

**6006 S. French Camp Rd.  
Stockton CA  
APN: 193-020-49**

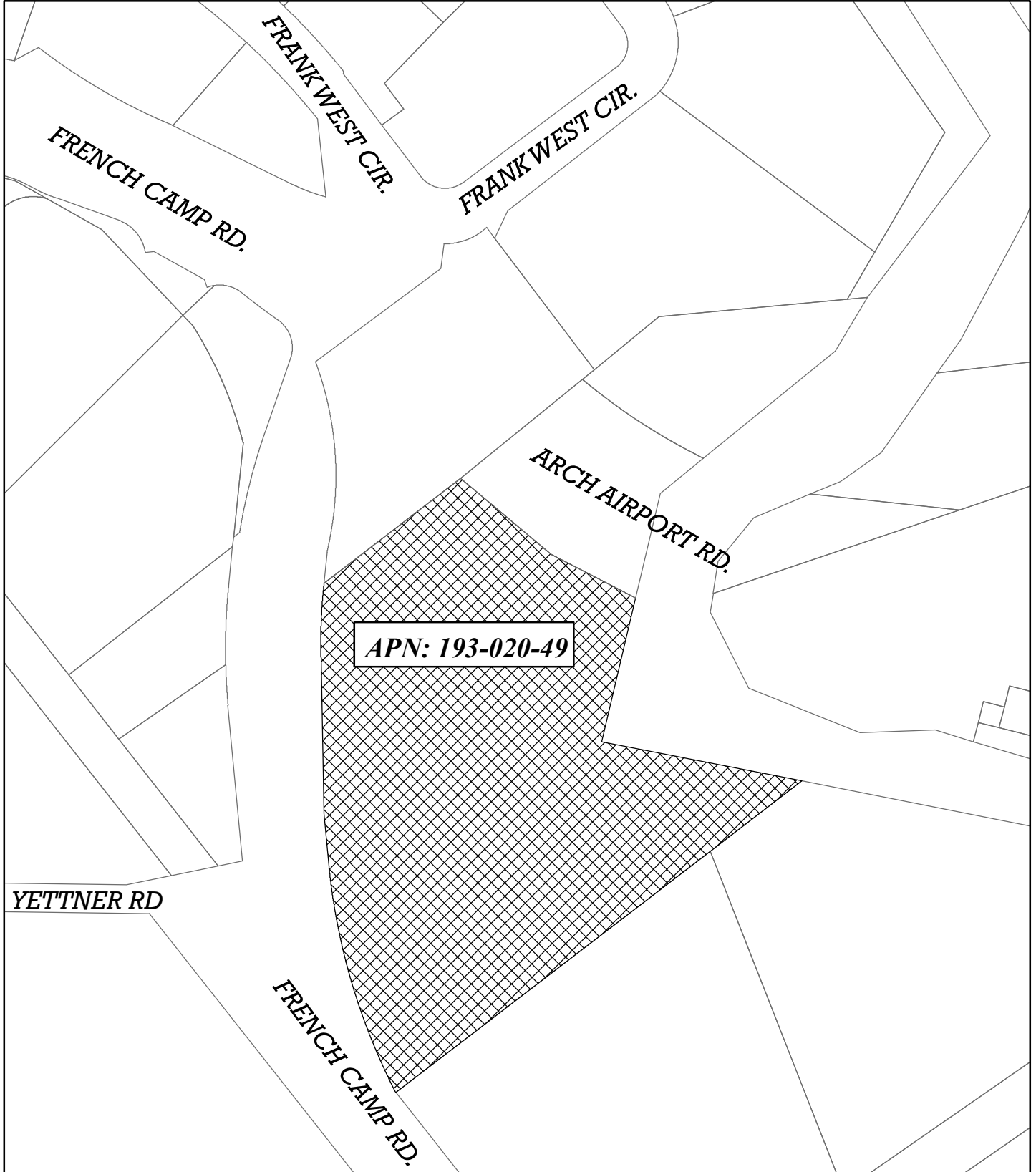

EXISTING GENERAL PLAN: GENERAL COMMERCIAL (C/G)

EXISTING ZONING: GENERAL COMMERCIAL (C-G)

*Stockton CA*  
*APN: 193-020-52*

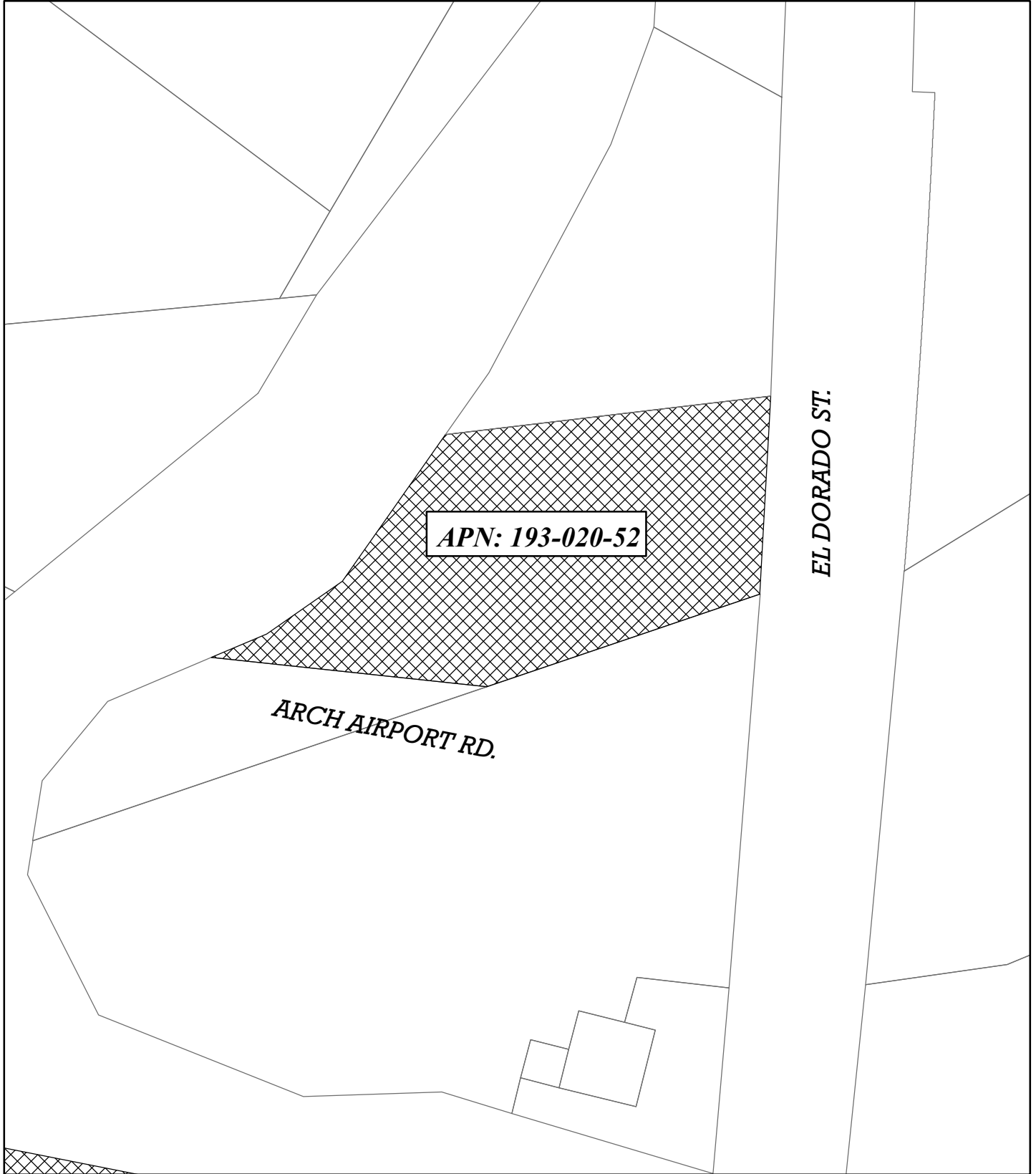

EXISTING GENERAL PLAN: GENERAL COMMERCIAL (C/G)

EXISTING ZONING: GENERAL COMMERCIAL (C-G)

**6344 S. French Camp Rd.  
Stockton CA  
APN: 193-020-56**

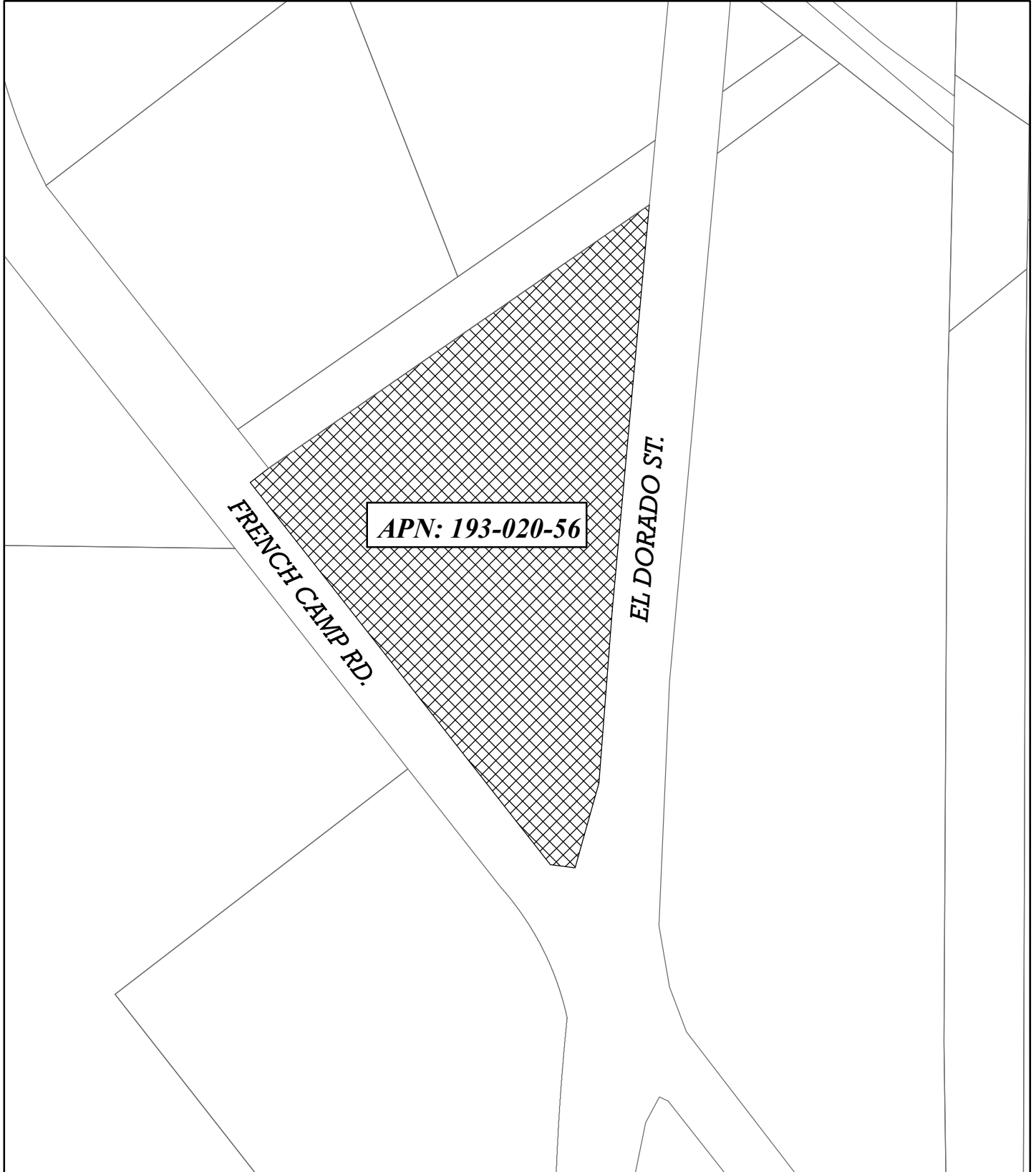

EXISTING GENERAL PLAN: GENERAL COMMERCIAL (C/G)

EXISTING ZONING: GENERAL COMMERCIAL (C-G)

**7400 S. Delivery Dr.  
Stockton CA  
APN: 193-050-18**

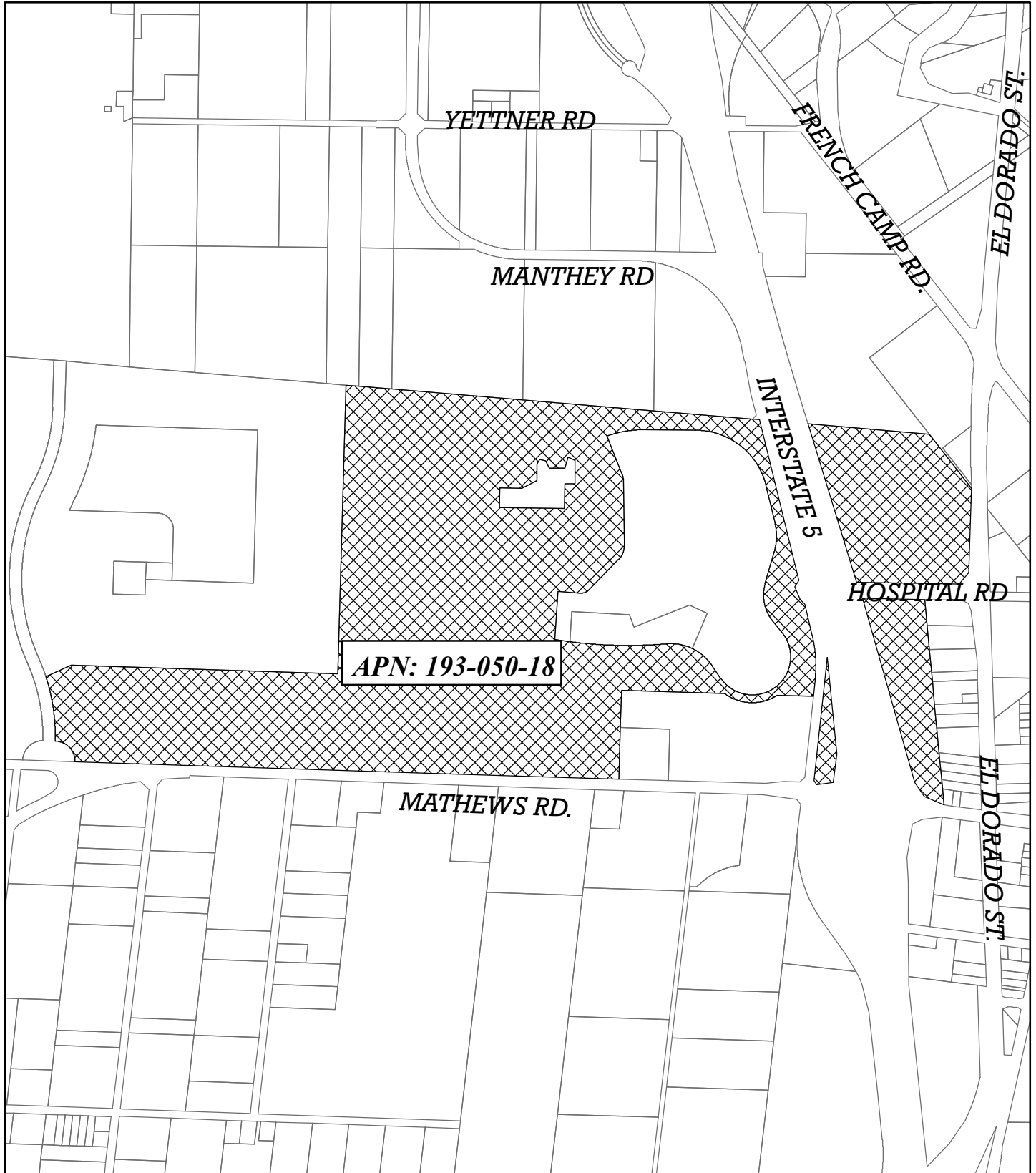

EXISTING GENERAL PLAN: GENERAL COMMERCIAL (C/G)

EXISTING ZONING: GENERAL COMMERCIAL (C-G)



*252 W. Yettner Rd.  
Stockton CA  
APN: 193-060-51*

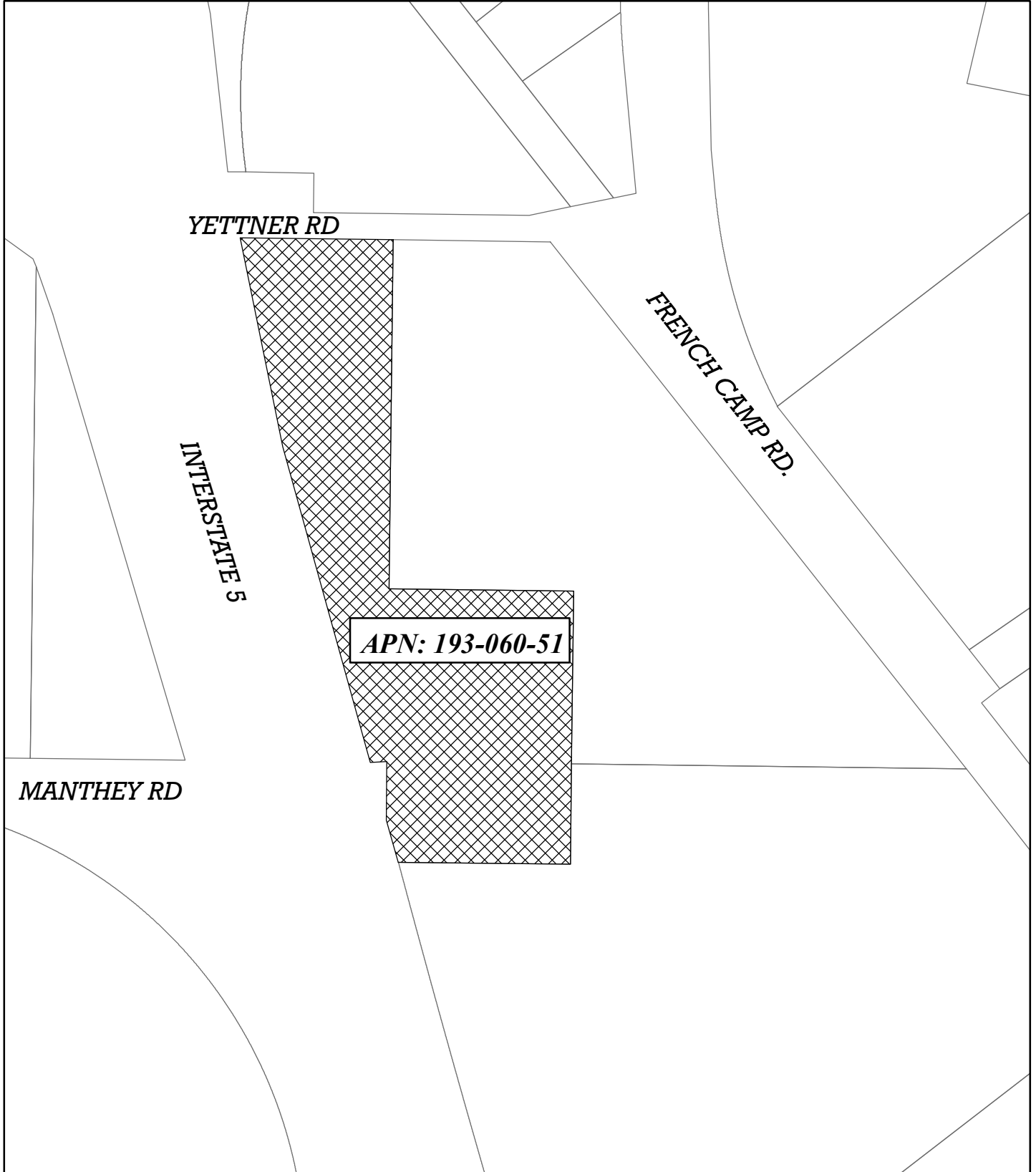

EXISTING GENERAL PLAN: GENERAL COMMERCIAL (C/G)

EXISTING ZONING: GENERAL COMMERCIAL (C-G)

**6785 S. El Dorado St.  
Stockton CA  
APN: 193-070-11**

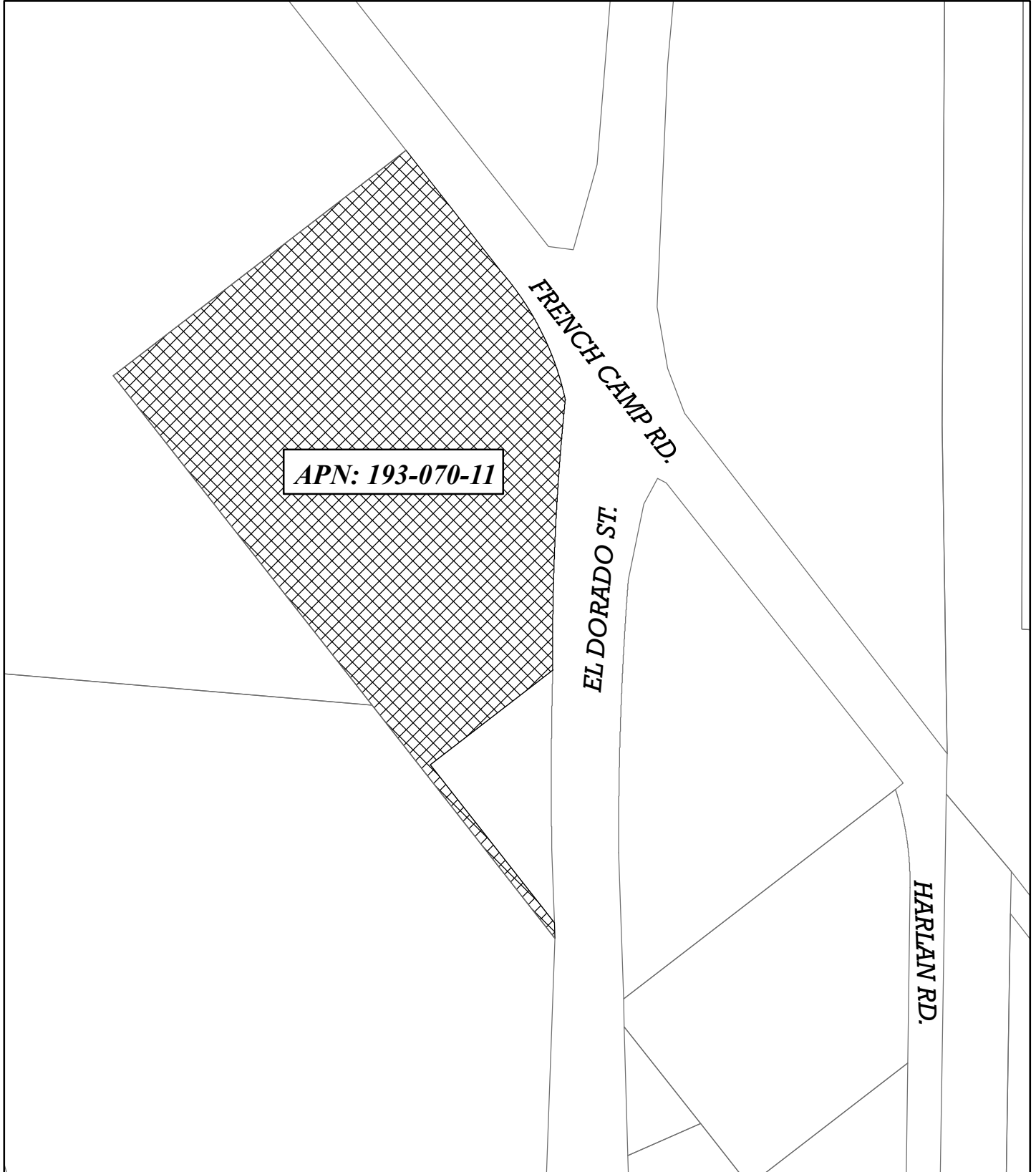

EXISTING GENERAL PLAN: GENERAL COMMERCIAL (C/G)

EXISTING ZONING: GENERAL COMMERCIAL (C-G)

**7070 S. Harlan Rd.  
Stockton CA  
APN: 193-090-01**

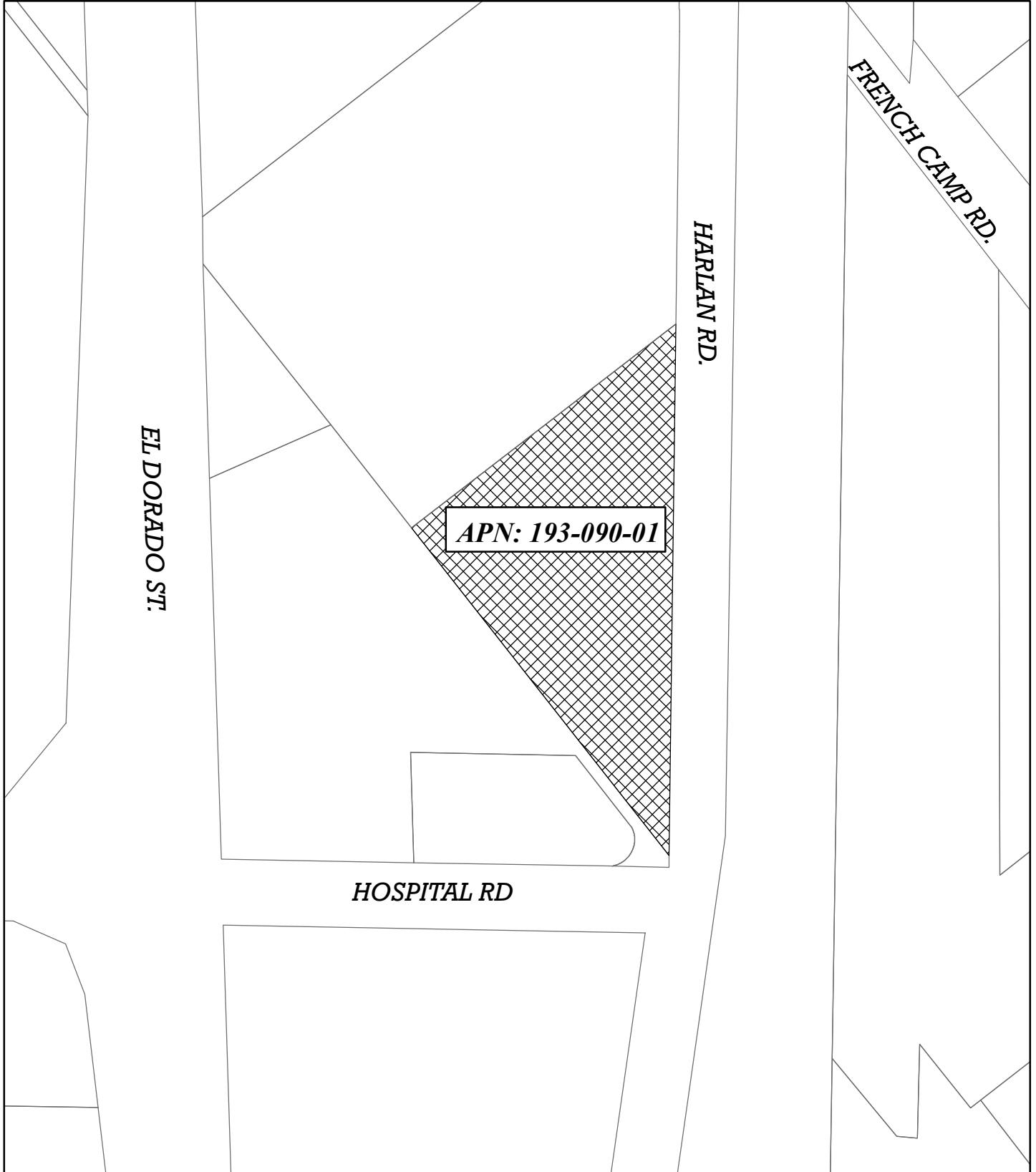

EXISTING GENERAL PLAN: GENERAL COMMERCIAL (C/G)

EXISTING ZONING: GENERAL COMMERCIAL (C-G)

**7400 S. El Dorado St.  
Stockton CA  
APN: 193-160-50**

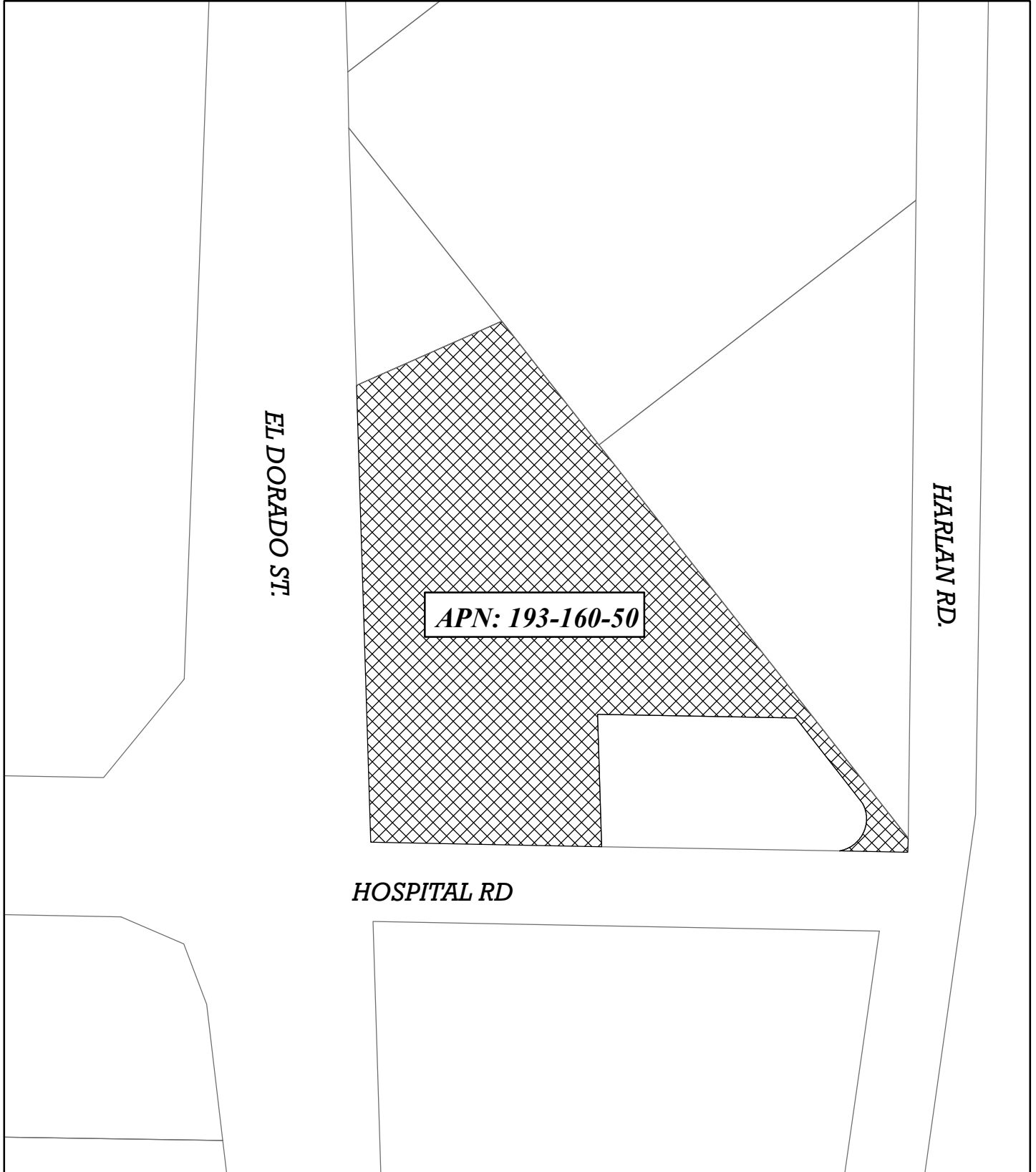

EXISTING GENERAL PLAN: GENERAL COMMERCIAL (C/G)

EXISTING ZONING: GENERAL COMMERCIAL (C-G)

**8125 S. El Dorado St.  
Stockton CA  
APN: 193-170-03**



EXISTING GENERAL PLAN: GENERAL COMMERCIAL (C/G)

EXISTING ZONING: GENERAL COMMERCIAL (C-G)

*42 W. Mathews Rd.  
Stockton CA  
APN: 193-170-36*

*Stockton CA  
APN: 193-170-41*



EXISTING GENERAL PLAN: GENERAL COMMERCIAL (C/G)

EXISTING ZONING: GENERAL COMMERCIAL (C-G)

**6006 E. Lathrop Rd.  
Manteca, CA  
APN: 218-020-20**

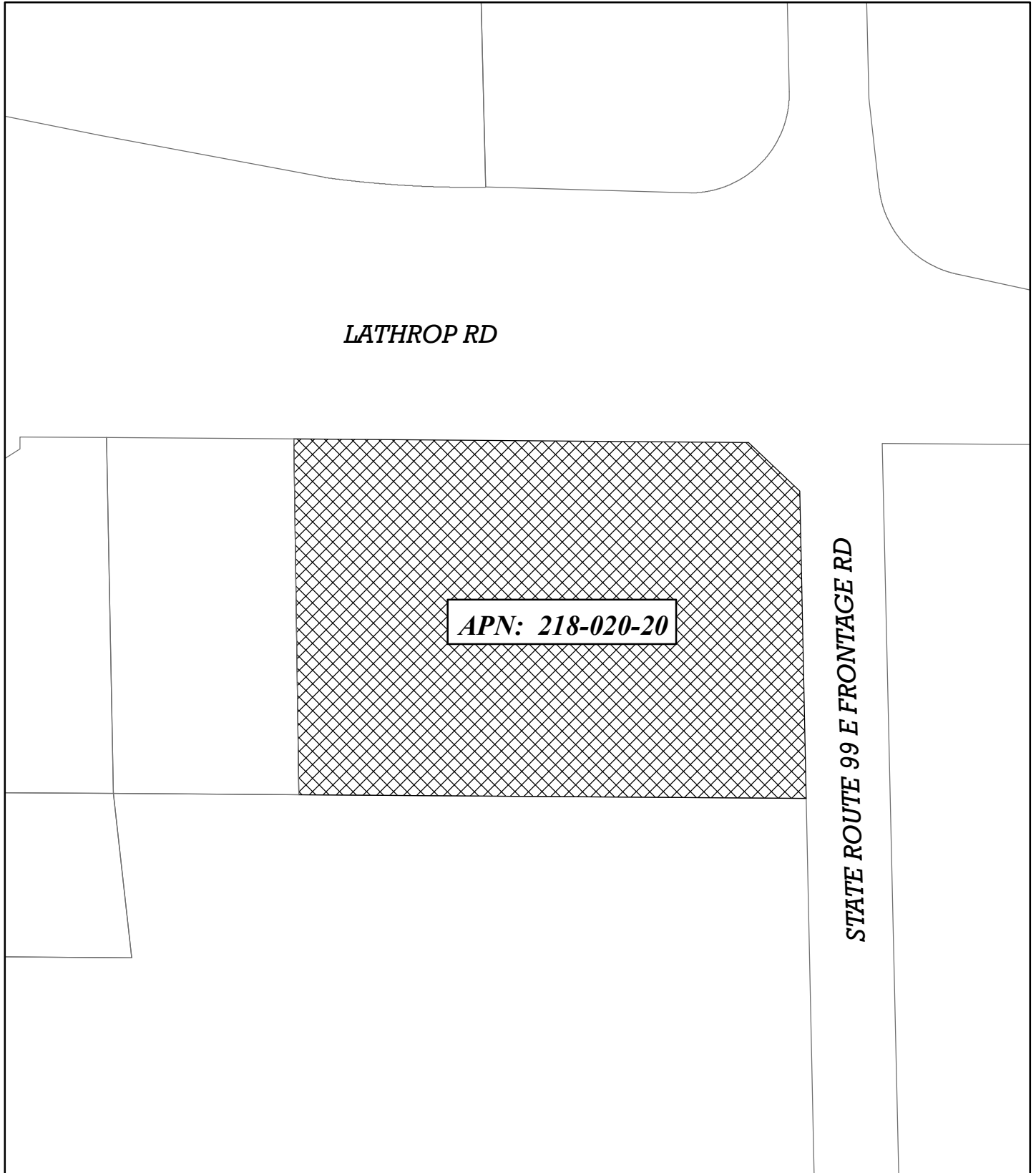

EXISTING GENERAL PLAN: GENERAL COMMERCIAL (C/G)

EXISTING ZONING: GENERAL COMMERCIAL (C-G)

**20504 S. State Route 99 W. Frontage Rd.  
Manteca, CA  
APN: 228-060-17**

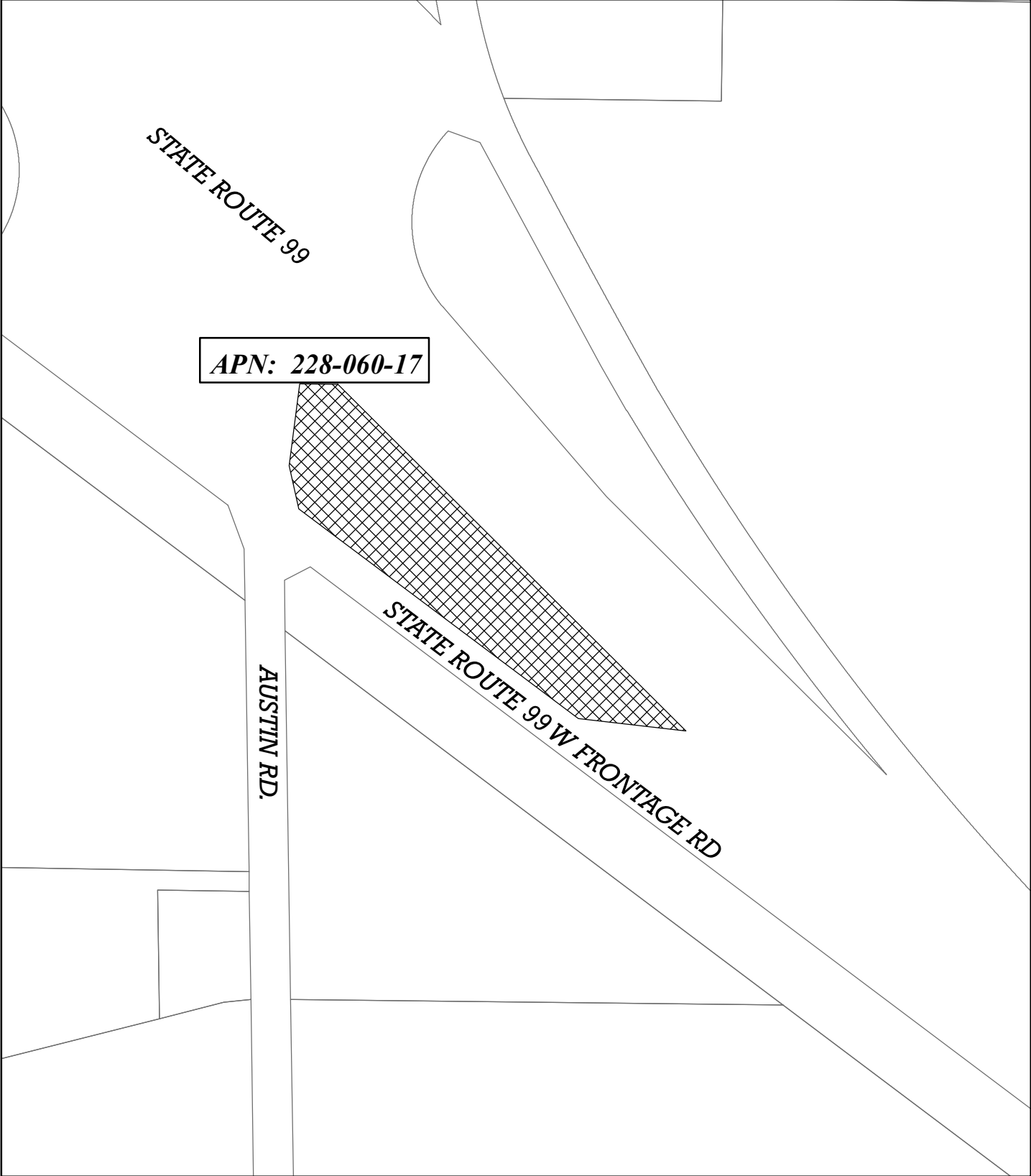

EXISTING GENERAL PLAN: GENERAL COMMERCIAL (C/G)  
EXISTING ZONING: GENERAL COMMERCIAL (C-G)