



**SAN JOAQUIN**  
— COUNTY —  
*Greatness grows here.*



## **WILDWOOD ROAD BRIDGE REPLACEMENT ACROSS TEMPLE CREEK**

### **News Release**

June 27, 2017

On Monday, July 10th, San Joaquin County Public Works (County) will begin construction on the Wildwood Road Bridge Replacement project (Project), which was awarded to Steelhead Constructors. The Project is located on Wildwood Road halfway between Jack Tone Road and Murphy Road, north of Escalon. The Project, in general, will consist of replacing the existing bridge at Temple Creek with a new structure and reconstructing/widening the roadway approaches approximately 500 feet on each side of the new bridge.

The bridge will be closed to all traffic during the construction period, which will run from July 10<sup>th</sup> thru late November. Hours of work will generally be between 7:00 AM and 5:00 PM, Monday thru Friday. Motorists will be redirected around the project site via Mariposa Road and Lone Tree Road as indicated in the detour map below. Wildwood Road will remain accessible outside of the Project limits (approximately 500 feet to the west and east of the bridge).

**A Pre-Construction Public Informational Meeting will be held on June 29<sup>th</sup> from 6:00 – 7:00 PM at the northeast corner (concrete pad) of the bridge. Representatives from the County and its construction team will be available to provide construction-related information and answer questions regarding the project.**

Should you need any assistance or have any questions regarding this Project, please contact the San Joaquin County Department of Public Works Field Engineering Division at the contact information below.

Awni Taha  
Acting Construction Manager  
Office: (209) 953-7619  
Email: ataha@sjgov.org

Michael Chung  
Resident Engineer  
Office: (209) 468-3586  
Email: mchung@sjgov.org

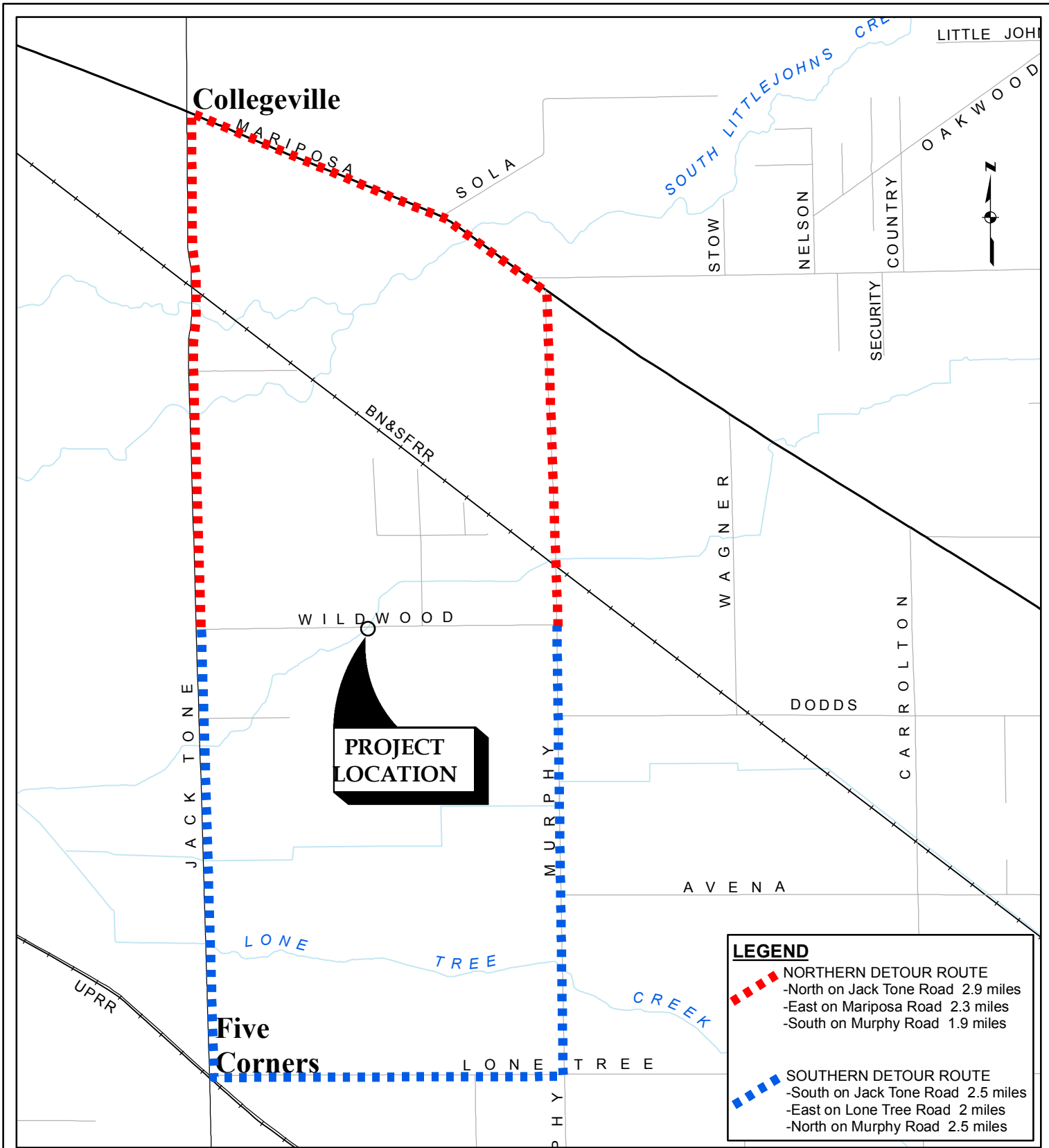

1" = 3,932.2'



**-DETOUR MAP-**  
Wildwood Road Bridge Replacement Across Temple Creek

**SAN JOAQUIN COUNTY**  
 Department of Public Works, 1810 E. Hazelton Ave., Stockton, CA 95205  
 The County of San Joaquin does not warrant the accuracy, completeness, or suitability for any particular purpose.  
 The Information on this map is not intended to replace engineering, financial or primary records research.

