

CORNER RECORD

Document Number CR-17-13
 County of San Joaquin, California

City of Stockton

Brief Legal Description Projection of East lot line of Lot 4, 20 M.P. 25 at the South end thereof.

CORNER TYPE		COORDINATES(Optional)	
<input type="checkbox"/>	Government Corner	<input type="checkbox"/>	Control
<input type="checkbox"/>	Meander	<input type="checkbox"/>	Property
<input type="checkbox"/>	Rancho	<input type="checkbox"/>	Other
Date of Survey <u>November 29, 2016</u>		N. _____	
		E. _____	
		Zone _____ NAD27 <input type="checkbox"/> NAD83 <input type="checkbox"/>	
		NAD83 Epoch _____	
		Elev. _____	
		Vert. Datum: NGVD29 <input type="checkbox"/> NADV88 <input type="checkbox"/>	
		Meas. Units: Metric <input type="checkbox"/> Imperial <input checked="" type="checkbox"/>	

Corner - Left as found Found and tagged Established Reestablished Rebuilt

Identification and type of corner found: Evidence used to identify or procedure used to establish or reestablish the corner:
The East lot line of Lot 4 was established based on found centerline monuments and record data per
20 M.P. 25.

A description of the physical condition of the monument as found and as set or reset: Set 1" brass disc stamped "LS 6947" in
concrete sidewalk at five foot projection of lot line.

SURVEYOR'S STATEMENT

This Corner Record was prepared by me or under my direction in conformance with
 the Land Surveyor's Act on December 2, 2016.
 Signed [Signature] P.L.S. or R.C.E. No.: L.S. 6947



COUNTY SURVEYOR'S STATEMENT

This Corner Record was received December 8, 2016 and examined
 and filed January 10, 2017.
 Signed [Signature] P.L.S. or R.C.E. No.: 4842
 Title County Surveyor
 County Surveyor's Comment _____

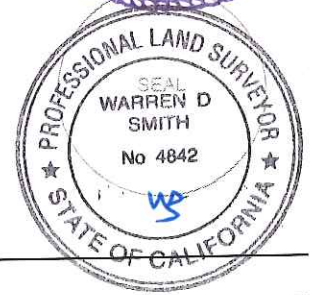

SCALE

1" = 30'

LOT 3
20 M.P. 25

LOT 4
20 M.P. 25

LOT 5
20 M.P. 25

JANET PLACE

N89°35'00"W 161.01'

N56°45'48"W
36.90' (TIE)

N00°25'00"E 59.49'

LEGEND:

⊙ -- SET 1" BRASS DISC "LS 6947" IN
SIDEWALK AT 5.00' PROJECTION OF LOT
LINE BASED ON FOUND CENTERLINE
MONUMENTS AND RECORD DATA.

⊙ -- FOUND 3/4" IRON PIPE IN MONUMENT
WELL PER 20 M.P. 25

M.P. -- MAPS & PLATS

CenterPoint Engineering, Inc.

Civil Engineering & Land Surveying

1217 Pleasant Grove Blvd. Suite 130 • Roseville, CA • 95678
Phone: 916-773-4006 Fax: 916-773-4498

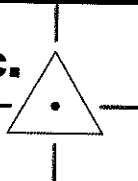

DRAWN BY: BB

CHECKED BY: MH

SHEET: 2 OF 2

SCALE: 1" = 30'

DATE: 12-02-2016