

CORNER RECORD

Document Number 06-10

City of -

County of SAN JOAQUIN, California

Brief Legal Description EAST 1/4 CORNER OF SECTION 3 OF T3N, RTE OF MDB & M

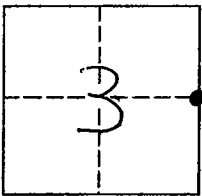

CORNER TYPE

Government Corner Control
 Meander Property
 Rancho Other

Date of Survey Oct. 25, 2005

COORDINATES(Optional)

N. _____
 E. _____
 Zone _____ NAD27 NAD83
 NAD83 Epoch _____
 Elevation _____
 Vert. Datum: NGVD29 NAV88
 Meas. Units: Metric Imperial

Corner - Left as found Found and tagged Established Reestablished Rebuilt

Identification and type of corner found: Evidence used to identify or procedure used to establish or reestablish the corner:

FOUND 3/4" DIA. IRON ROD WITH NO TAG DOWN 0.1' BELOW
AC SURFACE.

A description of the physical condition of the monument as found and as set or reset: _____

MONUMENT WAS FOUND IN GOOD CONDITION

SURVEYOR'S STATEMENT

This Corner Record was prepared by me or under my direction in conformance with the Land Surveyor's Act on MAY 25, 2006.

Signed [Signature] P.L.S. or R.C.E. Number 8022
 For the State of California
 Department of Transportation

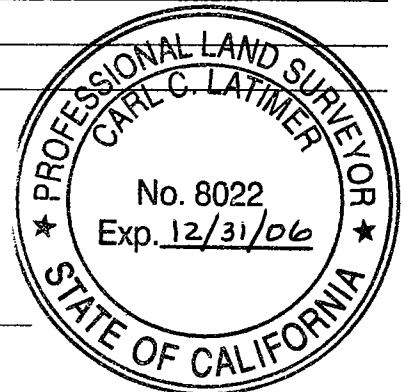

COUNTY SURVEYOR'S STATEMENT

This Corner Record was received MAY 30, 2006 and examined and filed JUNE 9, 2006.

Signed [Signature] P.L.S. or R.C.E. Number 4440

Title ASSISTANT COUNTY SURVEYOR

County Surveyor's Comment _____

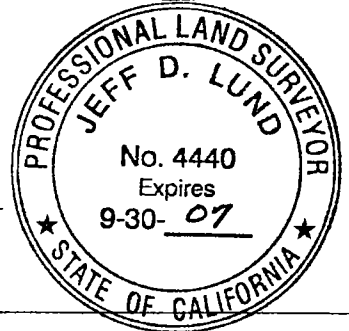

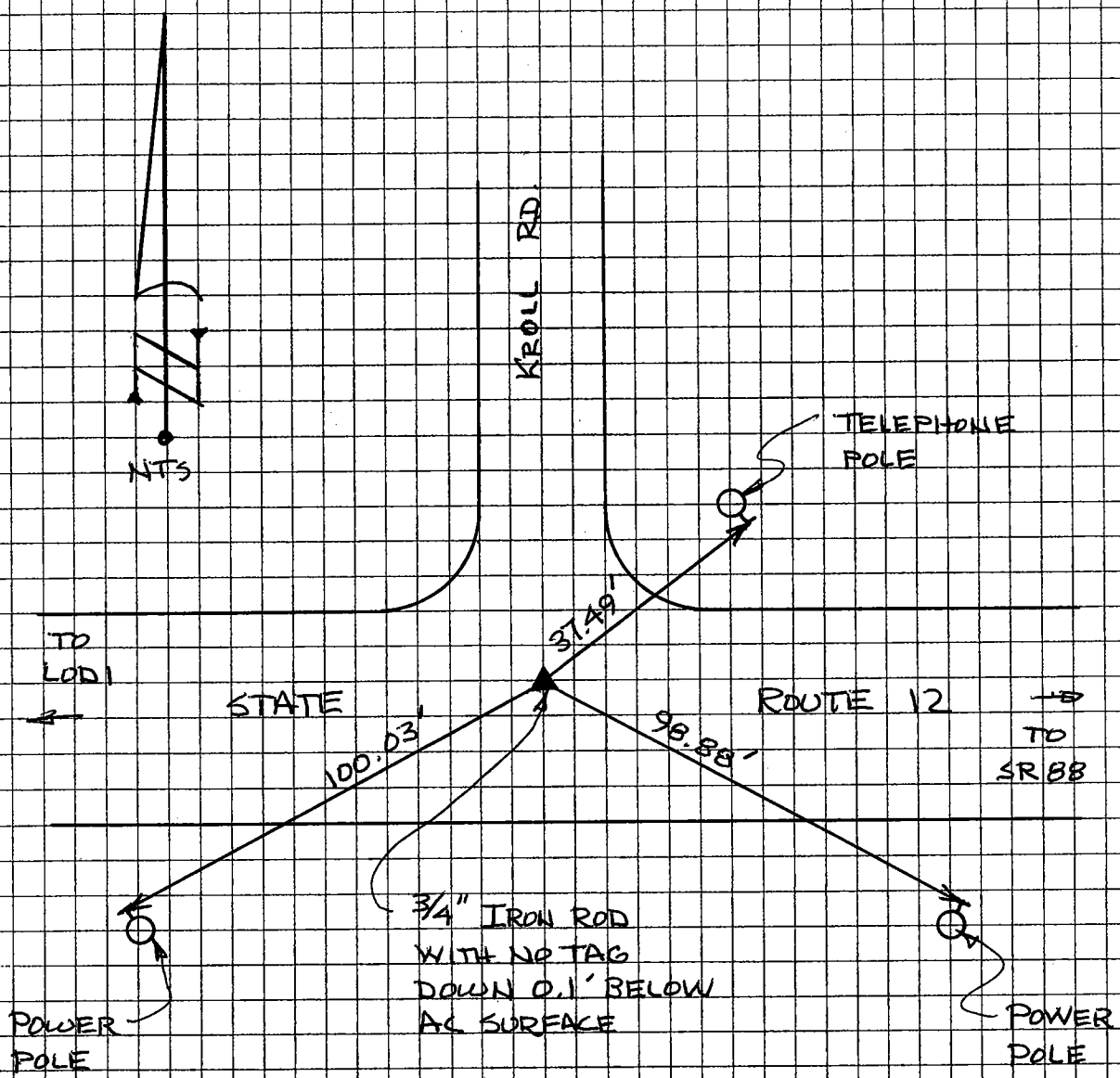

NOTE : ALL REFERENCE POINTS
ARE PK NAILS W/ BRASS
WASHERS STAMPED "CALTRANS"

THE TIES SHOWN HEREIN ARE FOR THE PURPOSE OF
PERPETUATING THE MONUMENTATION CURRENTLY EXISTING.
NO ATTEMPT WAS MADE TO DETERMINE THE VALIDITY
OF THE MONUMENT OR ITS PROPER LOCATION IN
RELATION TO LEGAL BOUNDARY LINES IN THE AREA.