

# CORNER RECORD

Document Number 03-21

City of \_\_\_\_\_

County of San Joaquin, California

Brief Legal Description EIGHT MILE ROAD 3,610' ± E/O RIO BLANCO ROAD

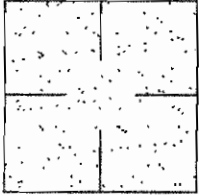

### CORNER TYPE

Government Corner  Control   
 Meander  Property   
 Rancho  Other

Date of Survey March 17, 2003

### COORDINATES (Optional)

N. \_\_\_\_\_  
 E. \_\_\_\_\_  
 Zone \_\_\_\_\_ NAD27  NAD83   
 NAD83 Epoch \_\_\_\_\_  
 Elev. \_\_\_\_\_  
 Vert. Datum: NGVD29  NAVD88   
 Meas. Units: Metric  Imperial

Corner - Left as found  Found and tagged  Established  Reestablished  Rebuilt

Identification and type of corner found: Evidence used to identify or procedure used to establish or reestablish the corner:  
SEE SKETCH ON BACKSIDE.

A description of the physical condition of the monument as found and as set or reset:  
FOUND MONUMENT IN GOOD CONDITION. SEE SKETCH ON BACKSIDE.

### SURVEYOR'S STATEMENT

This Corner Record was prepared by me or under my direction in conformance with the Land Surveyors' Act on April 17, 2003.

Signed Manuel Solorio R.C.E. Number C30890



### COUNTY SURVEYOR'S STATEMENT

This Corner Record was received APRIL 18, 2003 and examined and filed APRIL 21, 2003.

Signed Jeff Lund P.L.S. No. 4440

Title Assistant County Surveyor



County Surveyor's Comment \_\_\_\_\_

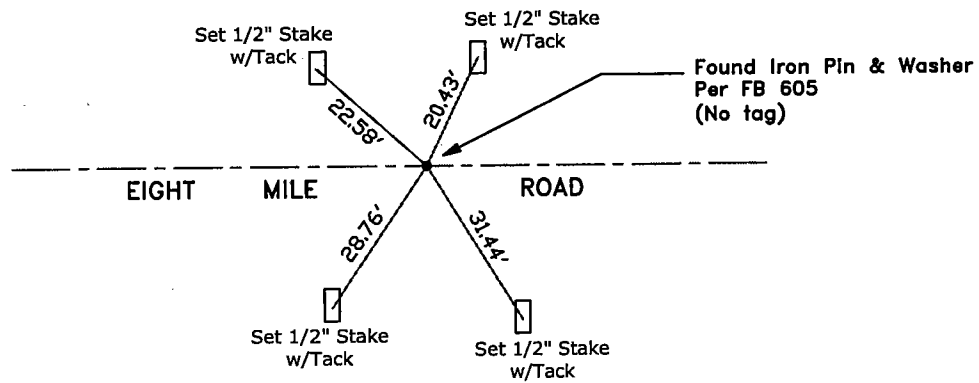
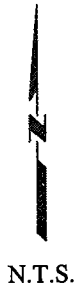

"No Attempt Was Made to Verify the Monument(s)"

FP=Fence Post  
 GP=Guy Post  
 JP=Joint Pole  
 PP=Power Pole  
 SP=Service Pole  
 TP=Telephone Pole  
 N.T.S.=Not To Scale  
 Set=Conc. Nails with Brass Washers Stamped  
 "S.J. Co.", unless otherwise noted