

CORNER RECORD

Docu: mber 03-20  
County of San Joaquin, California

City of \_\_\_\_\_

Brief Legal Description EIGHT MILE ROAD 3,105' ± E/O RIO BLANCO ROAD

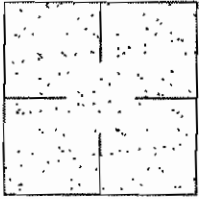

CORNER TYPE

Government Corner  Control   
Meander  Property   
Rancho  Other   
Date of Survey March 17, 2003

COORDINATES (Optional)

N. \_\_\_\_\_  
E. \_\_\_\_\_  
Zone \_\_\_\_\_ NAD27  NAD83   
NAD83 Epoch \_\_\_\_\_  
Elev. \_\_\_\_\_  
Vert. Datum: NGVD29  NAVD88   
Meas. Units: Metric  Imperial

Corner - Left as found  Found and tagged  Established  Reestablished  Rebuilt

Identification and type of corner found: Evidence used to identify or procedure used to establish or reestablish the corner:  
SEE SKETCH ON BACKSIDE.

A description of the physical condition of the monument as found and as set or reset:  
FOUND MONUMENT IN GOOD CONDITION. SEE SKETCH ON BACKSIDE.

SURVEYOR'S STATEMENT

This Corner Record was prepared by me or under my direction in conformance with the Land Surveyors' Act on April 17, 2003.

Signed Manuel Solorio R.C.E. Number C30890



COUNTY SURVEYOR'S STATEMENT

This Corner Record was received APRIL 18, 2003 and examined and filed APRIL 21, 2003.

Signed Jeff Lund P.L.S. No. 4440  
Title Assistant County Surveyor



County Surveyor's Comment \_\_\_\_\_

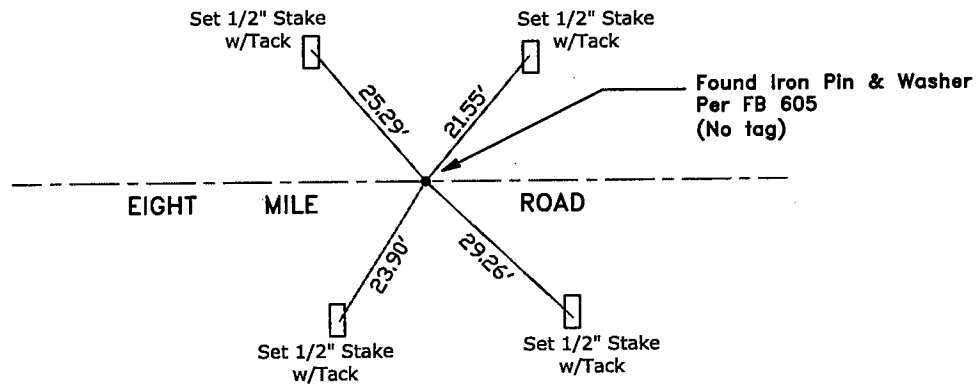

"No Attempt Was Made to Verify the Monument(s)"

- FP=Fence Post
- GP=Guy Post
- JP=Joint Pole
- PP=Power Pole
- SP=Service Pole
- TP=Telephone Pole
- N.T.S.=Not To Scale
- Set=Conc. Nails with Brass Washers Stamped  
"S.J. Co.", unless otherwise noted