

CORNER RECORD

Document Number 02-34

City of _____

County of San Joaquin, California

Brief Legal Description North 1/4 Corner, Section 2, Township 2 South, Range 7 East, M.D.B.&M.
PER R.S. 11-58

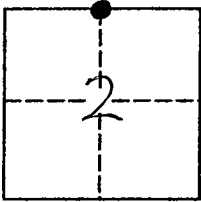

CORNER TYPE

COORDINATES(Optional)

Government Corner Control
Meander Property
Rancho Other

N. _____
E. _____
Zone _____ NAD27 NAD83
NAD83 Epoch _____
Elevation _____
Vert. Datum: NGVD29 NAV88
Meas. Units: Metric Imperial

Date of Survey 9/6/00

Corner - Left as found Found and tagged Established Reestablished Rebuilt

Identification and type of corner found: Evidence used to identify or procedure used to establish or reestablish the corner:
Found Bolt near the centerline of State Highway 120 at Hart's Lane per CR-98-06, no washer and no tag,
down 0.260 meters in survey monument well.

A description of the physical condition of the monument as found and as set or reset: _____
The monument is in good condition. The reference points found per CR-98-06 were set in case the
monument was accidentally disturbed during construction.

SURVEYOR'S STATEMENT

This Corner Record was prepared by me or under my direction in conformance with
the Land Surveyors' Act on December 21, 2001
Signed Ginger J. Rubino P.L.S. or R.C.E. Number 6396
For the State of California
Department of Transportation



COUNTY SURVEYOR'S STATEMENT

This Corner Record was received June 11, 2002 and examined
and filed JUNE 20, 2002
Signed Jeff D. Lund P.L.S. or R.C.E. Number 4440
Title Assistant County Surveyor
County Surveyor's Comment _____



LEGEND

- FOUND BOLT AND WASHER, NO TAG
- FOUND 2" X 2" HUB & TACK W/ CAUTRANS TAG
- SET 2" X 2" HUB & TACK W/ CAUTRANS TAG
- FOUND SPIKE W/ CAUTRANS TAG

NOTE: DISTANCES ARE GROUND METERS

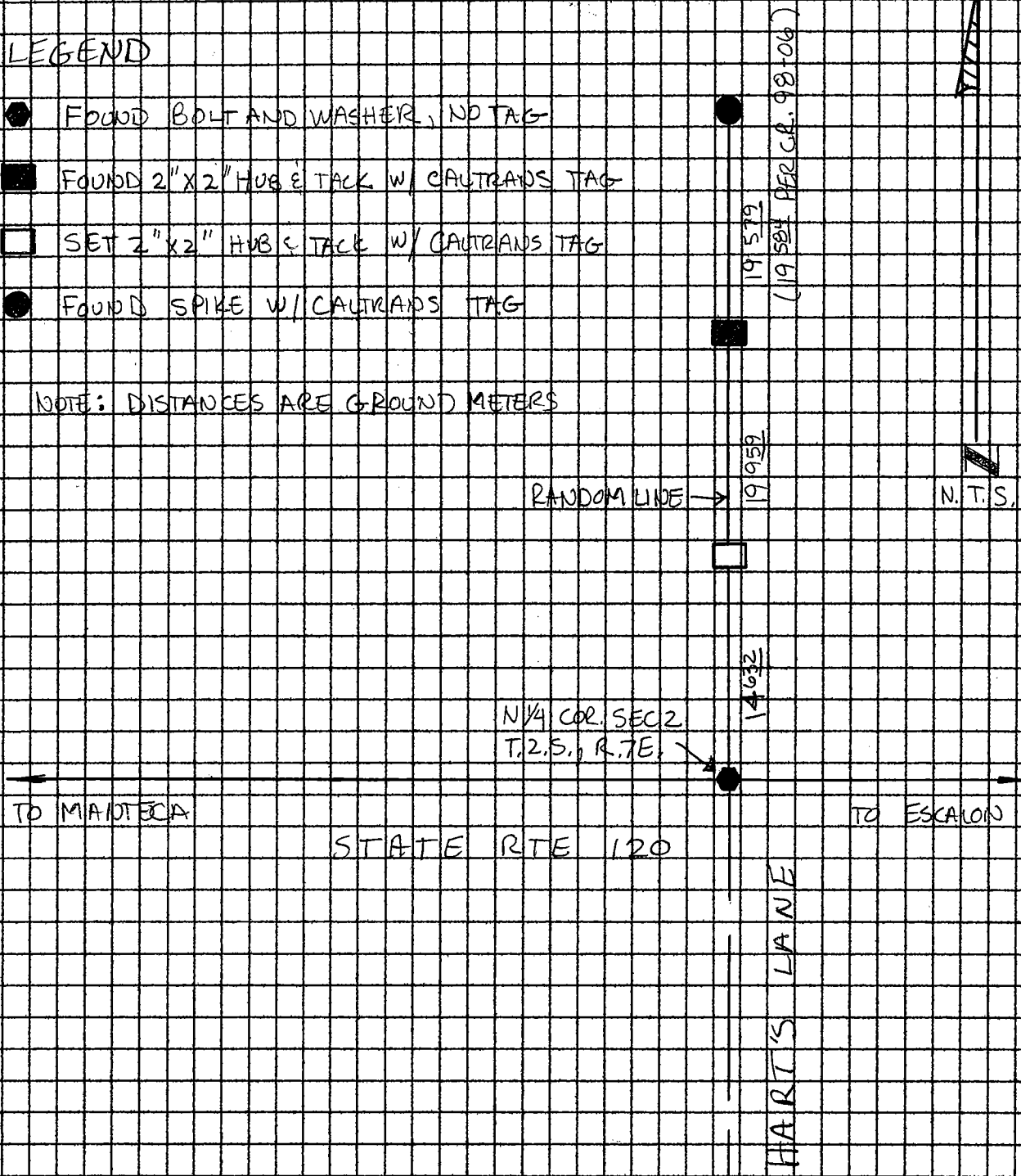

The ties shown hereon are for the purpose of perpetuating the monumentation currently existing. No attempt was made to determine the validity of the monuments or their proper location in relation to legal boundary lines in the area.