

CORNER RECORD

Document Number 01-50
County of San Joaquin, California

City of _____

Brief Legal Description ON ELLIOTT ROAD 2928'± AND 2833'± NORTHWEST OF LAIRD ROAD

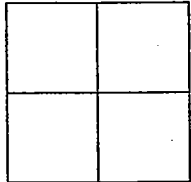

CORNER TYPE

- Government Corner Control
Meander Property
Rancho Other

Date of Survey NOVEMBER 2000

COORDINATES (Optional)

N. _____
E. _____
Zone _____ NAD27 NAD83
NAD83 Epoch _____
Elev. _____
Vert. Datum: NGVD29 NAVD88
Meas. Units: Metric Imperial

Corner - Left as found Found and tagged Established Reestablished Rebuilt

Identification and type of corner found: Evidence used to identify or procedure used to establish or reestablish the corner
SEE SKETCH ON BACKSIDE

A description of the physical condition of the monument as found and as set or reset:
FOUND MONUMENT(S) IN GOOD CONDITION. SEE SKETCH ON BACKSIDE

SURVEYOR'S STATEMENT

This Corner Record was prepared by me or under my direction in conformance with the Land Surveyors' Act on Feb 1, 2001.

Signed _____ L.S. or R.C.E. Number 23341



COUNTY SURVEYOR'S STATEMENT

This Corner Record was received Feb. 2, 2001 and examined and filed Feb. 5, 2001.

Signed Manuel Lopez R.C.E. No. 28054

Title _____ County Surveyor

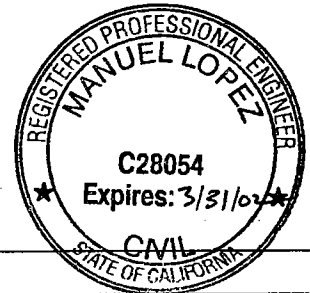

County Surveyors Comment _____

(D.D. Sheet No. 10)

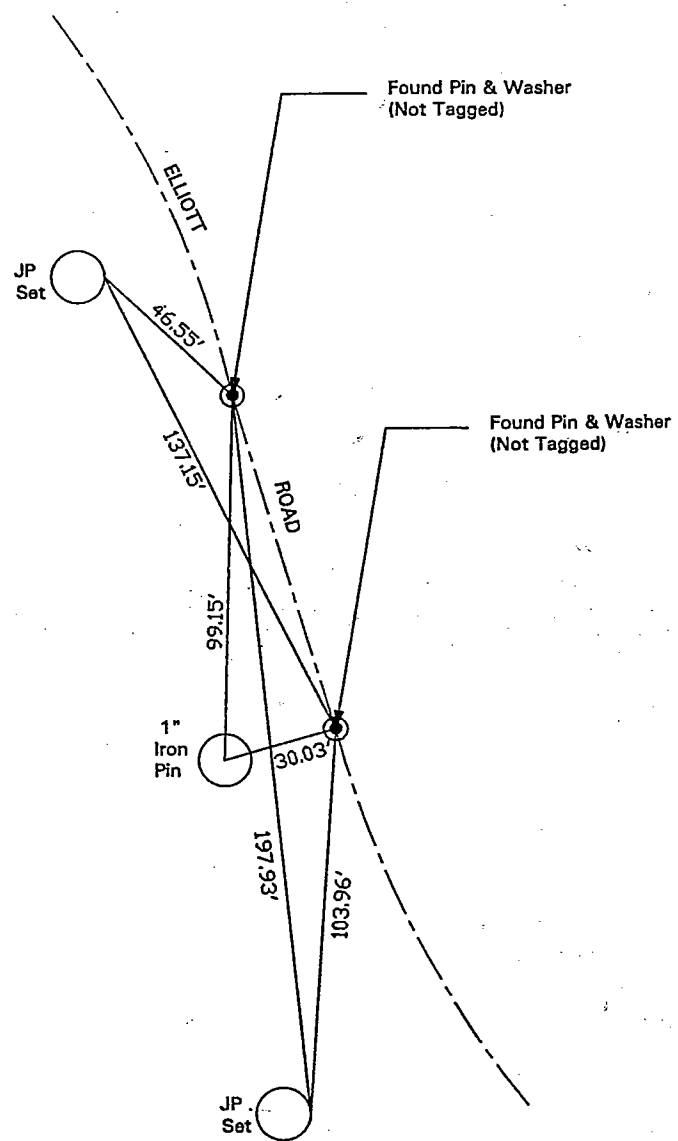

"No Attempt Was Made To Verify Monument(s)"

- FP=Fence Post
- GP=Guy Post
- JP=Joint Pole
- PP=Power Pole
- SP=Service Pole
- TP=Telephone Pole
- N.T.S.=Not To Scale
- Set=Conc. Nails with Brass Washers Stamped "S.J. Co.", unless otherwise noted