**SAN JOAQUIN
LOCAL AGENCY FORMATION COMMISSION**

LAFCo

509 W. WEBER AVENUE SUITE 420 □ STOCKTON, CA 95203

NOTICE OF PUBLIC HEARING

**HOLLY SUGAR SPORTS PARK REORGANIZATION TO
THE CITY OF TRACY (LAFCo 21-11)**

NOTICE IS HEREBY GIVEN that on Friday, February 17, 2012, at 10:00 A.M. in the Chambers of the Board of Supervisors on the 6th Floor, 44 North San Joaquin Street, Stockton, California, the San Joaquin Local Agency Formation Commission (LAFCo) will hold a public hearing to consider the Holly Sugar Sports Park Reorganization to the City of Tracy.

The City of Tracy has submitted an application to annex 325.31 acres to the City for development of the youth sports park facility. The reorganization includes concurrent detachment from the San Joaquin Resource Conservation District. The project site is within the Tracy Rural Fire District and Reclamation District 1007-Pico Nagle for which detachment is not proposed. The proposed annexation site is located north of the city of Tracy, between Tracy Boulevard and Corral Hollow Road, north of Larch Road, and south of Sugar Road.

All interested persons may appear at said hearing and present their views on any matter relating to the proposal at that time. If you have any questions or need more information, please call the LAFCo office at (209) 468-3198 or visit our website at www.sjgov.org/lafco.

BY ORDER OF THE SAN JOAQUIN
LOCAL AGENCY FORMATION COMMISSION
JAMES E. GLASER,

Executive Officer

Dated: January 26, 2012



NO SCALE

ANNEXATION
(SEE PAGE 2)

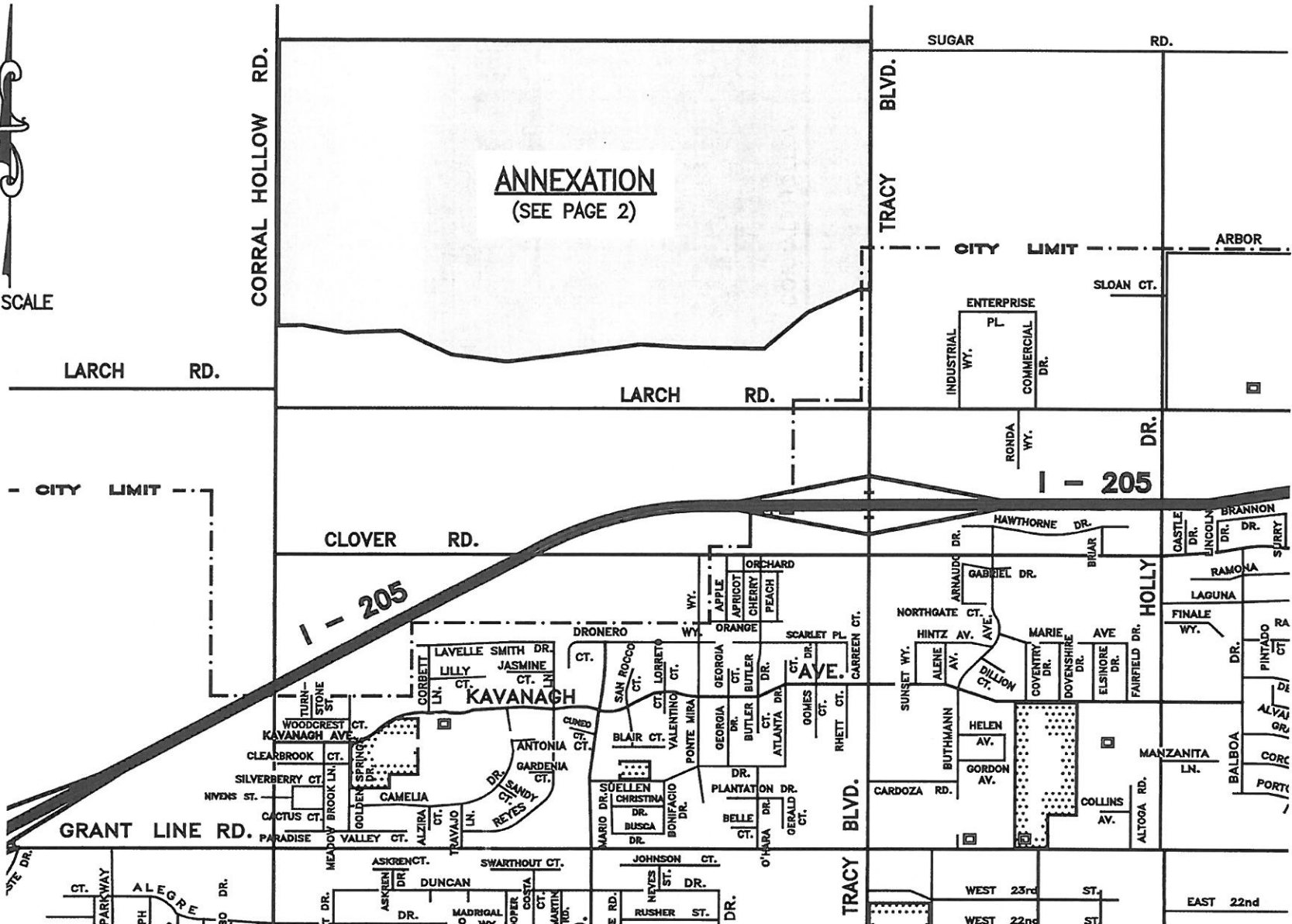

VICINITY MAP
HOLLY SUGAR SPORTS COMPLEX ANNEXATION

CITY OF TRACY
SAN JOAQUIN COUNTY, CALIFORNIA

DATE: 01/10/12
PAGE 1 OF 2